

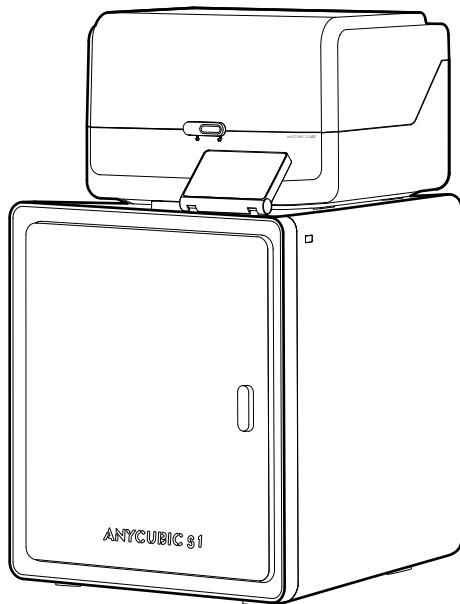

# Anycubic Kobra S1 Combo User Manual



Installation Video

The product picture is for reference only. Please refer to the actual product.



Dear Customer,

Thank you for choosing **ANYCUBIC** products.

Maybe you are familiar with 3D printing technology or have purchased **ANYCUBIC** printers before, but we still highly recommend that you read this manual carefully. The installation techniques and precautions in this manual can help you avoid any unnecessary damage or frustration.

Please visit <https://support.anycubic.com/> to contact us if you have any question. You can also gain more information such as software, videos, models from the website.



**ANYCUBIC** APP



**ANYCUBIC** Wiki



**ANYCUBIC** Support Center



Multi-country User Manual

Team **ANYCUBIC**

Copyrighted by "Shenzhen Anycubic Technology Co., Ltd ", all rights reserved.

# Content

---

<b>1</b>	<b>Product Overview</b>	1
<b>2</b>	<b>Machine Installation</b>	4
	Unlock ACE Pro	4
	Unlock Printhead	6
	Unock Hot Bed	6
	Install Spool Holder	7
	Install ACE Pro	8
	Install Activated Carbon	10
<b>3</b>	<b>Power-on Guide</b>	11

<b>4</b>	<b>Print Model</b>	13
<b>5</b>	<b>Printer Binding</b>	14
	APP	14
	Anycubic Slicer	15
<b>6</b>	<b>Other Function Descriptions</b>	18
<b>7</b>	<b>Attention</b>	20

# Product Overview

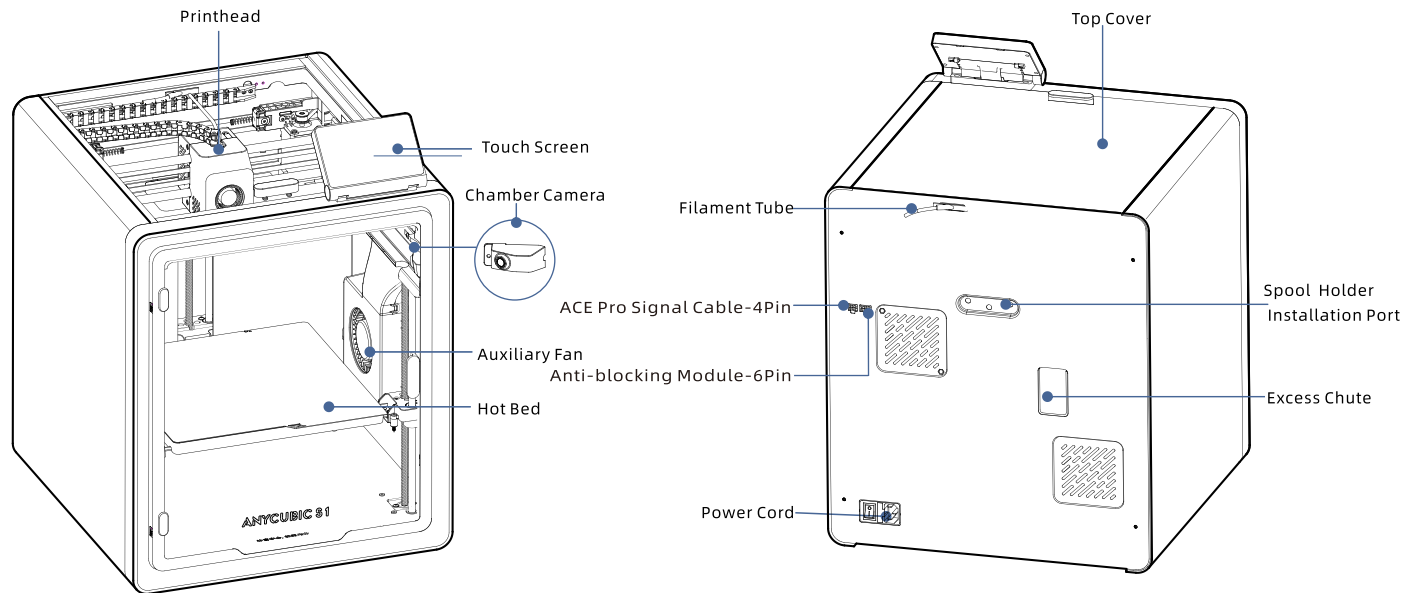

# Product Overview

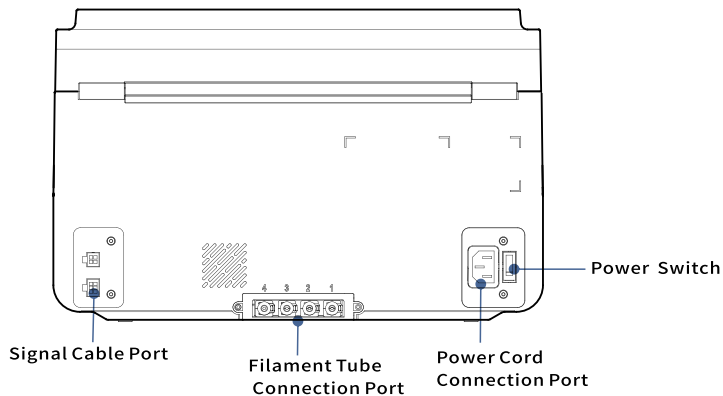
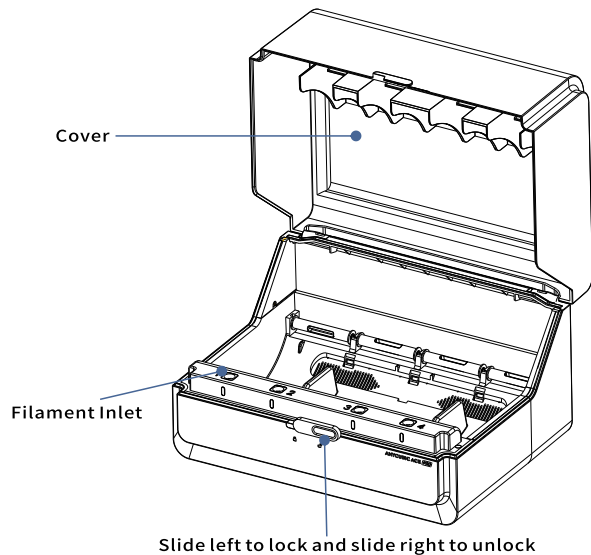

Avoid using ACE Pro to print flexible materials, including TPU, TPE, or absorbent PVA, avoid using materials that are too hard (too high modulus) or too brittle (not enough toughness), please use external spool holder to print these filament.

# Packing List

The following pictures are for reference only. Please refer to the actual object.



Kobra S1 Printer

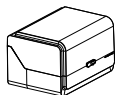

Anycubic Color Engine Pro  
(ACE Pro)



Spool Holder



Signal Cable  
(1pcs)



Filament Tube  
(4pcs)



Power Cord  
(2pcs)



Anti-blocking Module



Screws  
M2.5\*25 (2pcs)



Screws  
M3\*6 (2pcs)



U-Disk  
(1Pcs)



2.5/2.0/1.5



Filament Sample



Nozzle Cleaner



Grease



Activated Carbon  
(1Pcs)



Nozzle Cleaning  
Module(1Pcs)



Nozzle Silicone Part  
(1Pcs)



Cable Organizer  
(2Pcs)

## Technical Specification

### Printing

Technology: FDM (Fused Deposition Modeling)

Build Size: 250 mm (L) × 250 mm (W) × 250mm (H)

Layer Thickness: 0.08 - 0.28mm

Positioning Accuracy: X / Y / Z 0.0125 / 0.0125 / 0.0008 mm

Extruder Quantity: Single

Nozzle Diameter: 0.4 mm

Supported Materials: PLA/TPU/PETG/ABS/ASA

### Software

Slicing Software: Anycubic Slicer Next/Orca Slicer

Software Input Formats: .STL/.OBJ/.3mf

Software Output Formats: GCode

Connectivity: U-DISK, AC Cloud, Anycubic Slicer Next

### Electrical

Power Input: 100-120V~ /200-240V~

Rated Power: 325W/1300W

### WiFi

Frequency Band: 2.4G (2.400-2.4835GHz)

Working Mode: STA

### Physical Dimensions

Printer Dimensions: 400mm (L) × 410mm (W) × 490 mm (H)

Net Weight: ~18kg

ACE Pro Dimensions: 365.9mm (L) × 282.8mm (W) × 234.5 mm (H)

ACE Pro Net Weight: ~4.6kg

Dimensions of Printer and ACE Pro Footprint:

420mm (L) × 530mm (W) × 710 mm (H)

# Machine Installation

## Unlock ACE Pro

For the installation instruction video, please scan the QR code on the right.

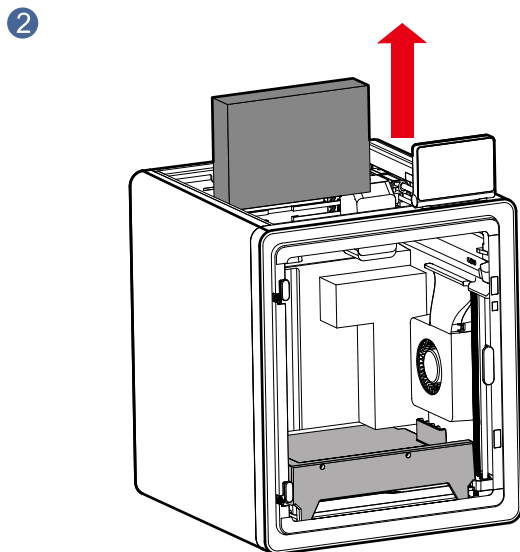
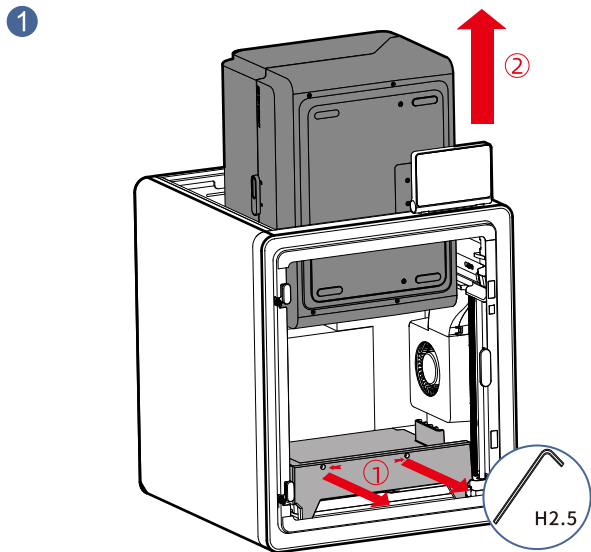

1. Open the printer cover, and use Allen Key H2.5 to remove the two screws marked in red as pictured.

Take out the accessory box by sliding it out through the top.

4 2. After completing the above operations, take out the ACE Pro through the top.

\*It is enough to loosen the screws to a certain extent, there is no need to completely remove the screws.



## Unlock ACE Pro

3

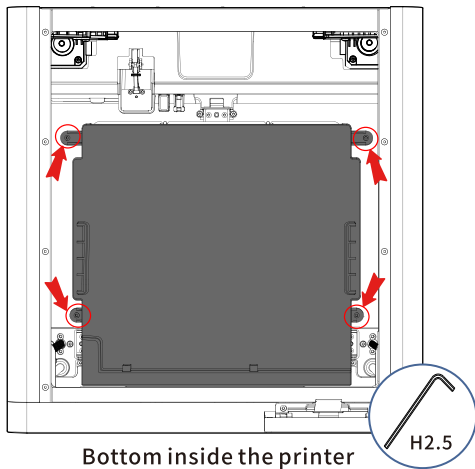

As shown by the arrows, use Allen Key H2.5 to remove the four screws marked in red circles.

\*It is enough to loosen the screws to a certain extent, there is no need to completely remove the screws.

4

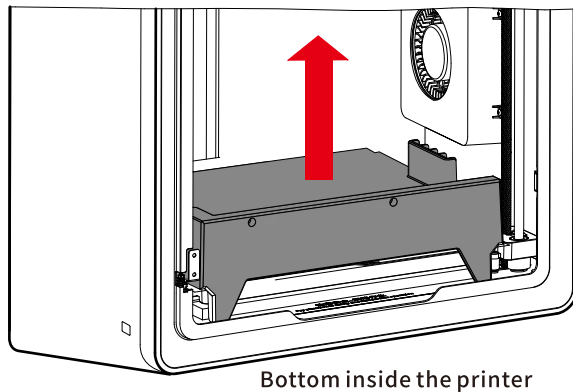

Take out the ACE Pro cushioning.

## Unlock Printhead

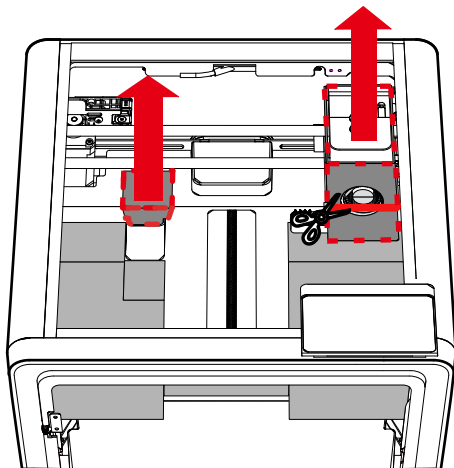

Top of the printer

1. Cut the zip tie securing the printhead, remove the cardboard from the printhead.
2. Remove the foam.

## Unlock Hot Bed

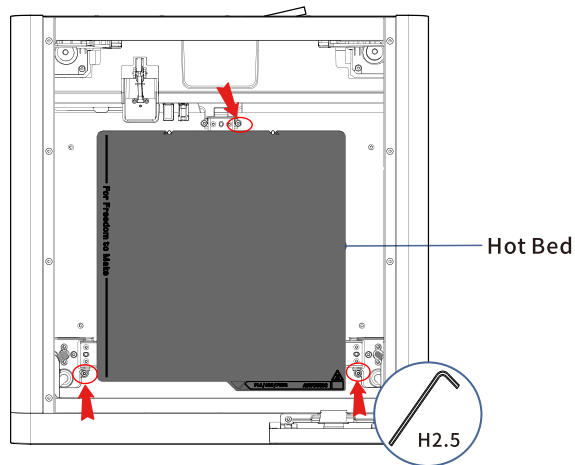

Bottom inside the printer

As shown by the arrows, use Allen Key H2.5 to remove the three screws marked in red circles.

## Install Spool Holder (skip this step if printing in multiple colors)

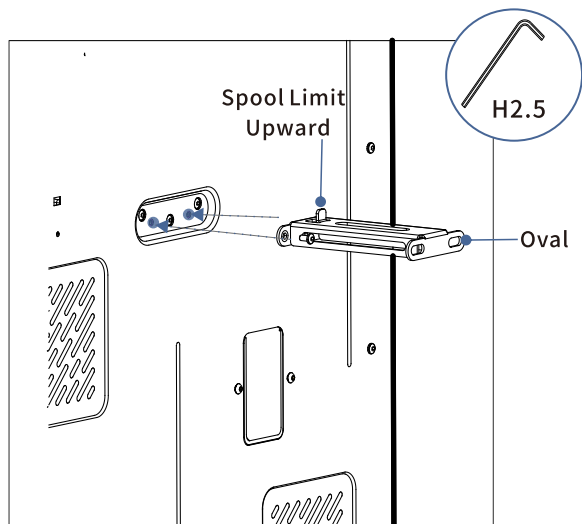
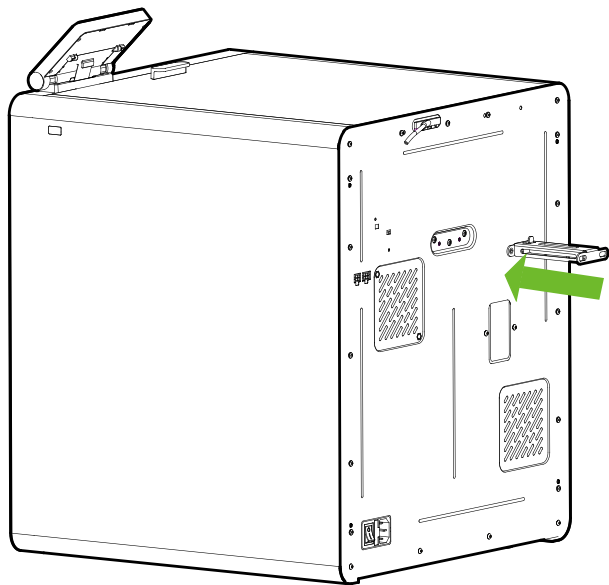

Secure the spool holder with M3\*6 screws from the accessory box.

## Install ACE Pro

1. Place ACE Pro on top of Kobra S1.

2. Insert the 4-pin end of the signal cable into the printer, and insert the 6-pin end into the hole in the left corner of ACE Pro.

3. Use M2.5\*25 screws to fix the filament hub module on the back of the printer and insert the cable into the port (use Allen Key H2.0).

4. Insert the suspended filament tube into the port.

