

## TOOL CARTRIDGE

WWW.VORONDESIGN.COM

### AVAILABLE MOUNTS

We also provide mounts for the Slice Engineering Mosquito and TriangleLab/Phaetus Dragon Hotend.

They are assembled in a similar manner.

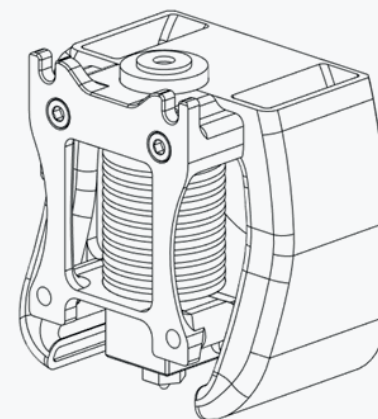
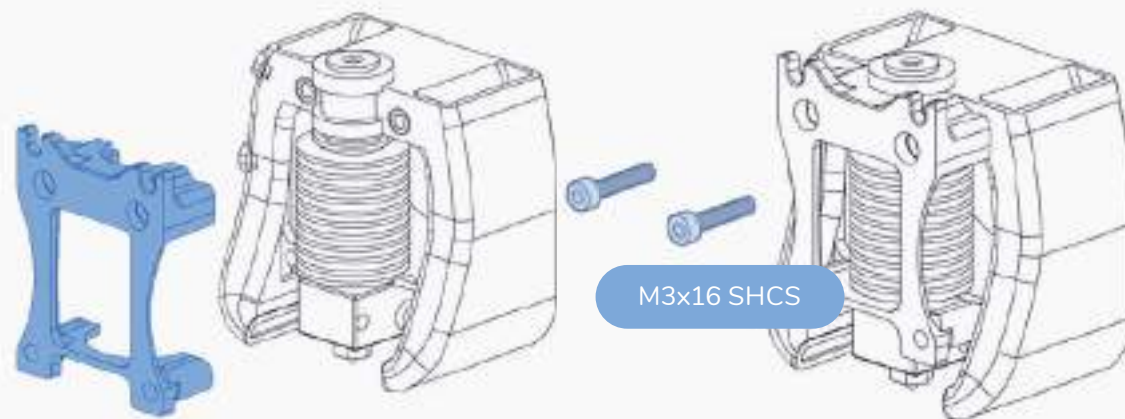
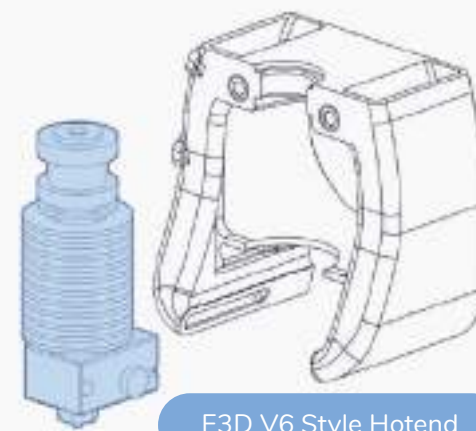
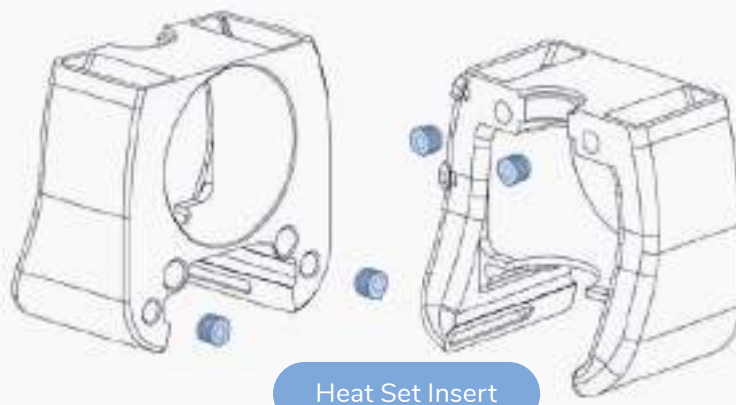

## TOOL CARTRIDGE

WWW.VORONDESIGN.COM

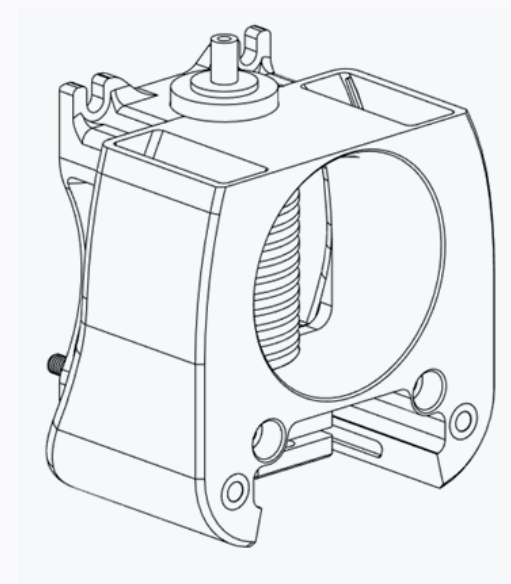
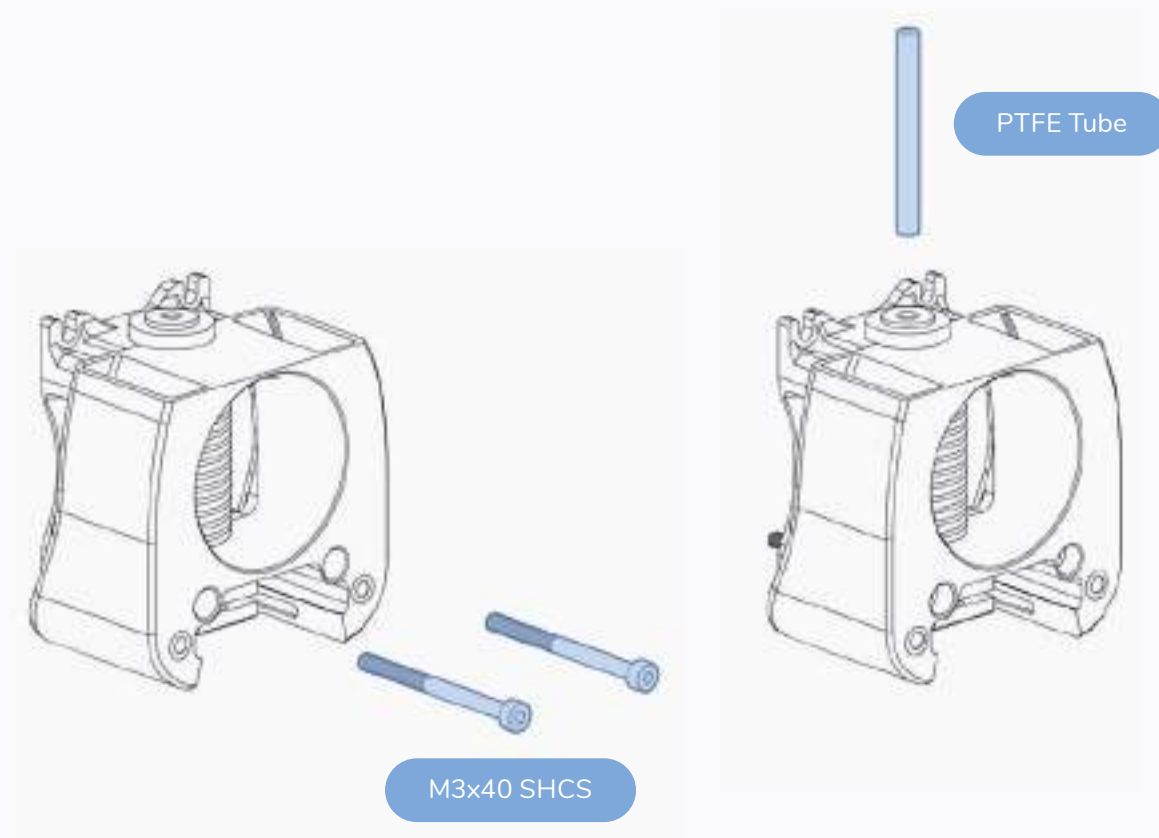

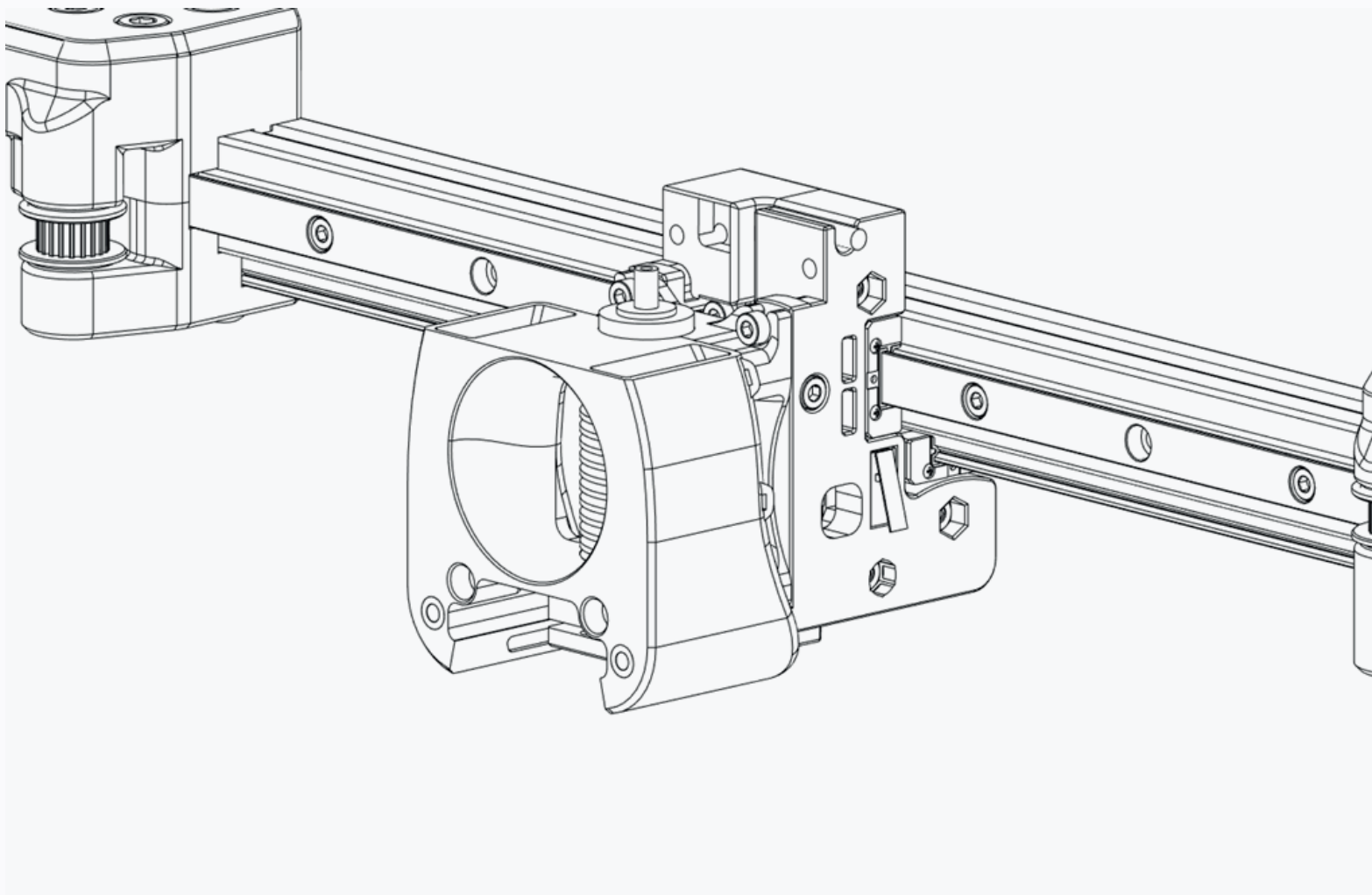

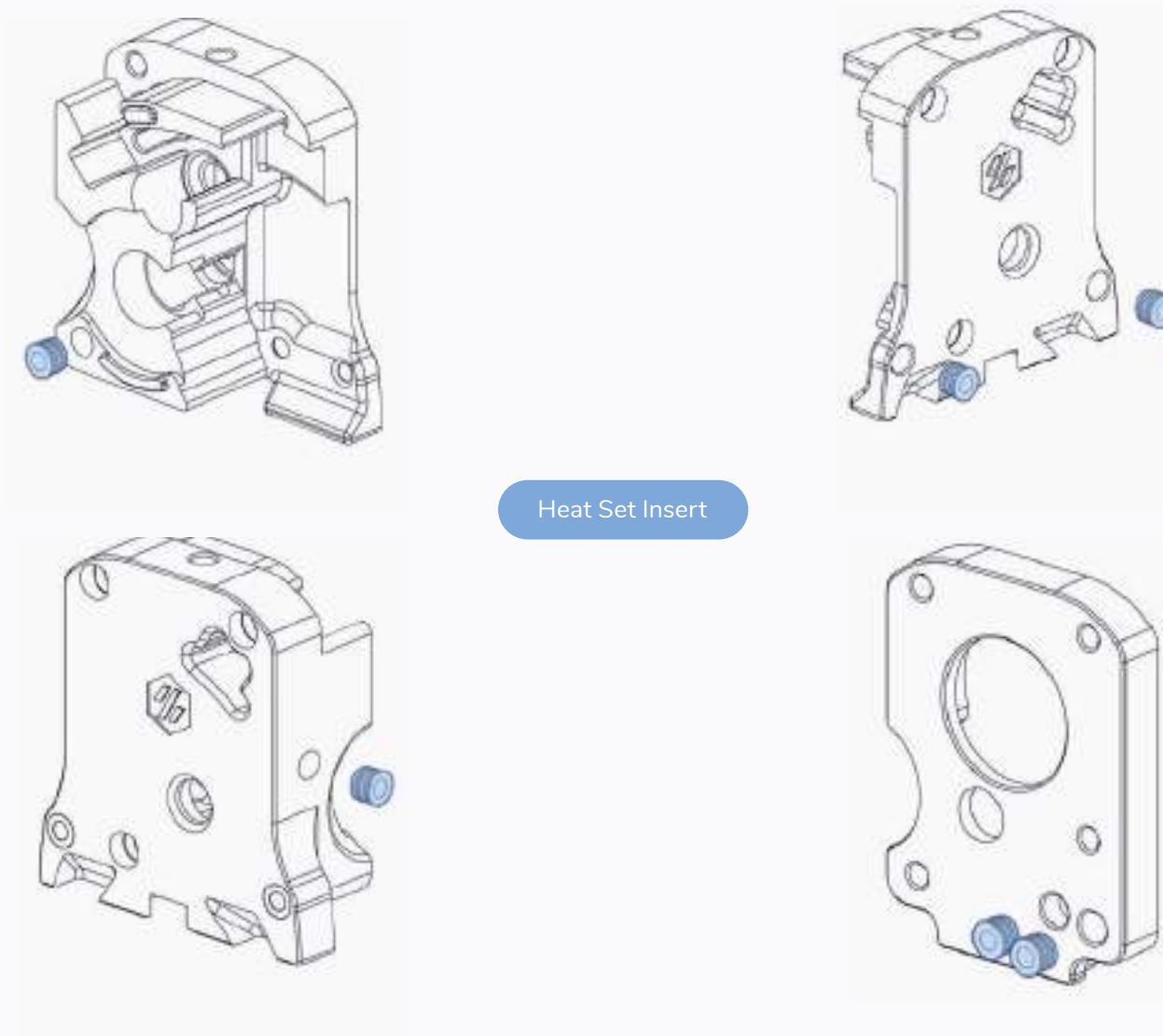

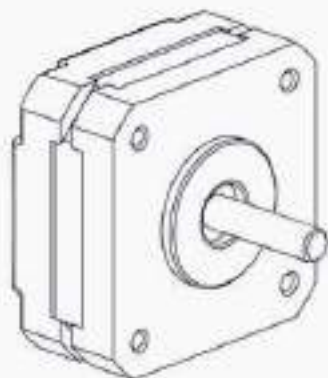

Stepper Motor



BMG Drive Pinion

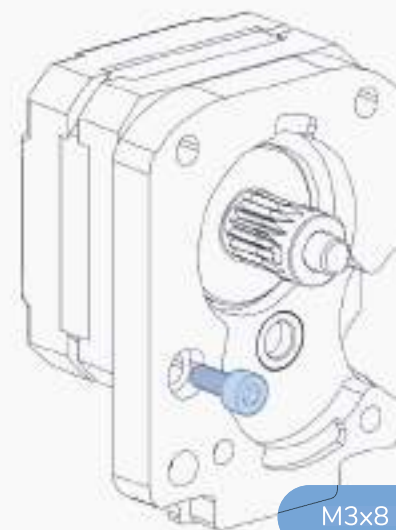
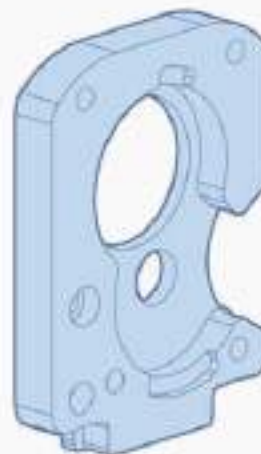
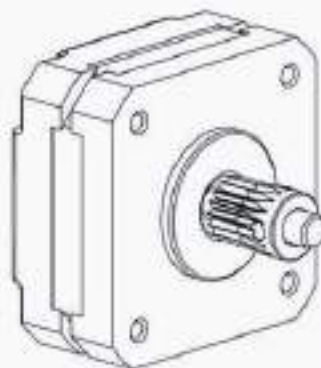

M3x8 SHCS

**STEPPER WIRES**

If the steppers has wires cut them to approximately 150mm.  
Wires/connector to the right hand side.

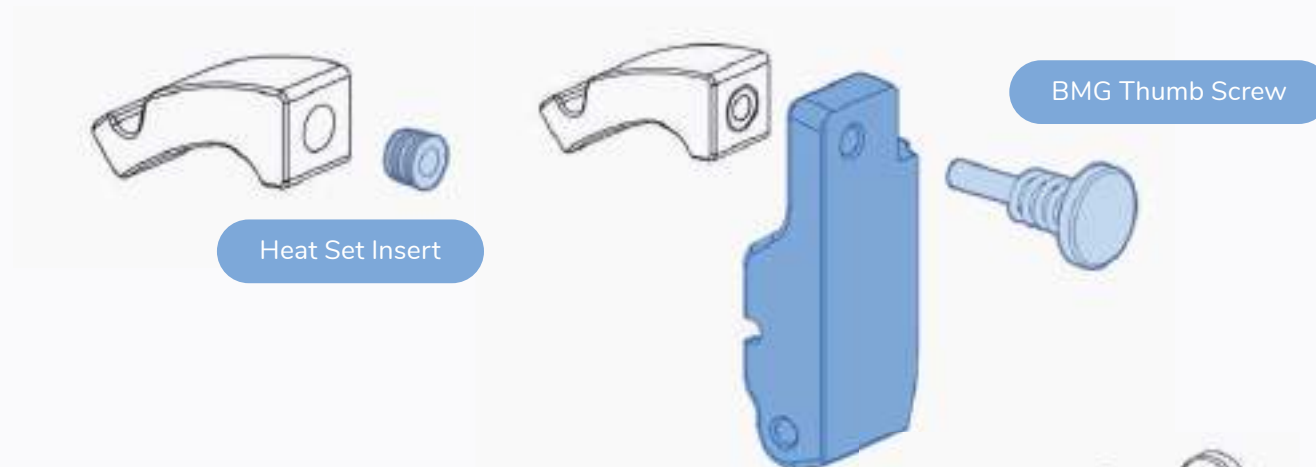
**LUBRICATE BEARINGS**

A light lubrication film will help with smooth operation and longevity.

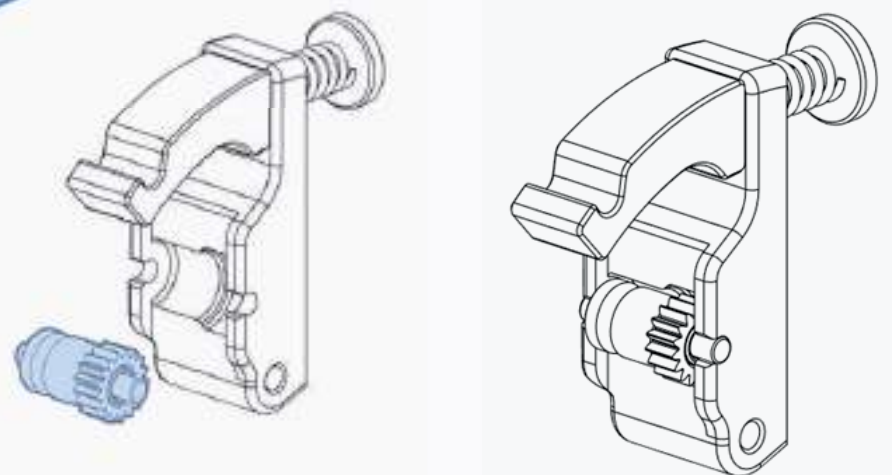



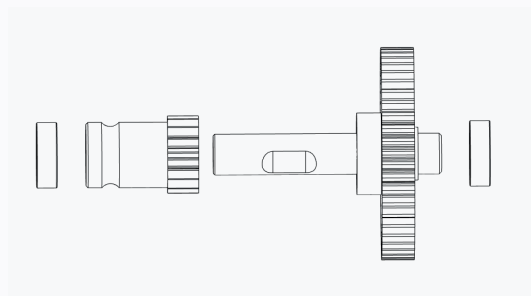

BMG Drive Assembly

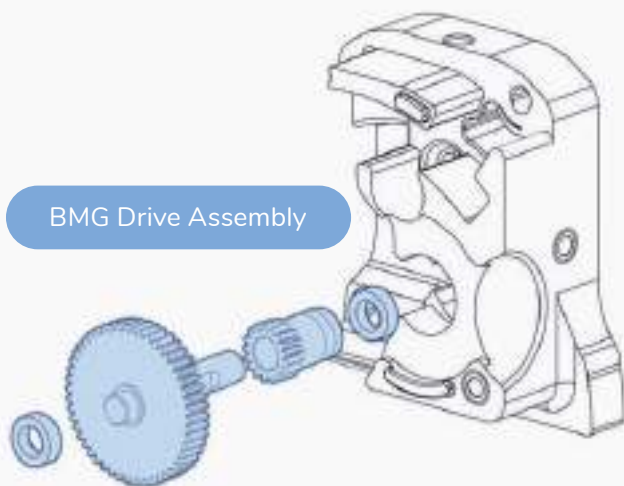
**CHECK BEARING FIT**

The bearings must slip on and off the shaft easily. Pressing the bearings on the shaft will damage them. Lightly sand the shaft if required.

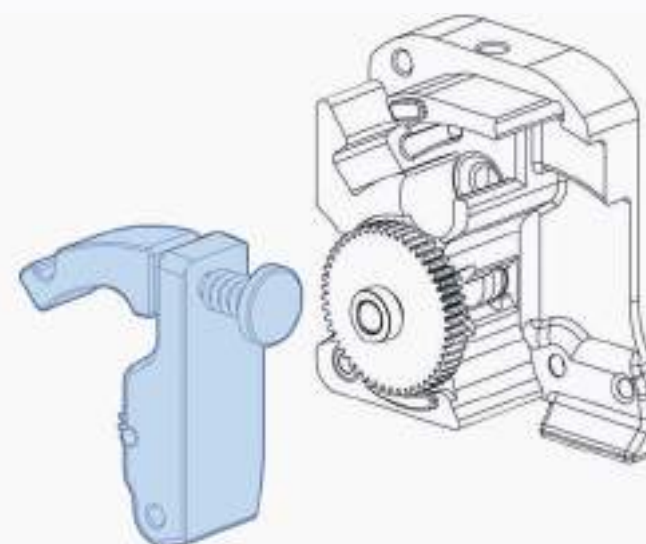
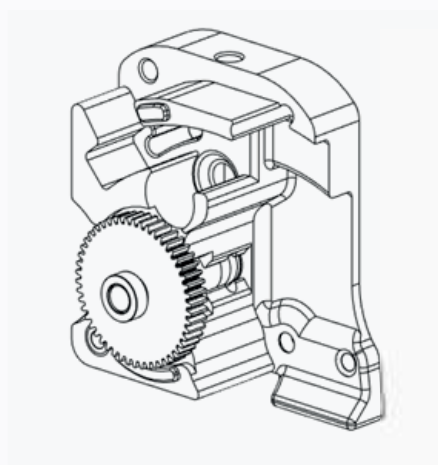

## CLOCKWORK

WWW.VORONDESIGN.COM

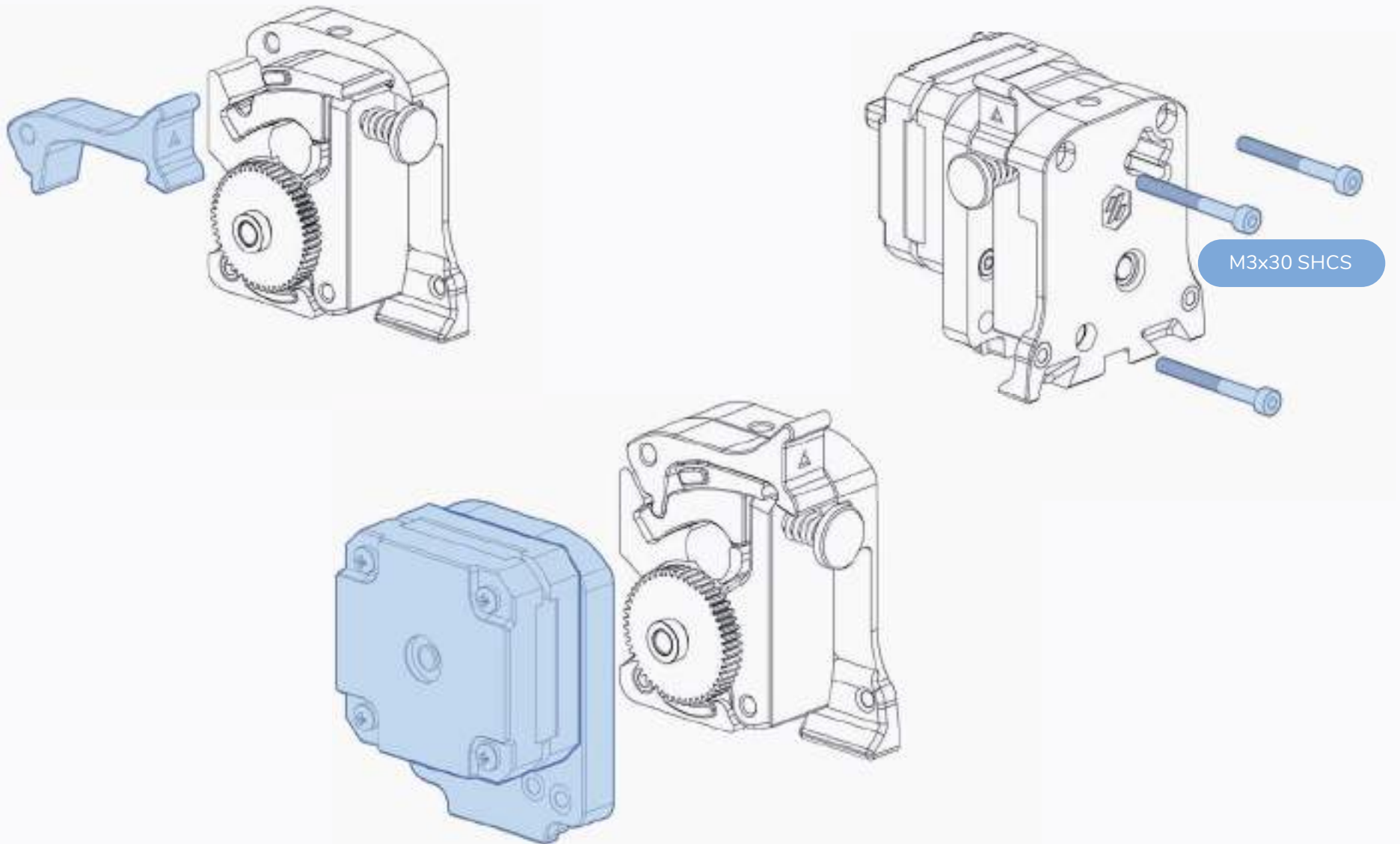



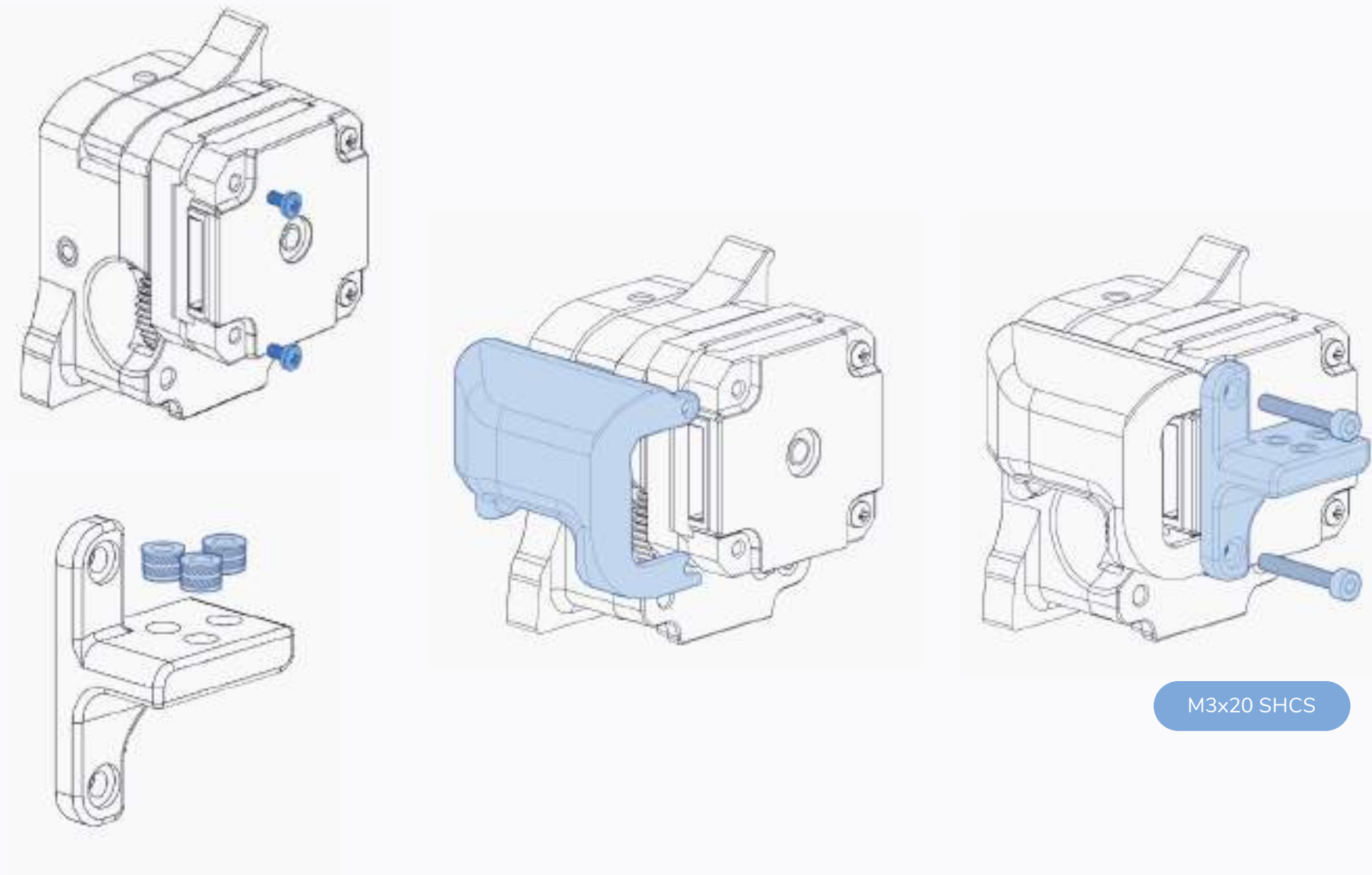

M3x20 SHCS

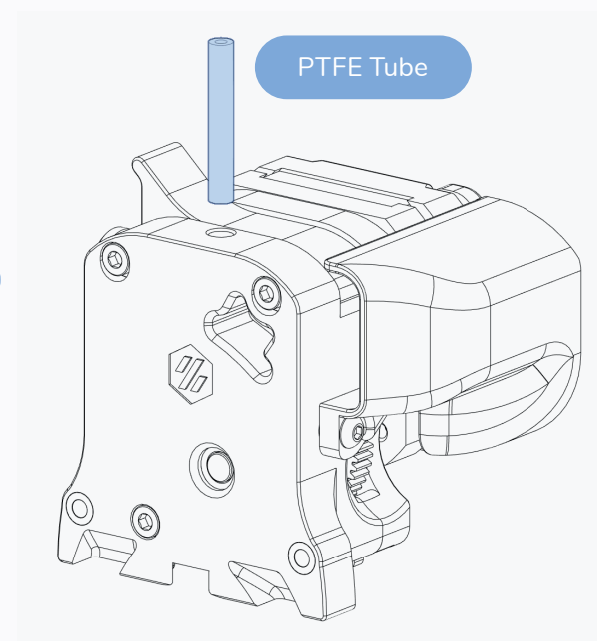
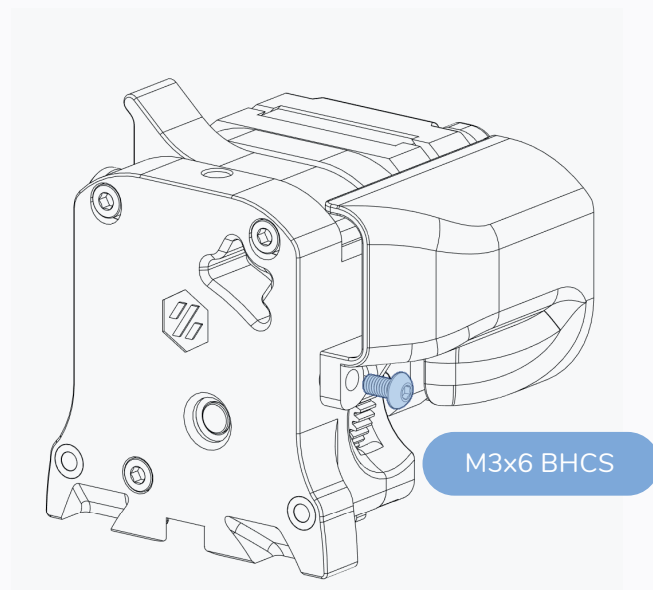
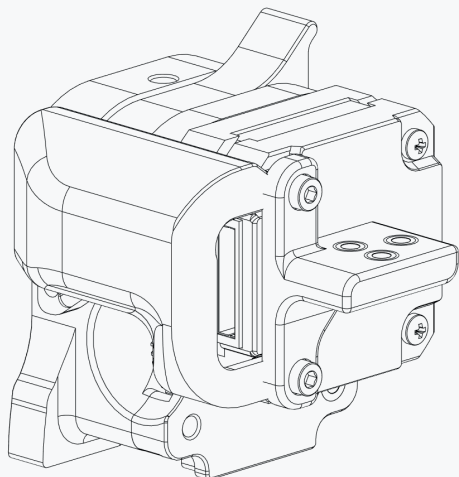

## CLOCKWORK

[WWW.VORONDESIGN.COM](http://WWW.VORONDESIGN.COM)

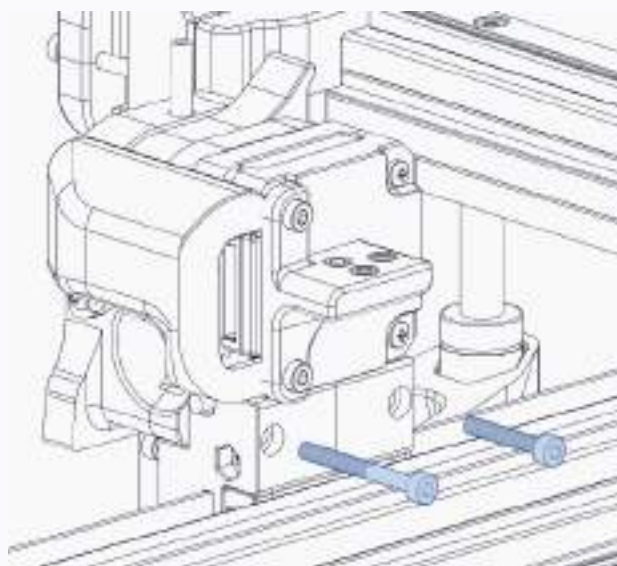
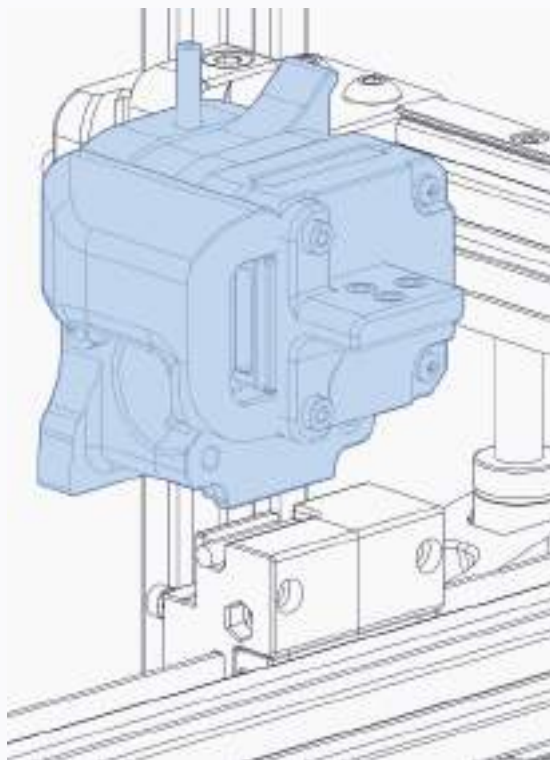

M3x30 SHCS

M3x20 SHCS

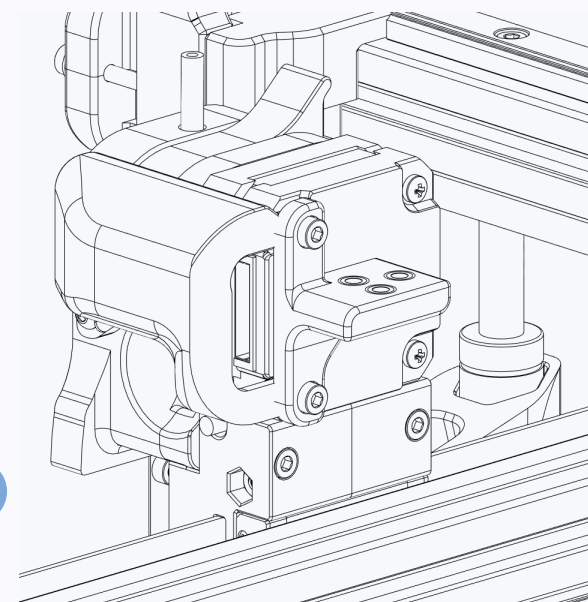

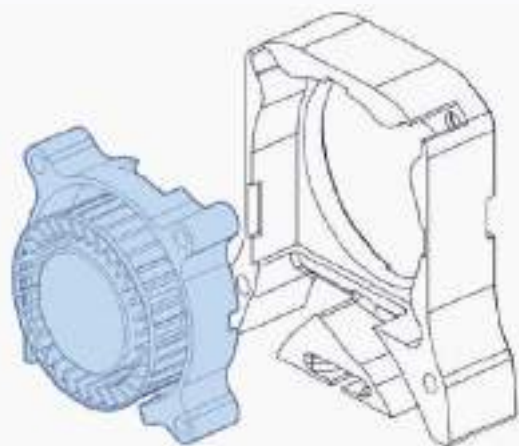

## REMOVE TOP COVER

Split the fan open by bending the tabs on the side.

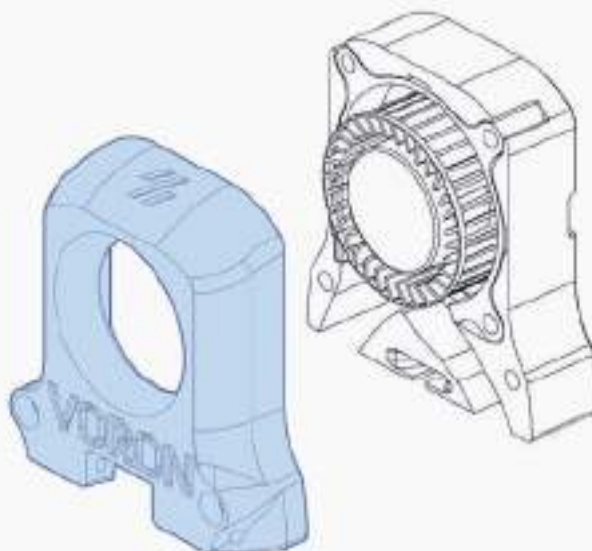

## DON'T OVER TIGHTEN

The screws are screwd directly into plastic.

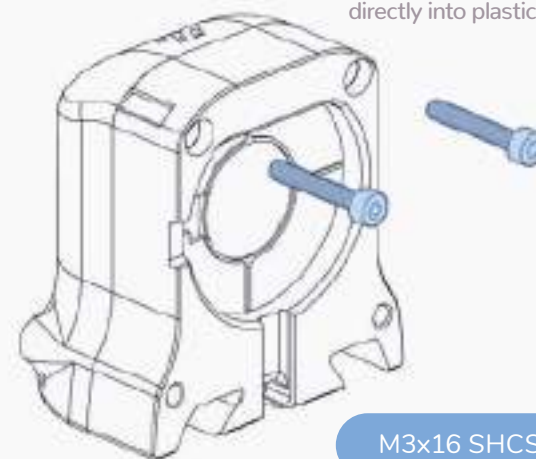

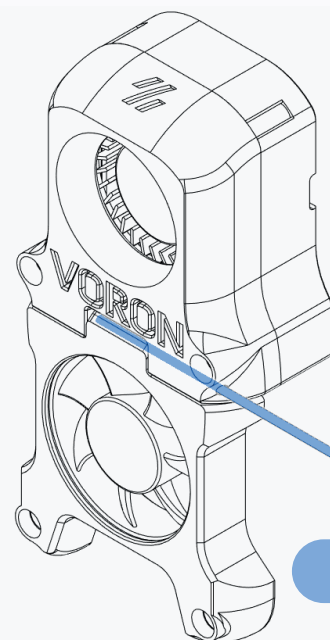
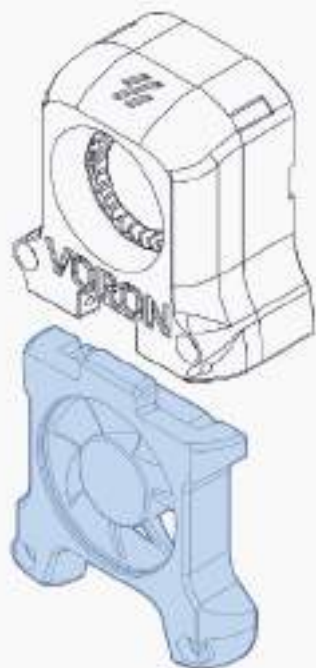
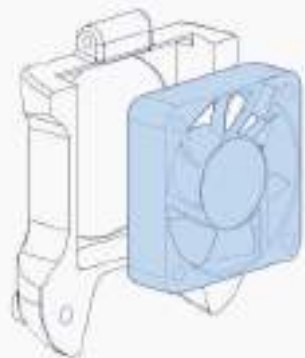

Piece of Filament

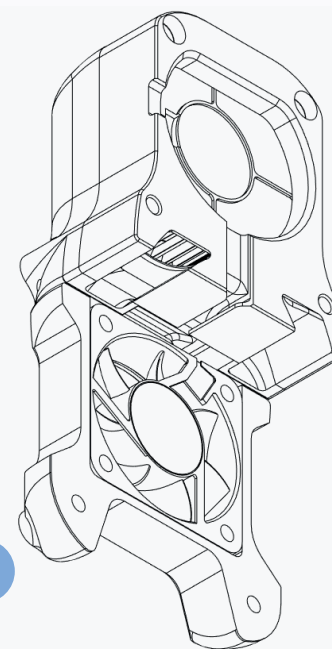

## FAN ASSEMBLY

WWW.VORONDESIGN.COM

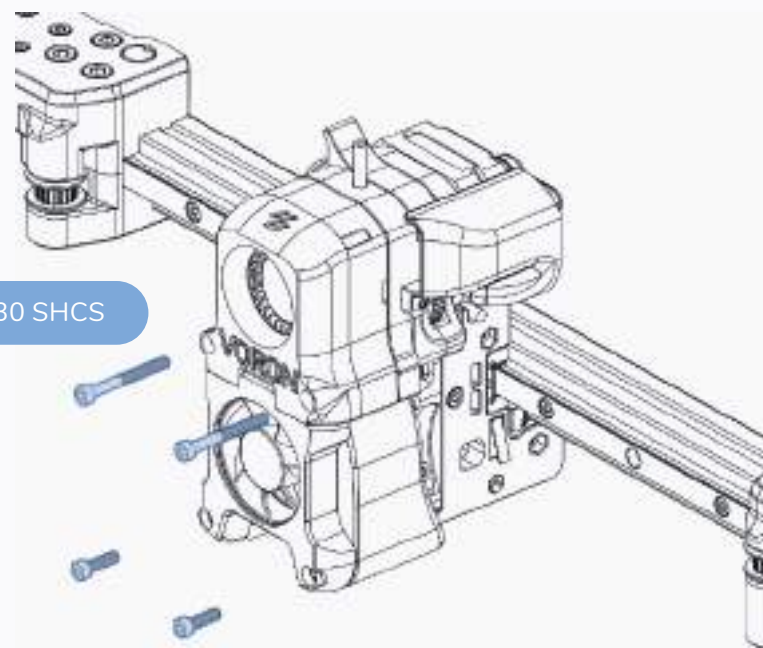
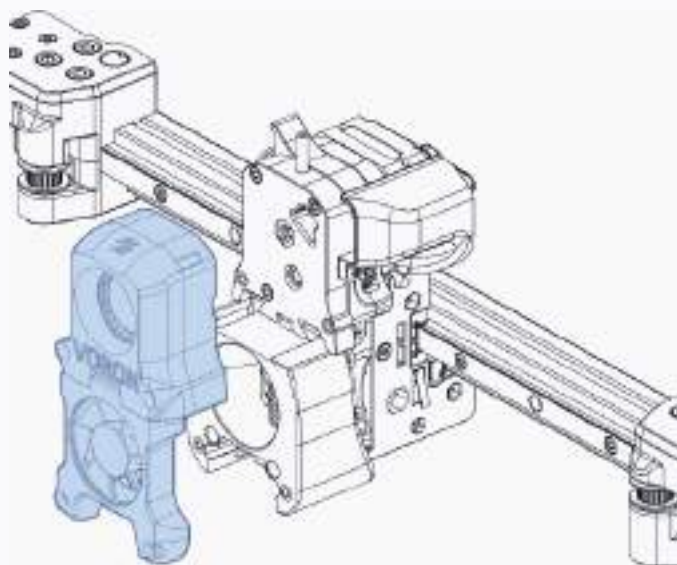

M3x30 SHCS

M3x12 SHCS



This page intentionally left blank.



## Y ENDSTOP

WWW.VORONDESIGN.COM

### SOLDER WIRES

Solder 500mm of wire to the microswitch before inserting it flush into the housing.

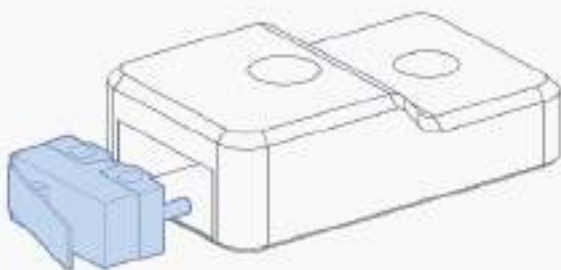

Microswitch

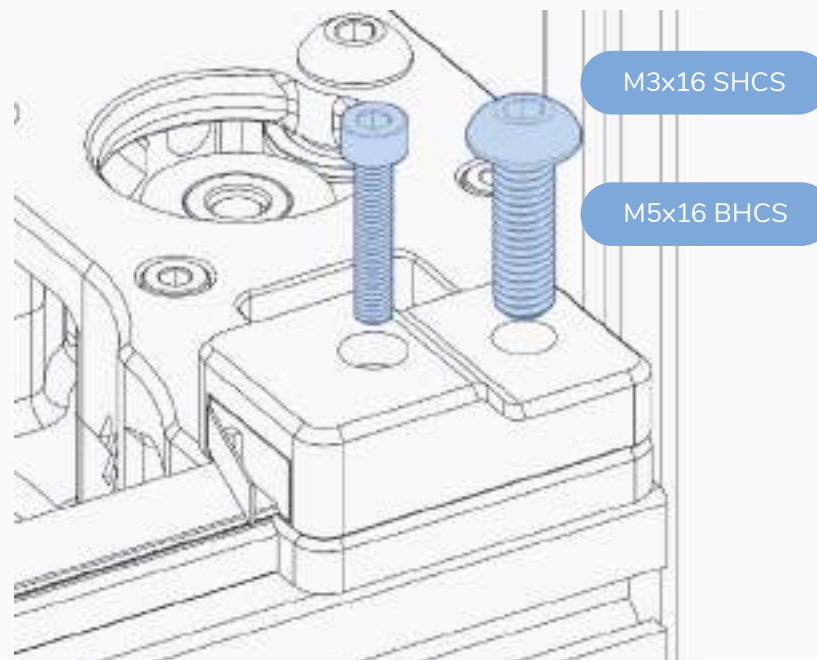
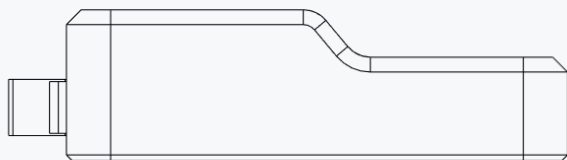

M3x16 SHCS

M5x16 BHCS

### PRELOADED NUTS

The nuts have been installed several chapters before.

GT2 Pulley

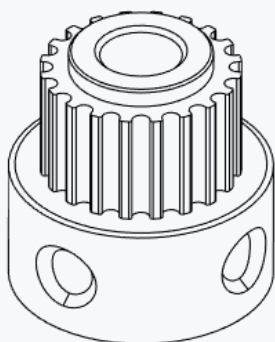

## REMOVE FLANGE & GRUB SCREWS

Use a bottle opener or some pliers to remove the top flange.

Remove the grub screws from the pulley.

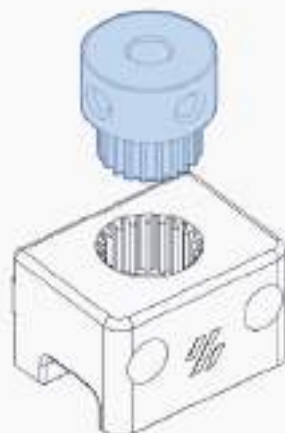

## PRESS FIT

Apply the required force to fully seat the pulley in the printed part.

M2x10 Self Tapping



## SOLDER WIRES

Solder 100mm of wire to the microswitch before inserting it into the housing.

Microswitch

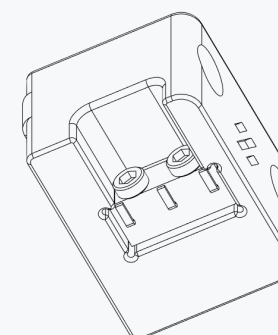

## Z ENDSTOP

WWW.VORONDESIGN.COM

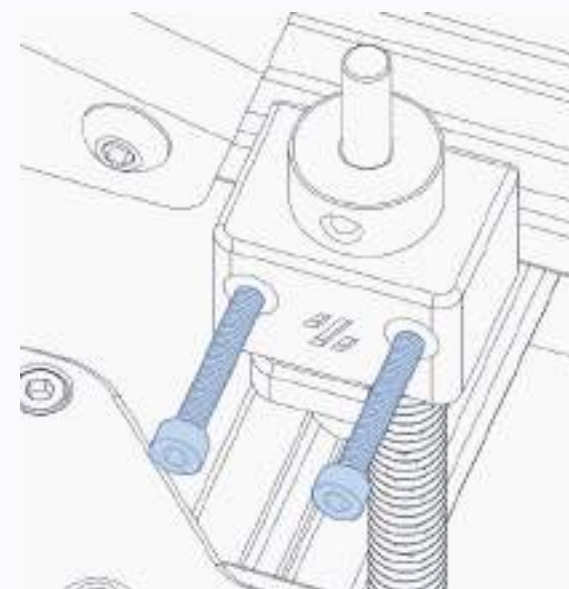
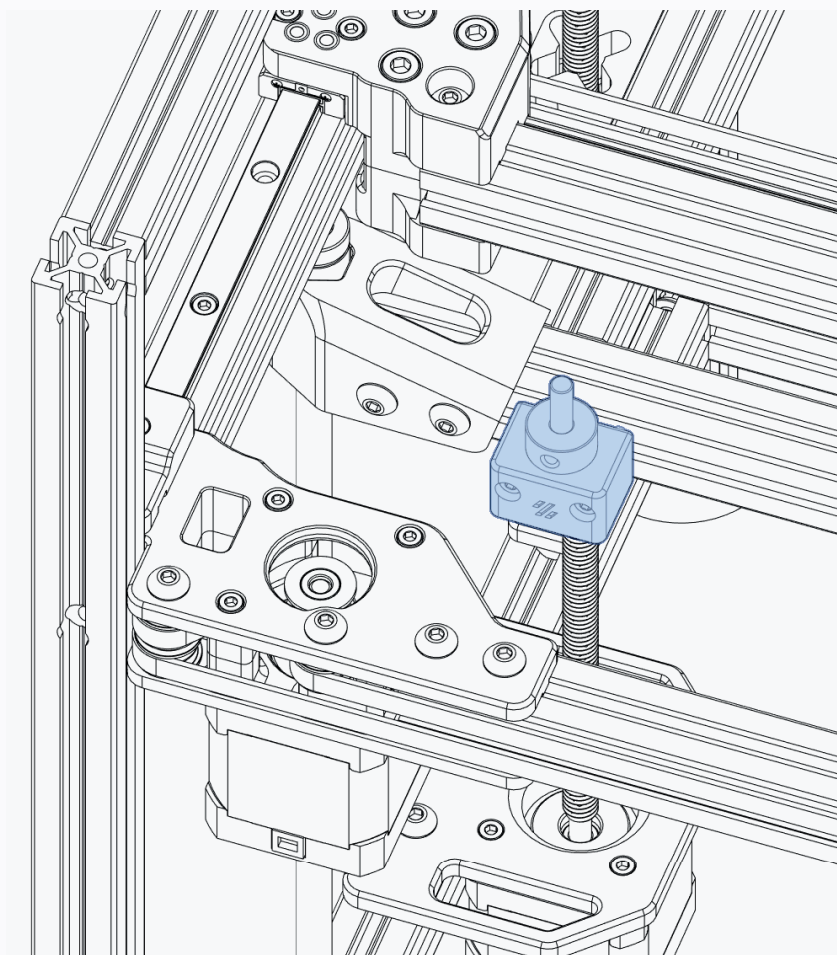
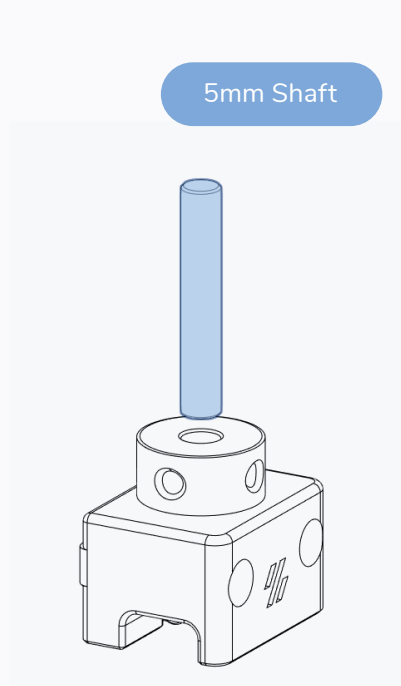

M3x20 SHCS

## CABLE CHAIN

WWW.VORONDESIGN.COM

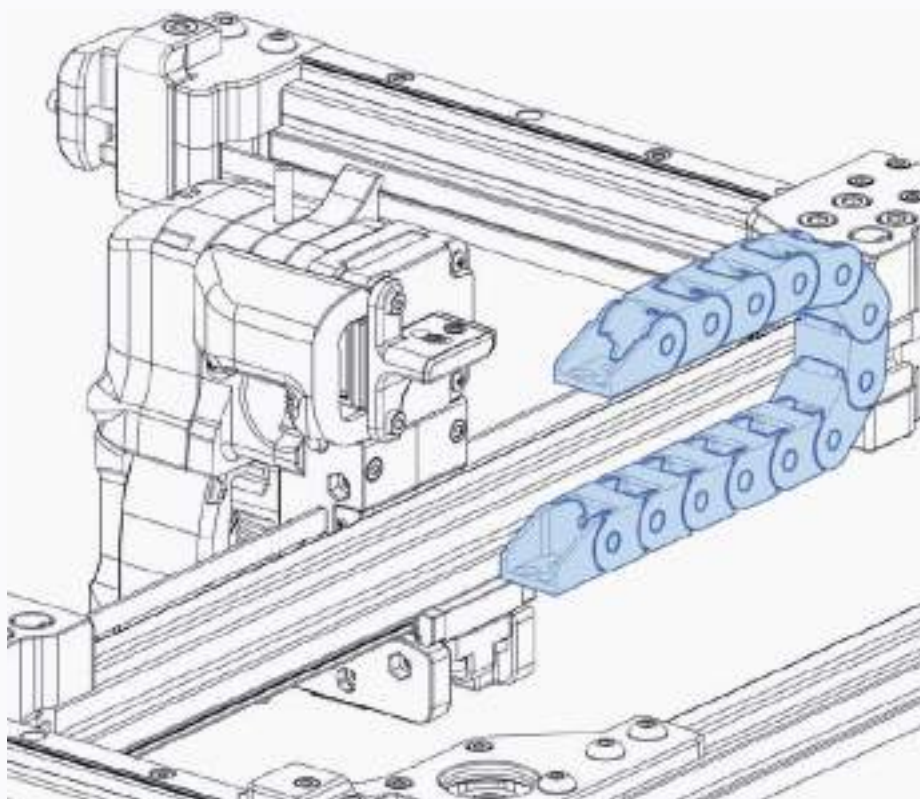

### FIXED END VS. FREE END

Some cable chains only have one end that is able to swing freely. Use this end on the back of the Afterburner.

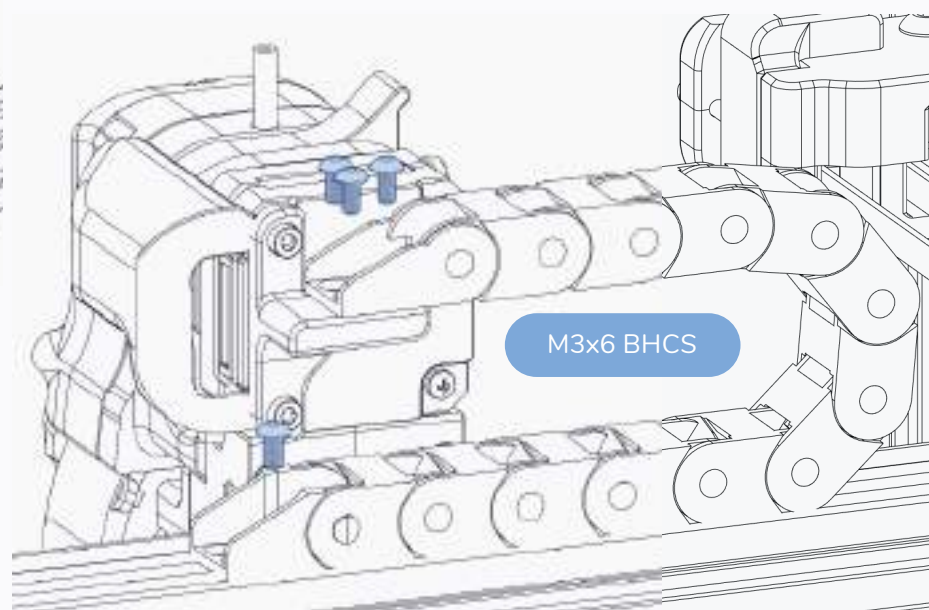



## CABLE CHAIN

WWW.VORONDESIGN.COM

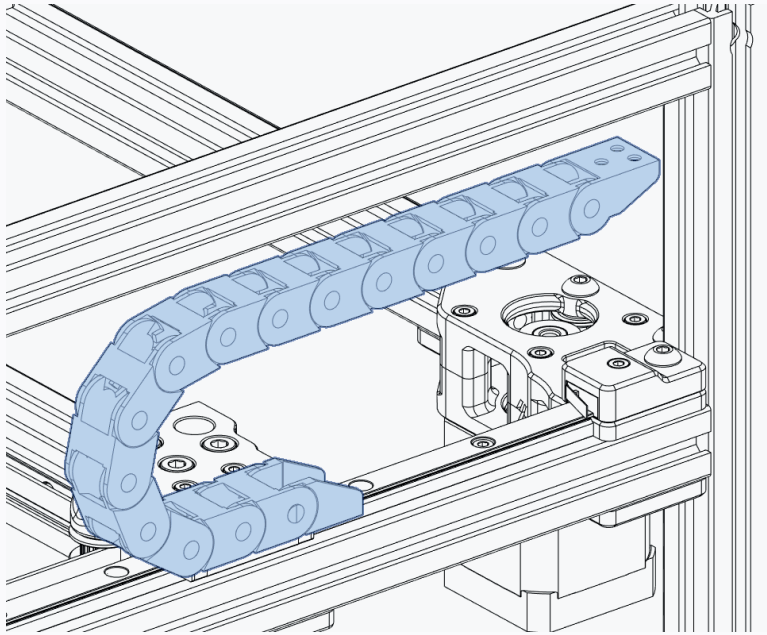

### FIXED END VS. FREE END

If you cable chain as a fixed and use this end on the XY joint.

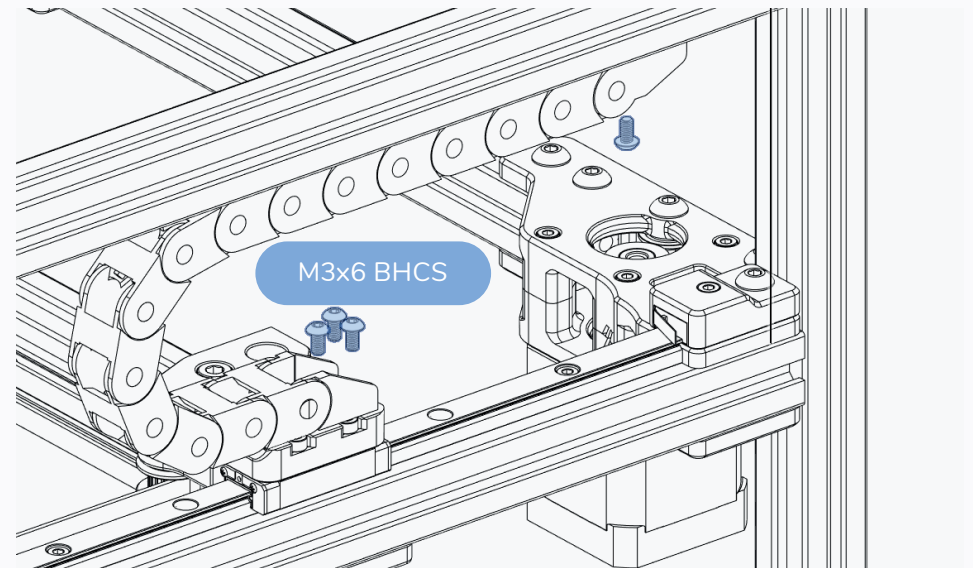

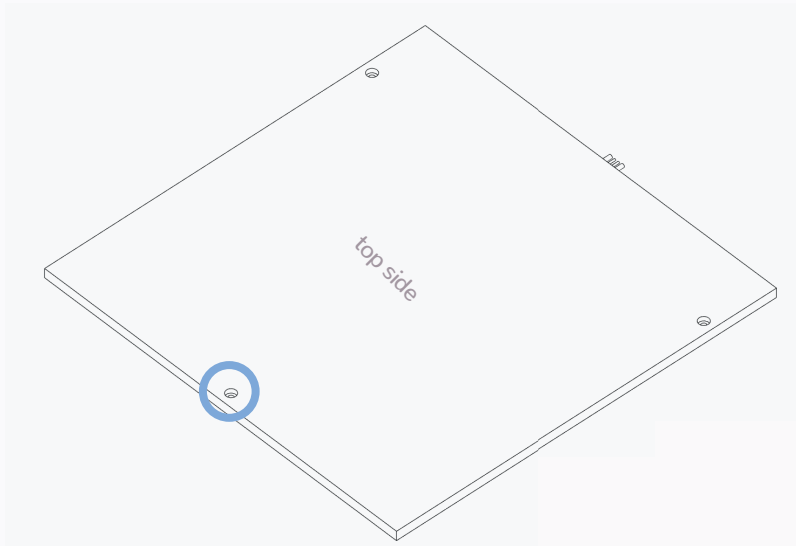

## PRINT SURFACE

The print surface can be applied directly to the print bed or alternatively a magnet based removable system can be used.

A removable surface is recommended. Preinstalling the screws is possible but not recommended as those will interfere with the heater application.

Read/watch a guide about the proper application if you are unsure.

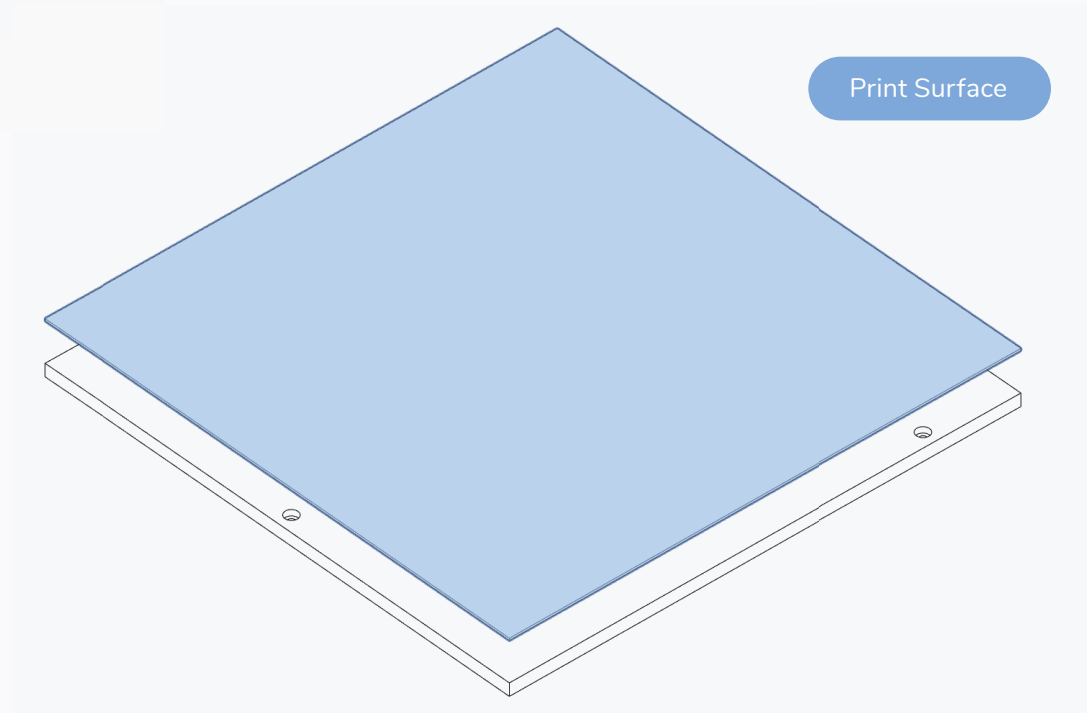

## PRINT BED

WWW.VORONDESIGN.COM

### HEATER APPLICATION

Attach the heater to the bottom of the plate with wires facing away from the center hole.

Read/watch a guide on heater installation if you are unsure about the procedure.

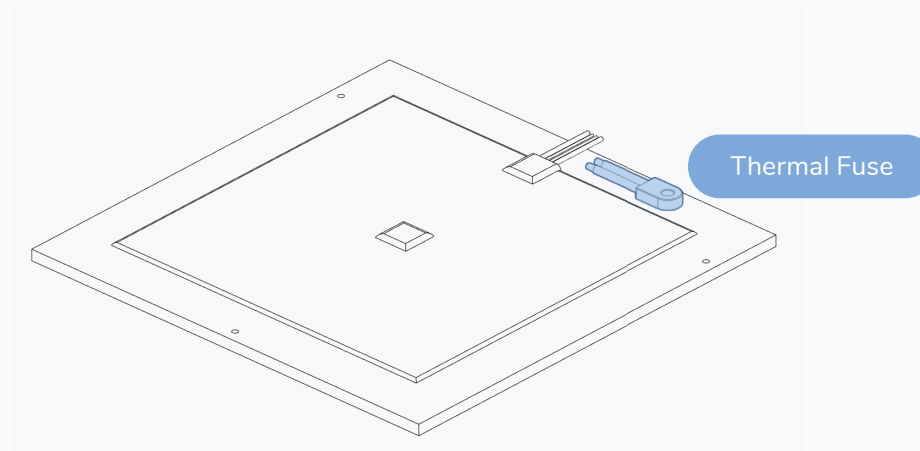
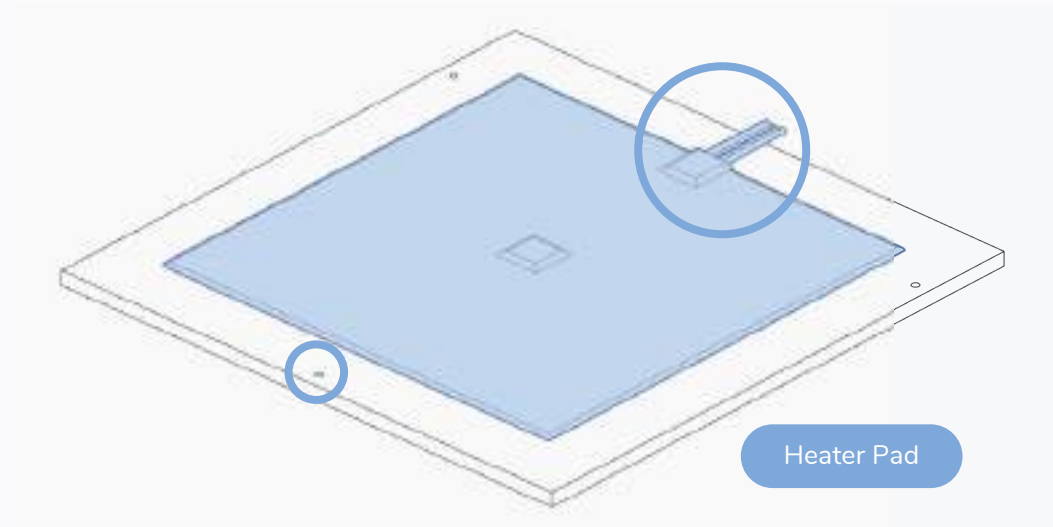



# SCREW ACCESS HOLES

Cut holes for the screws.

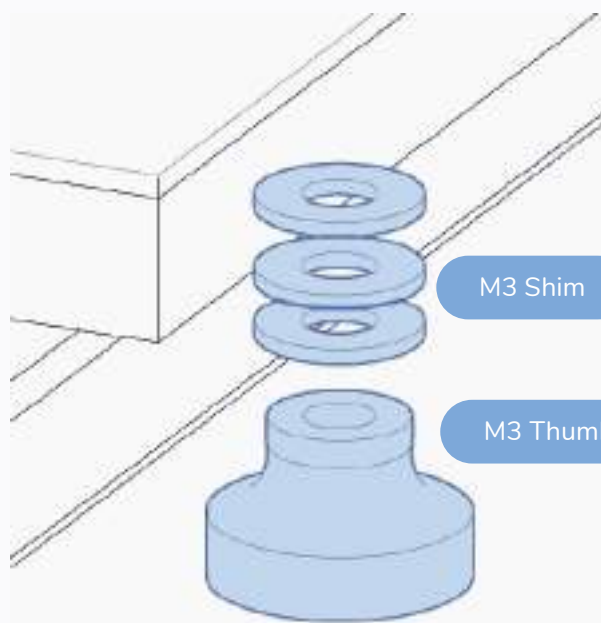

M3 Shim

M3 Thumb Nut

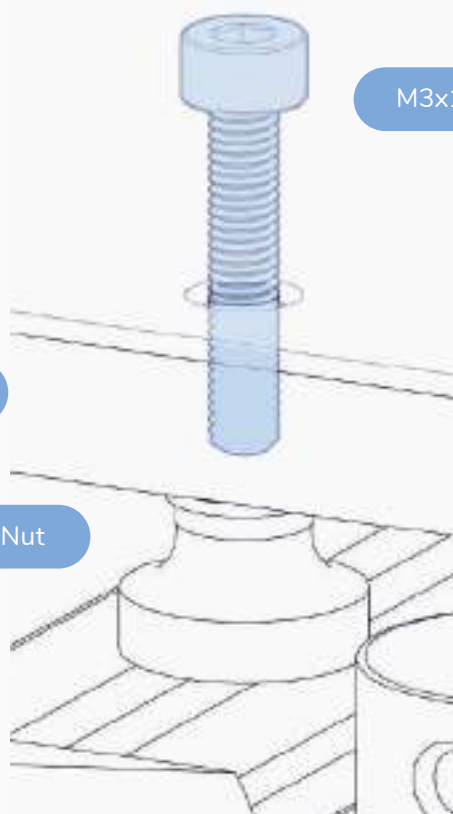

M3x16 SHCS

# REPEAT FOR SECOND MOUNT

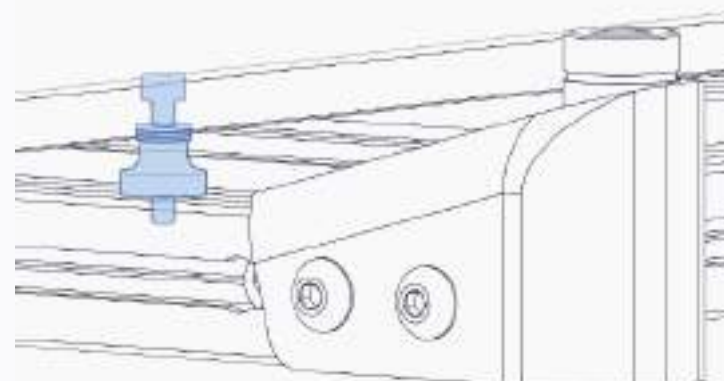

## PRINT BED

WWW.VORONDESIGN.COM

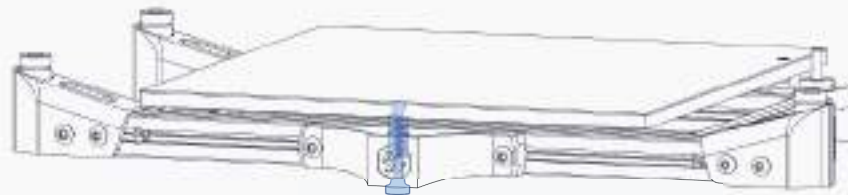

M3x40 SHCS

Die Spring

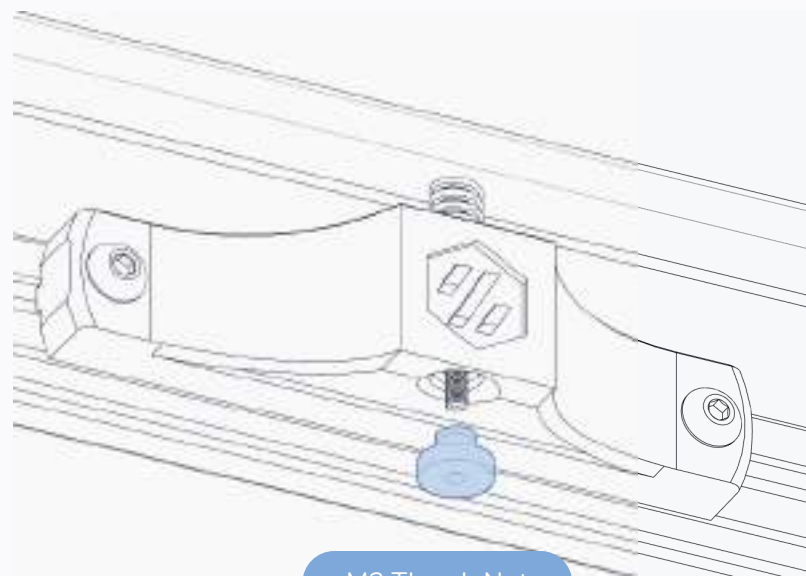
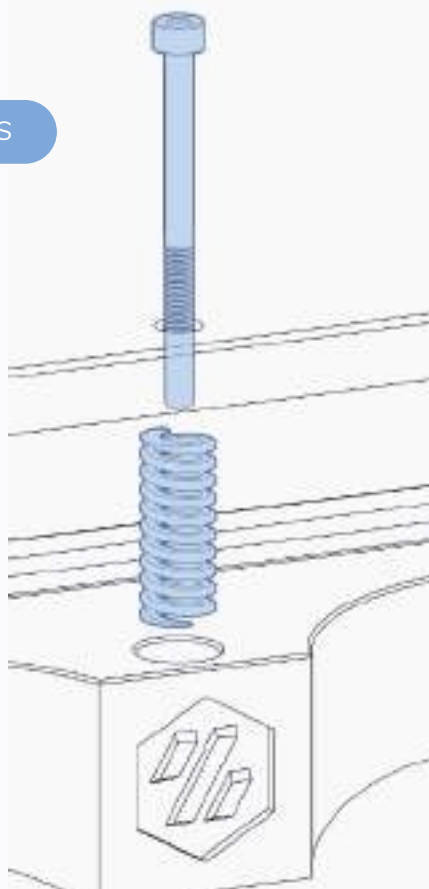

M3 Thumb Nut

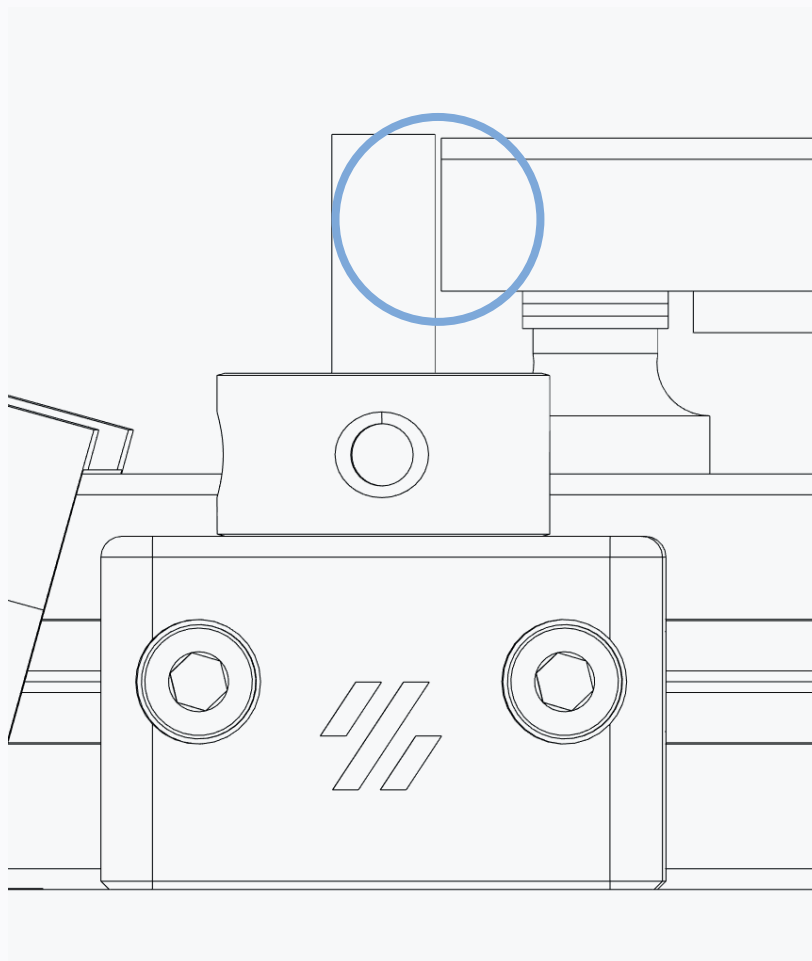

### ADJUST Z ENDSTOP POSITION

The shaft of the Z Endstop must not touch the print bed.

Adjust the position if required.



This page intentionally left blank.



## POWER INLET

WWW.VORONDESIGN.COM

Heat Set Insert

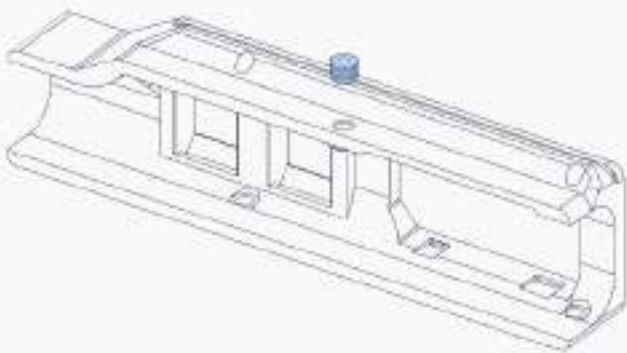

Keystone Blank

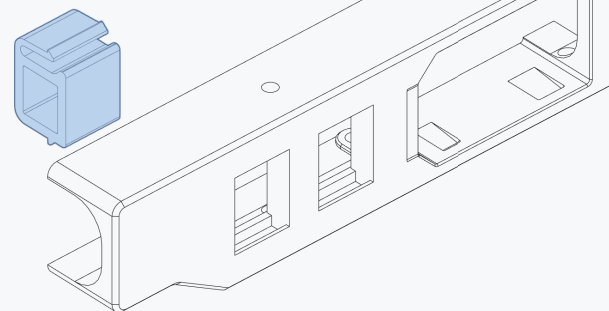

RJ45 Keystone Adapter

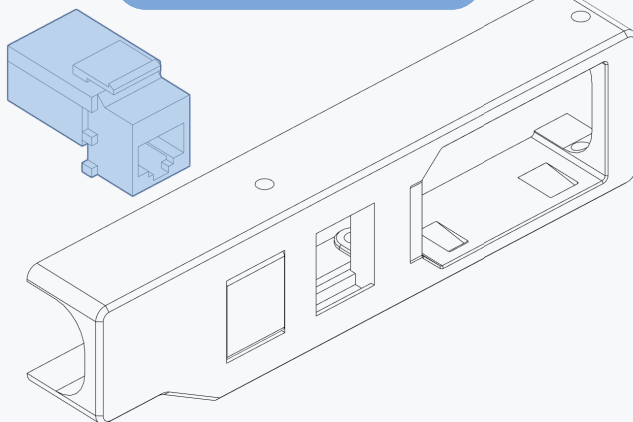

Power Inlet

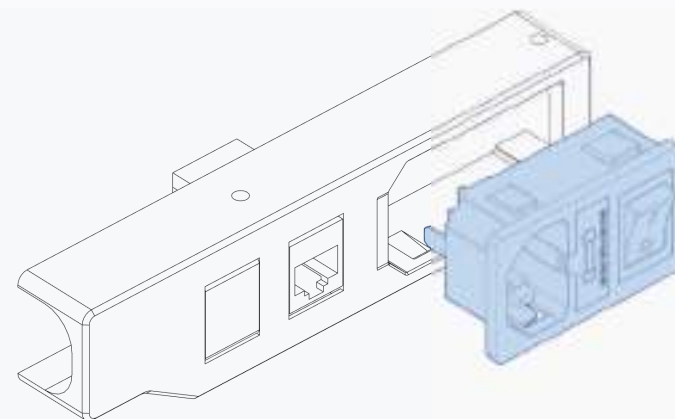

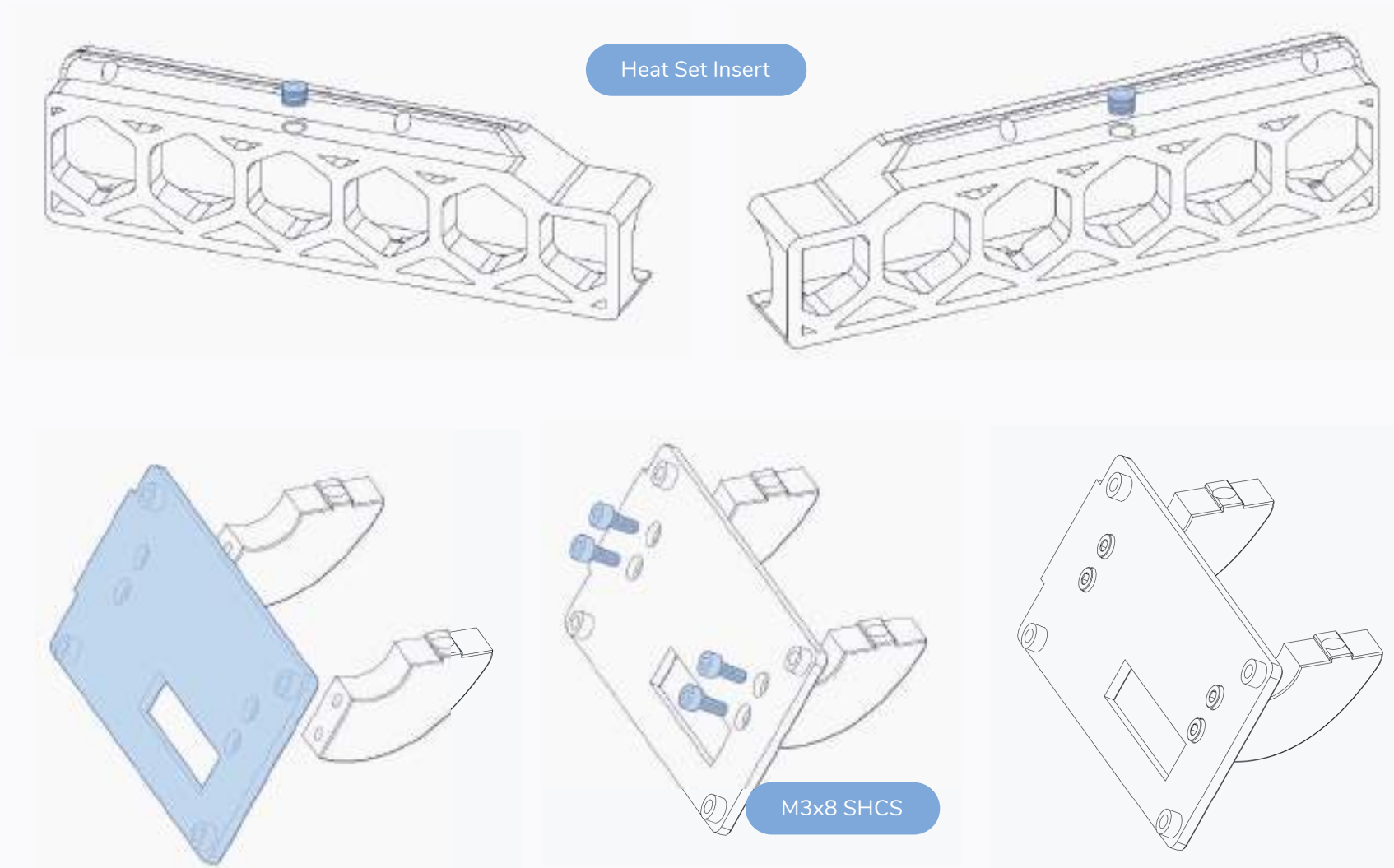

## DISPLAY

WWW.VORONDESIGN.COM

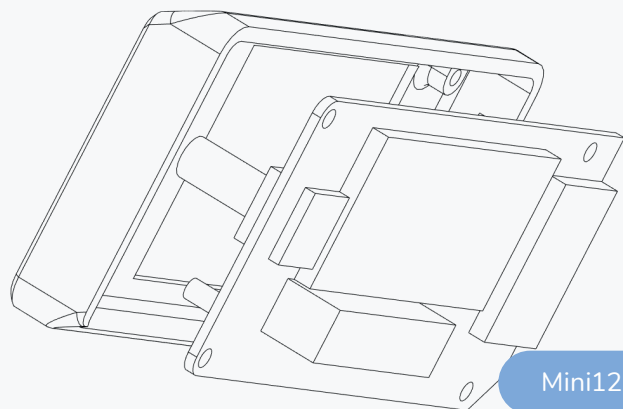

Mini12864 Display

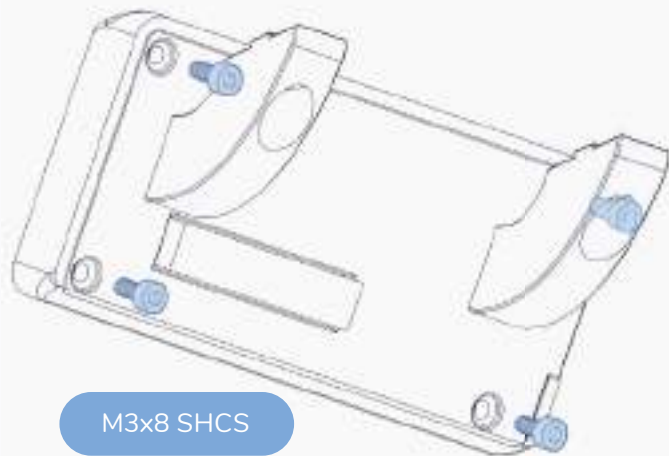
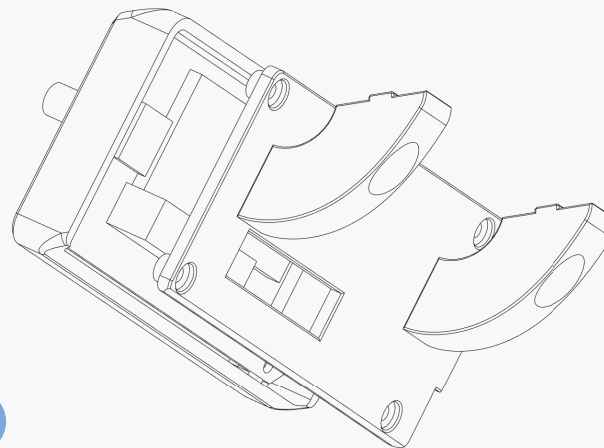

M3x8 SHCS

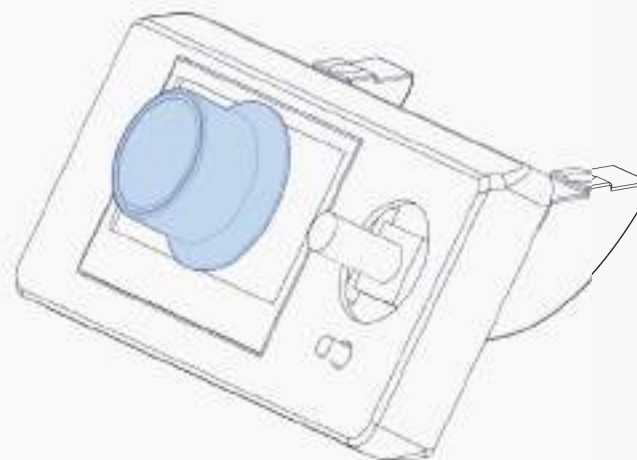

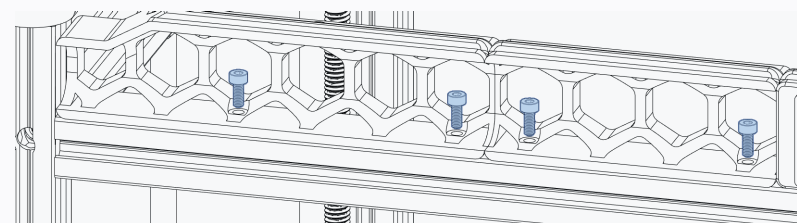
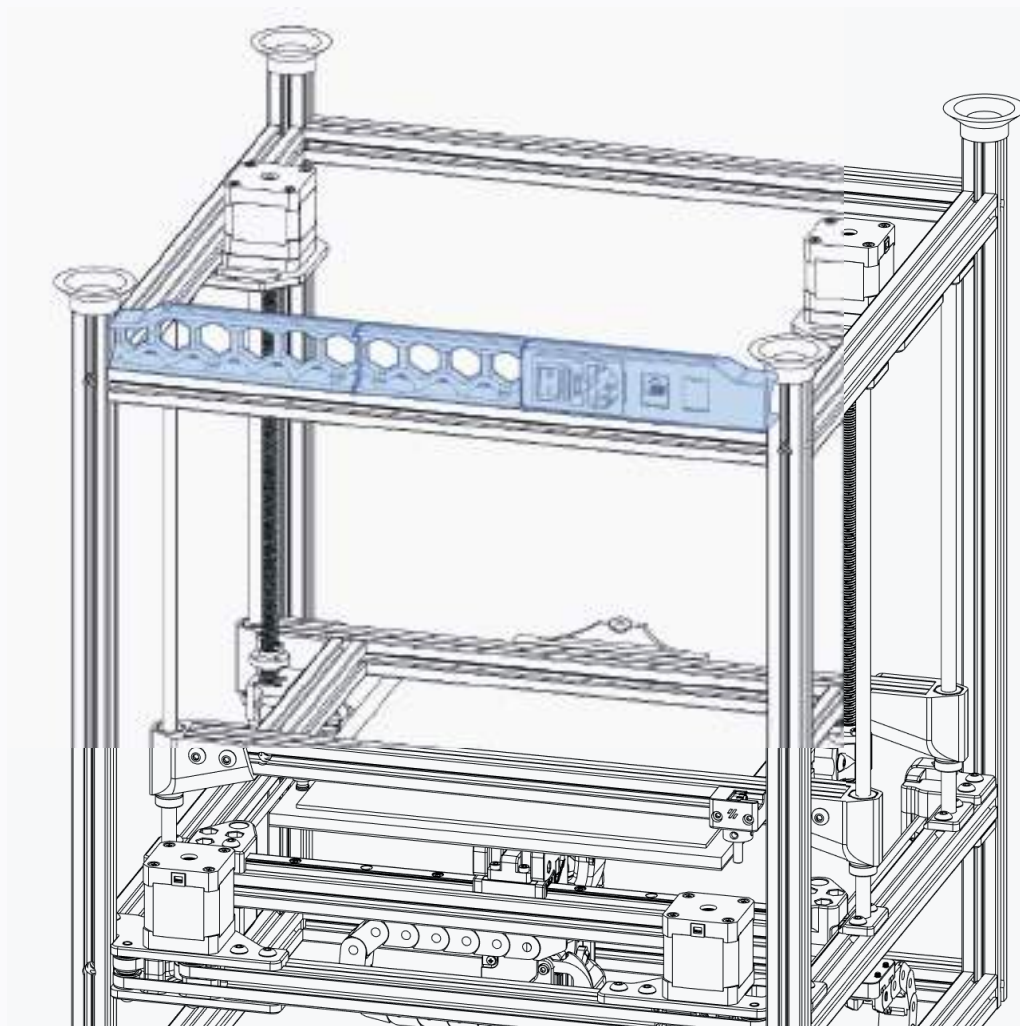

M3x8 SHCS

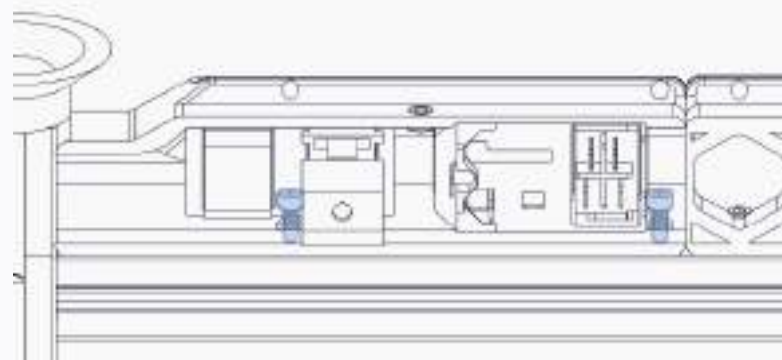



## SKIRTS

WWW.VORONDESIGN.COM

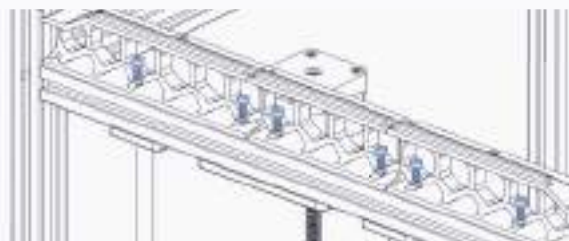

M3x8 SHCS

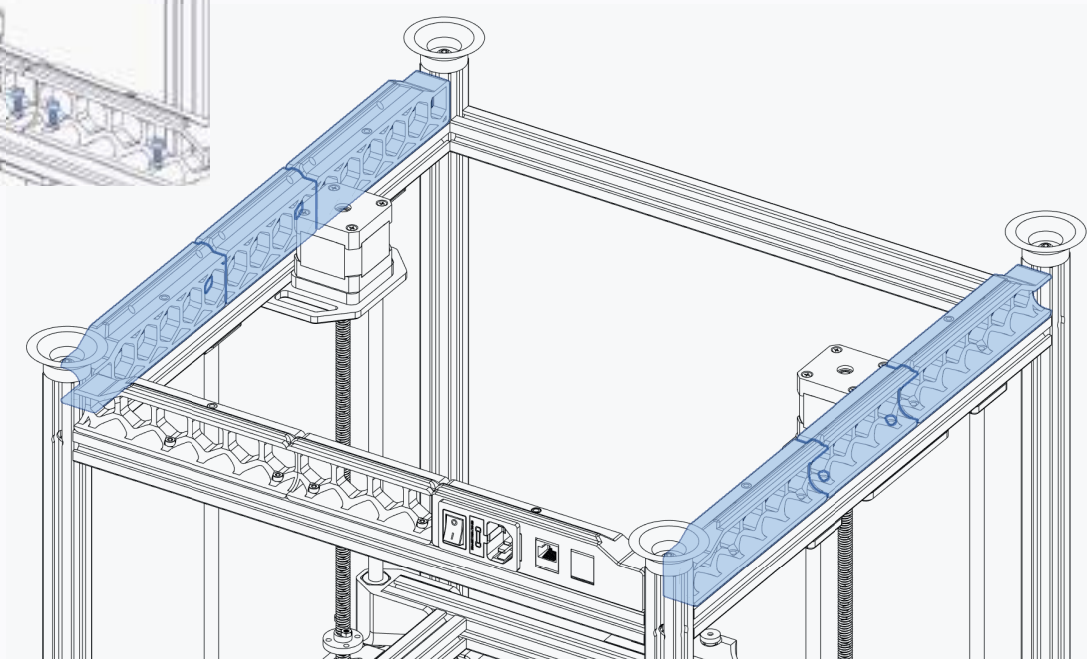

M3x8 SHCS

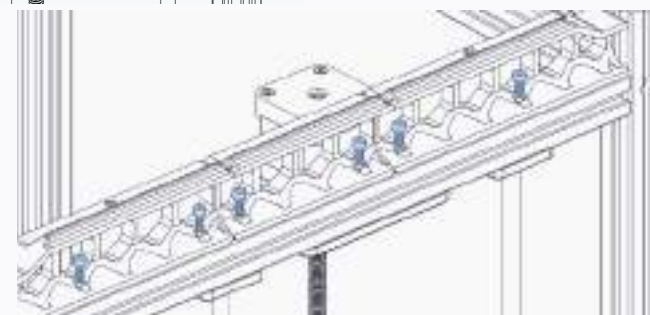

## SKIRTS & DISPLAY

WWW.VORONDESIGN.COM

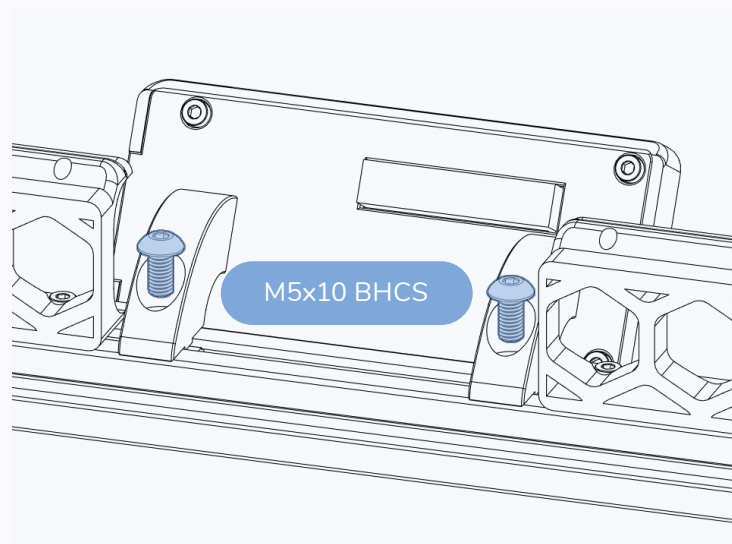
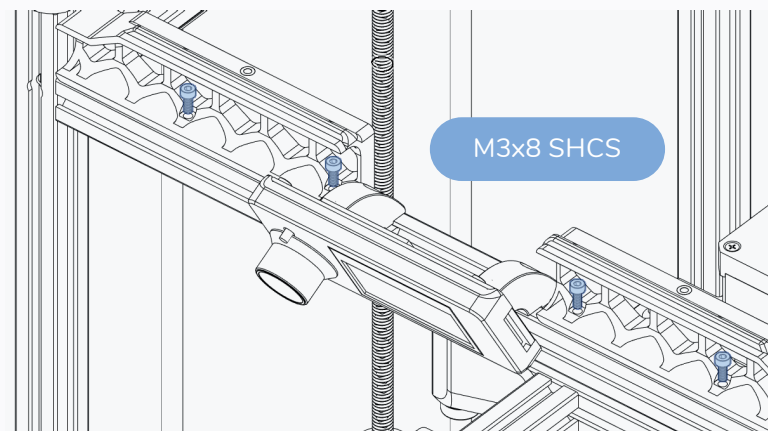
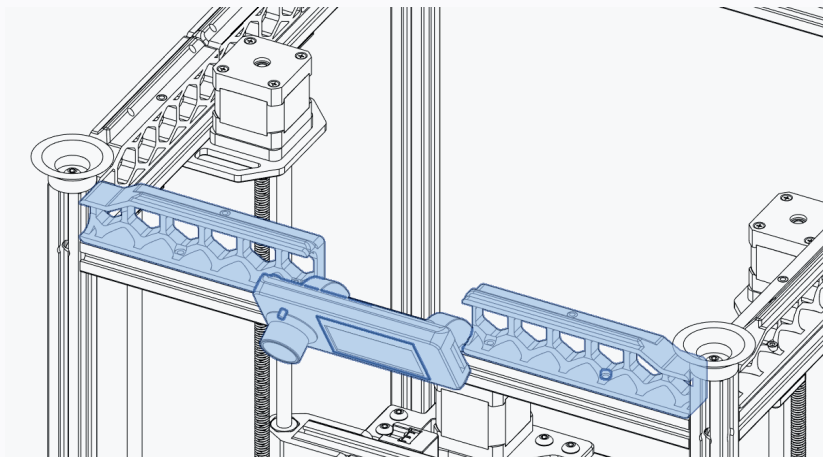

## DECK PANEL

WWW.VORONDESIGN.COM

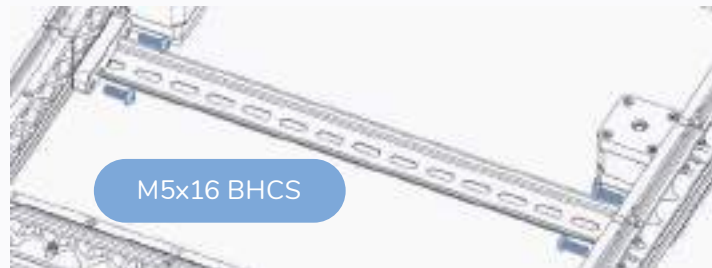
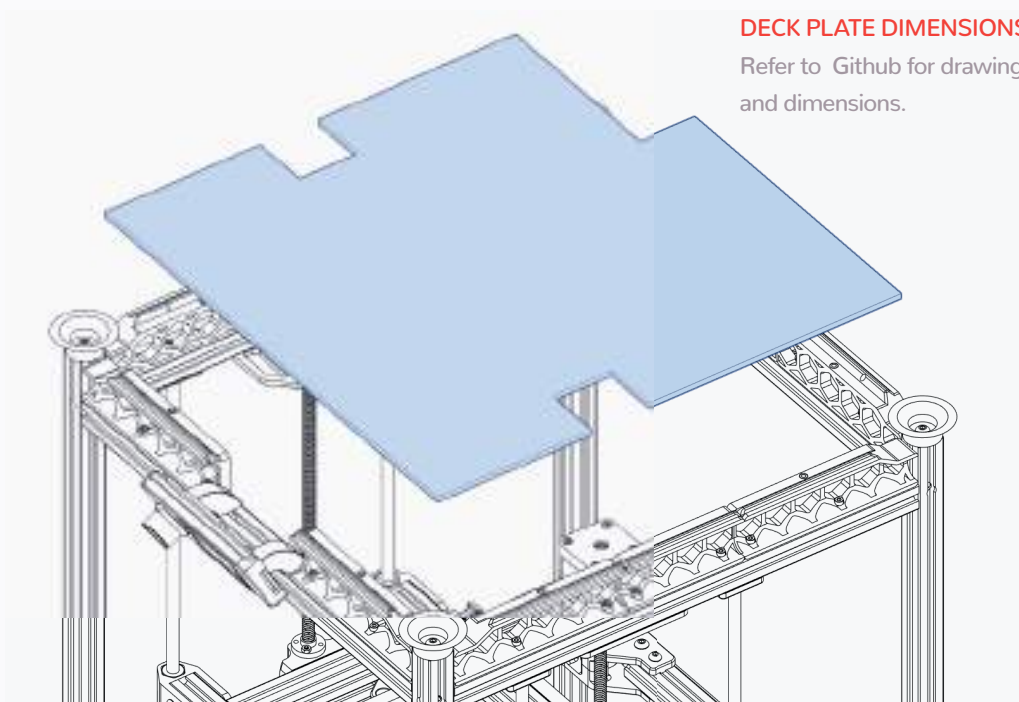



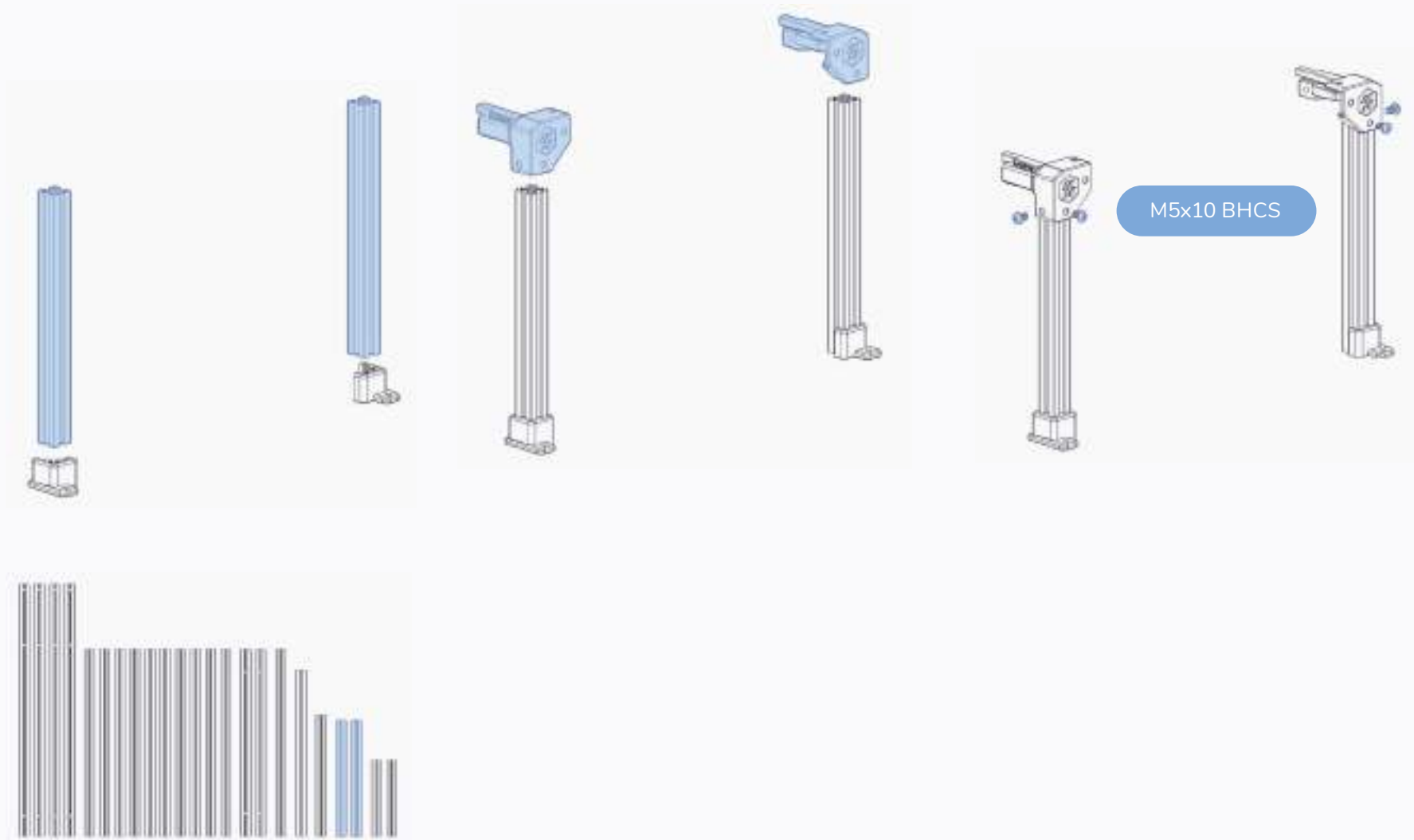

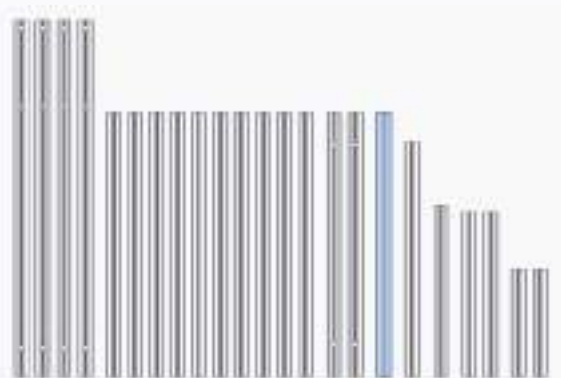
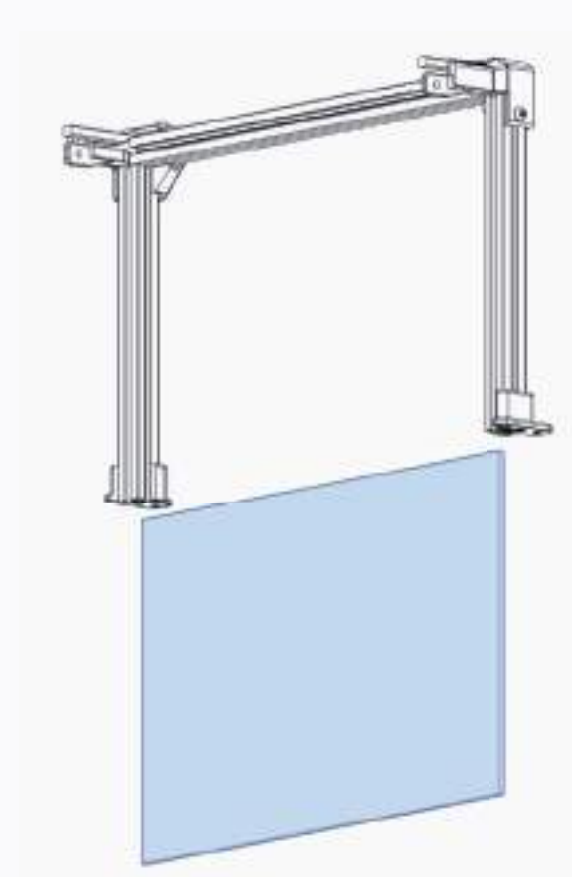
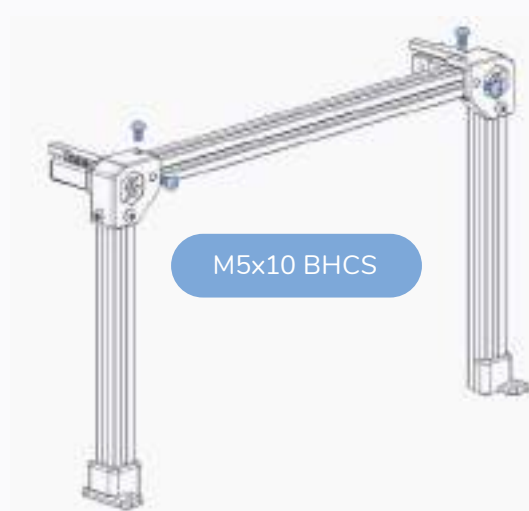



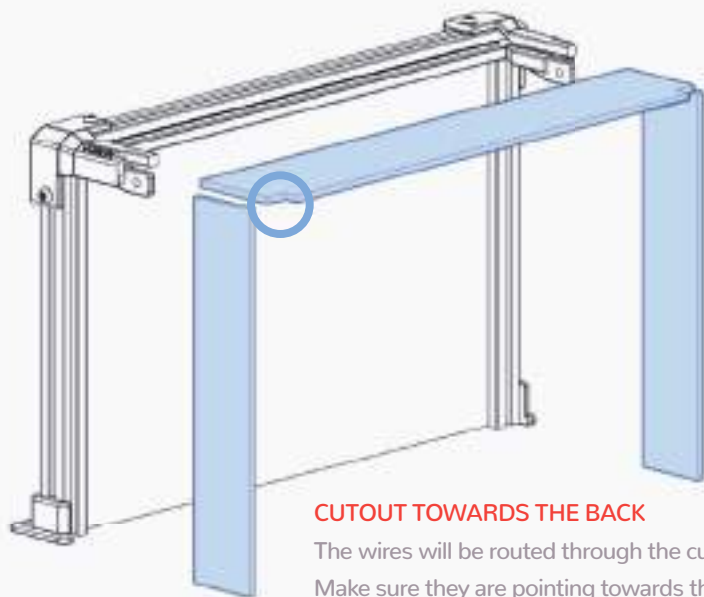

**CUTOUT TOWARDS THE BACK**

The wires will be routed through the cutouts.  
Make sure they are pointing towards the  
back of the printer.

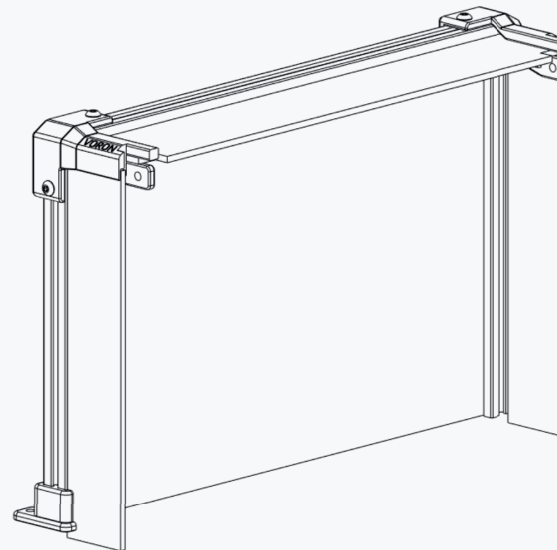

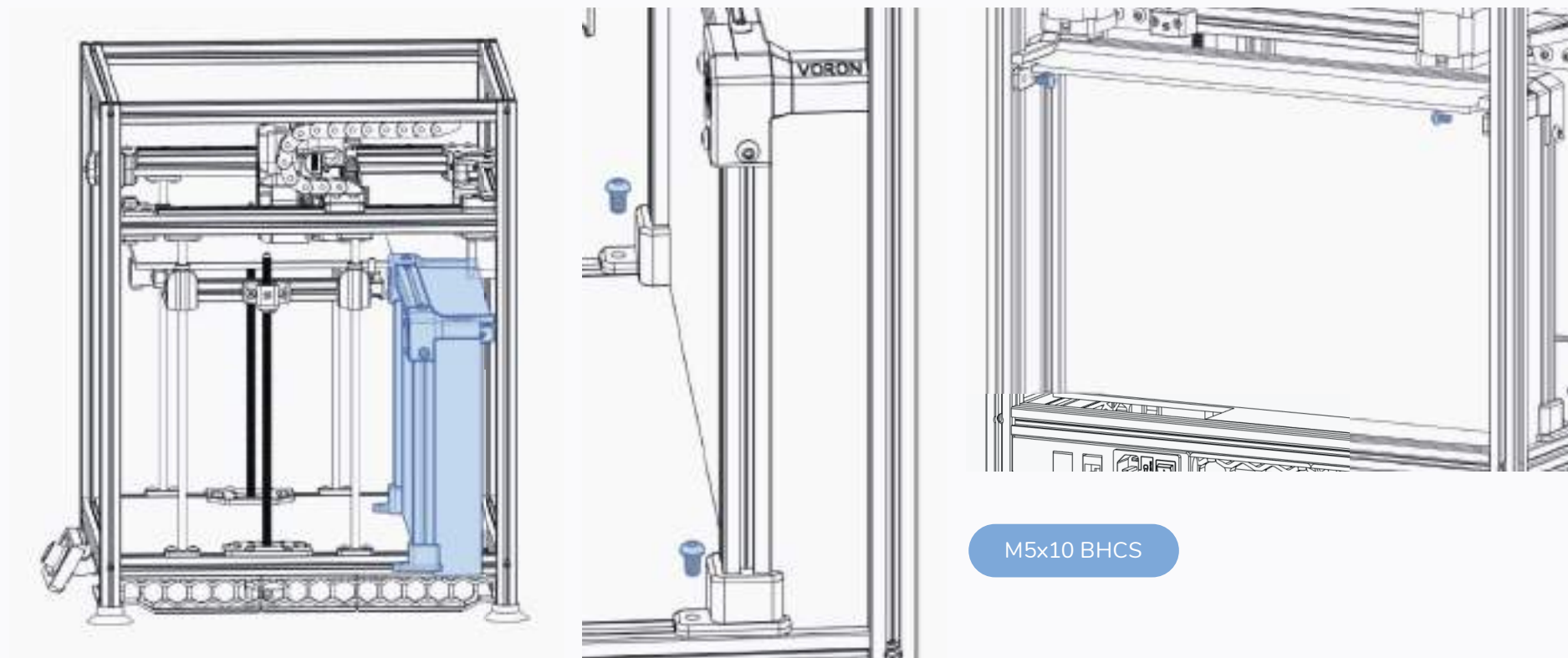

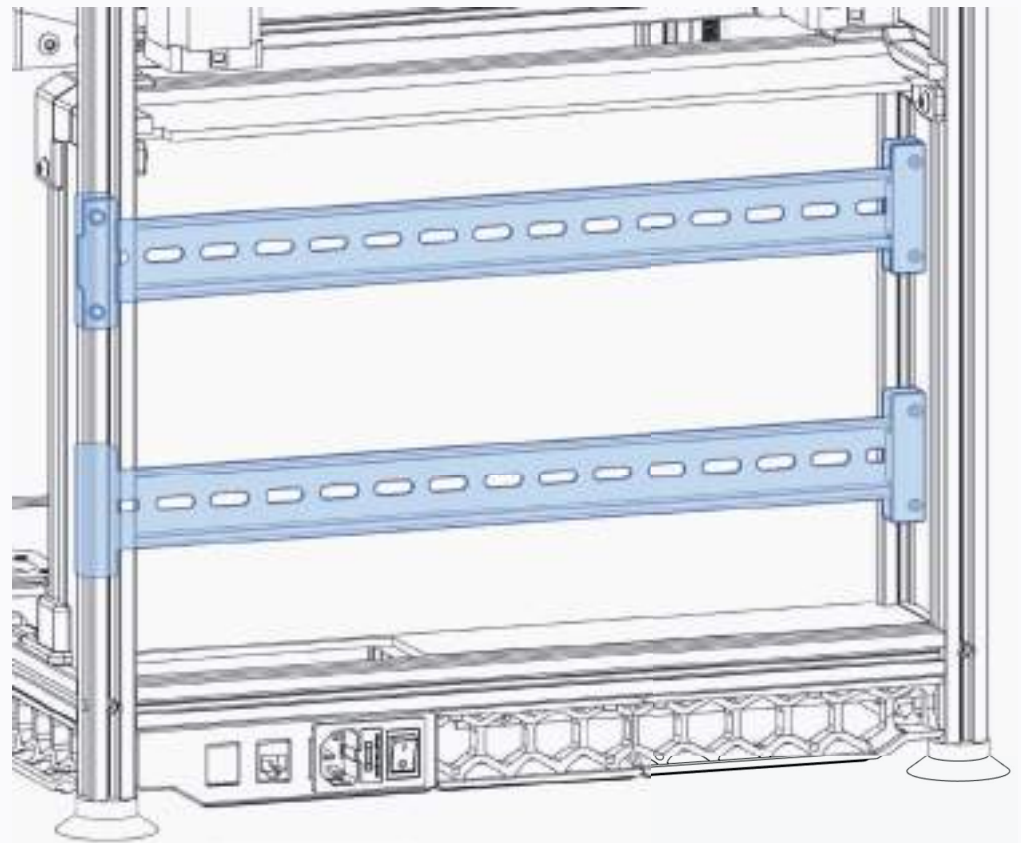
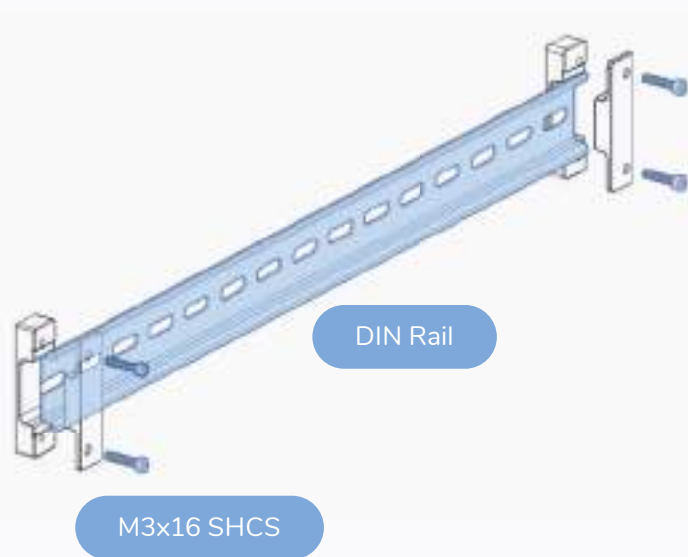

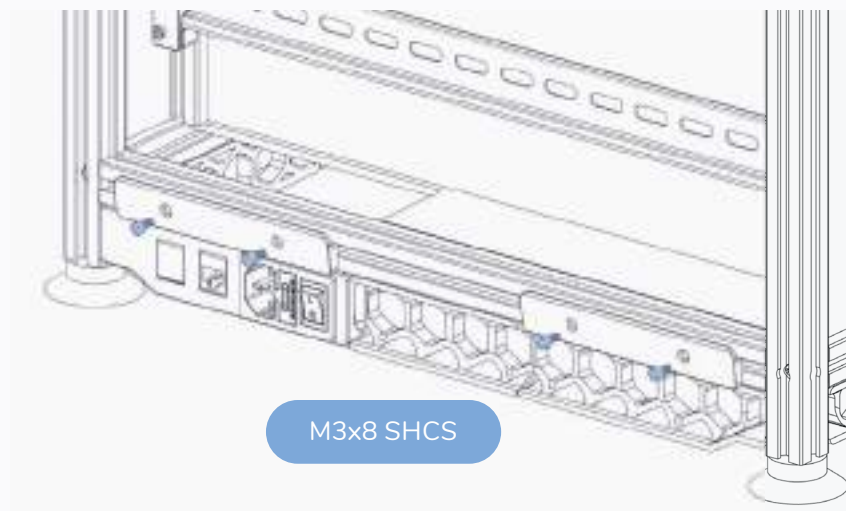
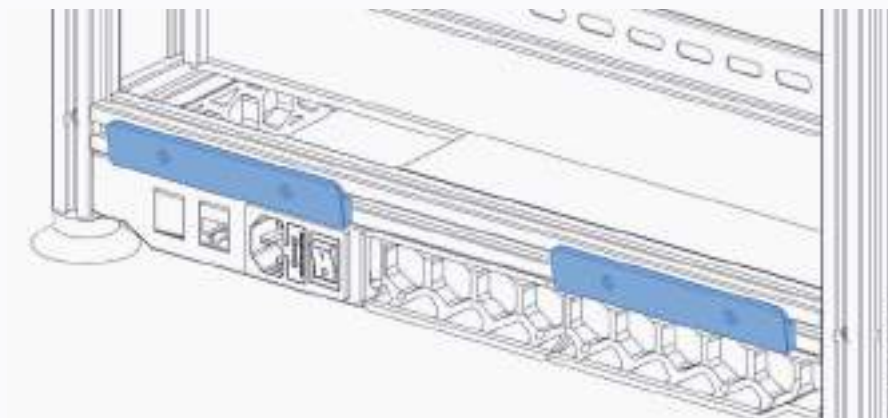

This page intentionally left blank.





SSR Din Mount

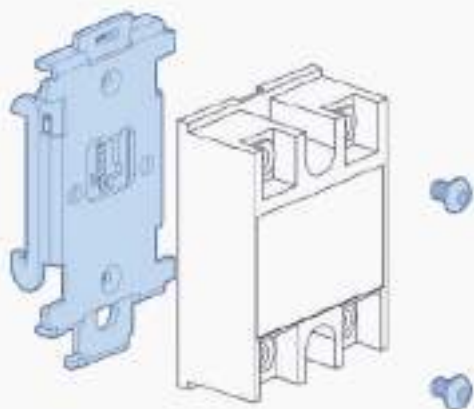

M4x6 BHCS

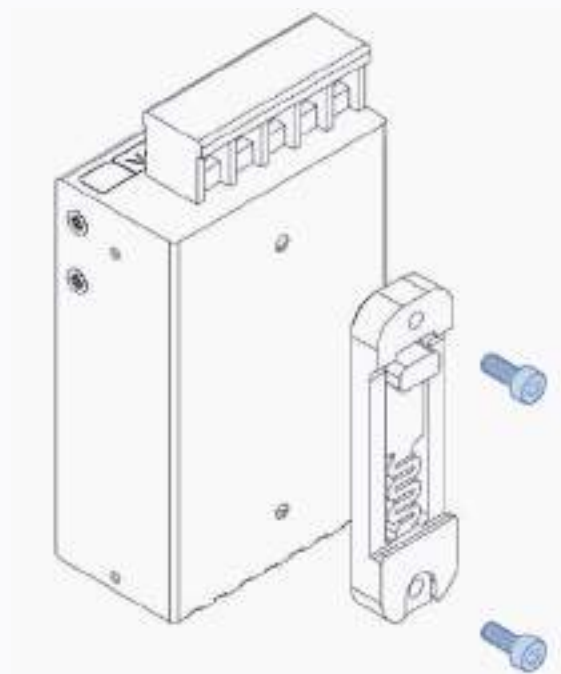

M3x8 SHCS

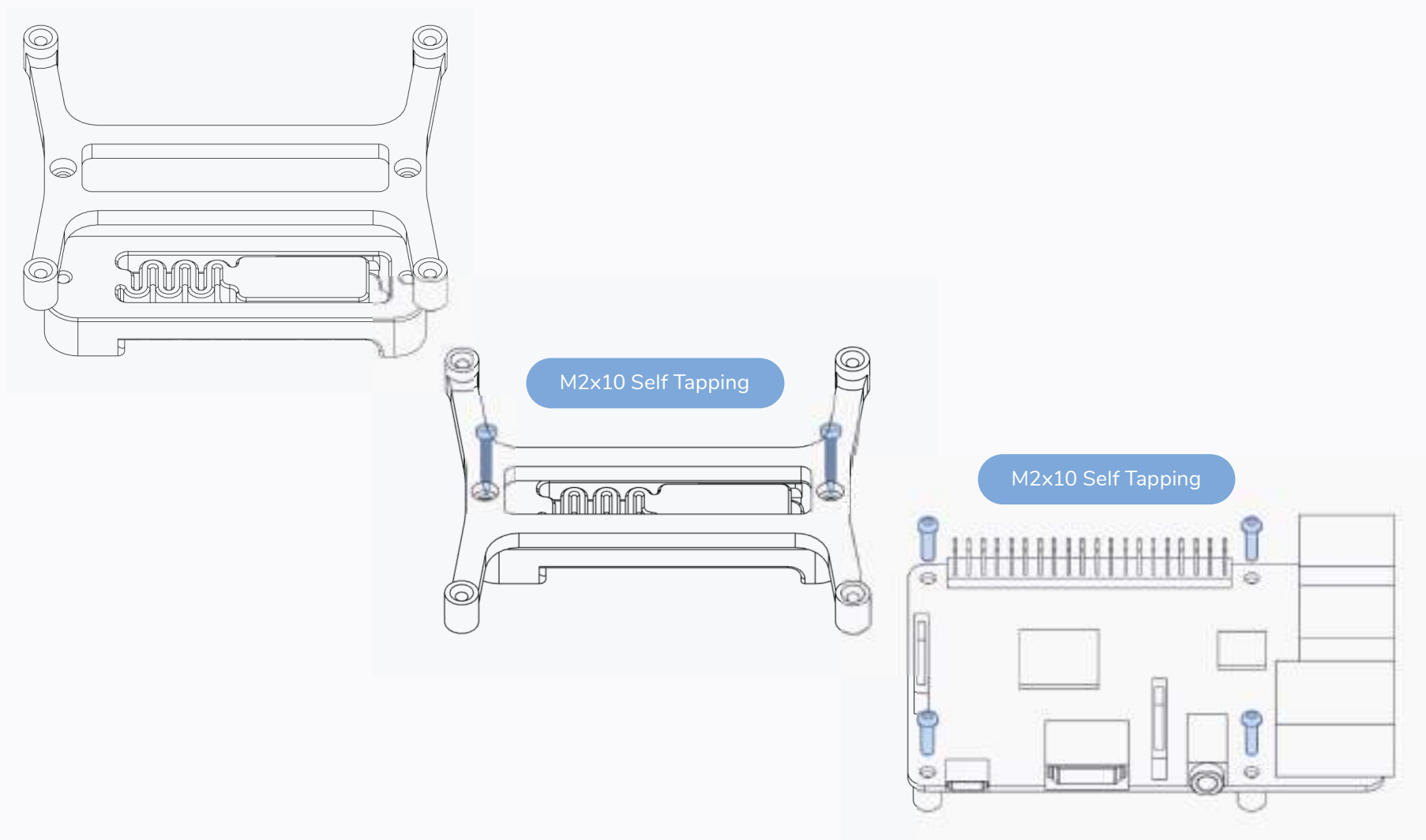

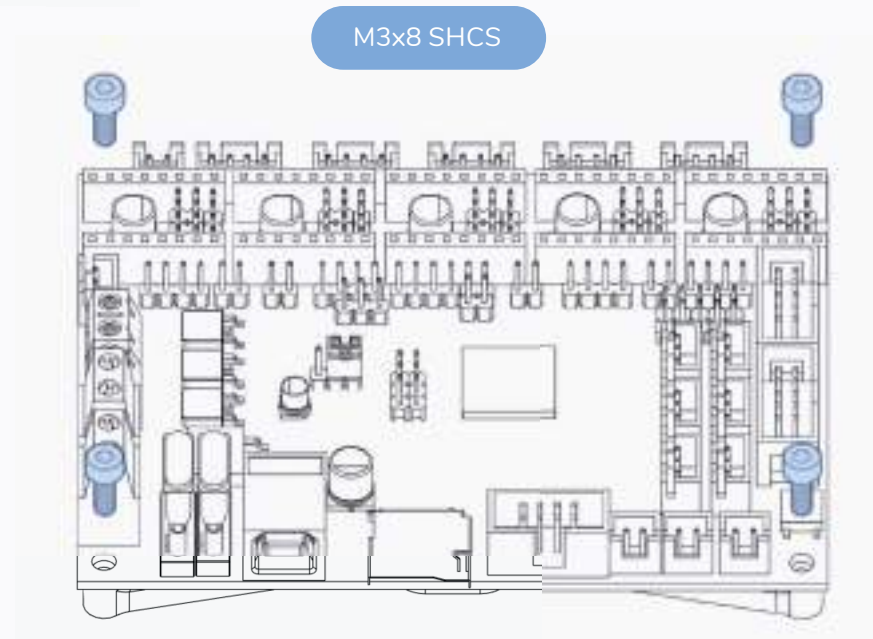
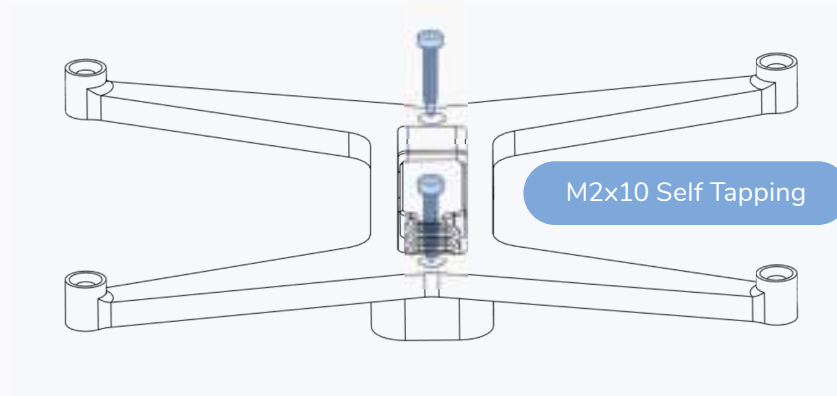

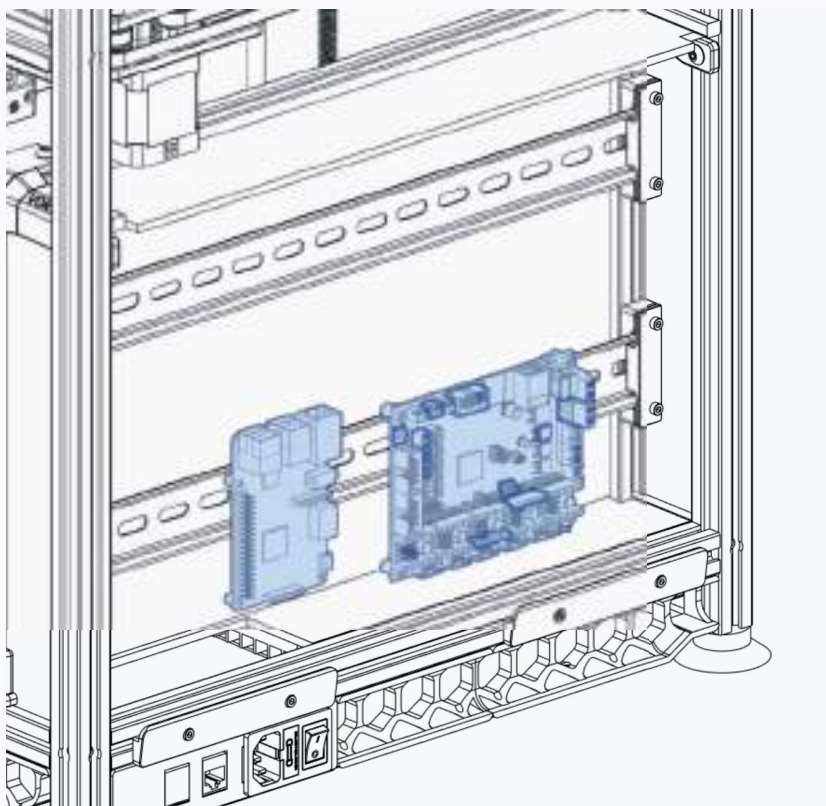

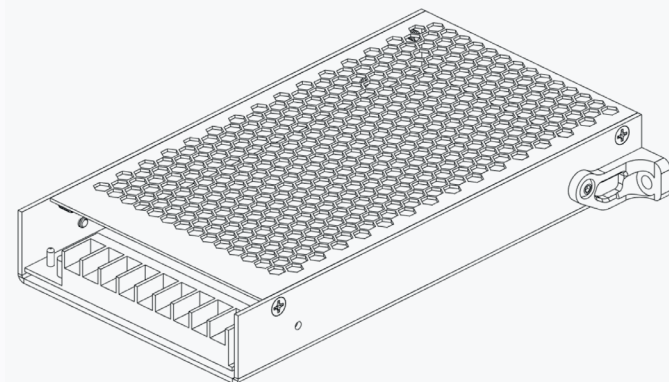
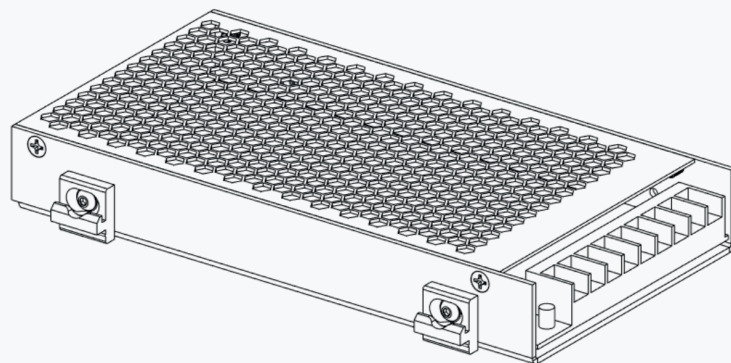
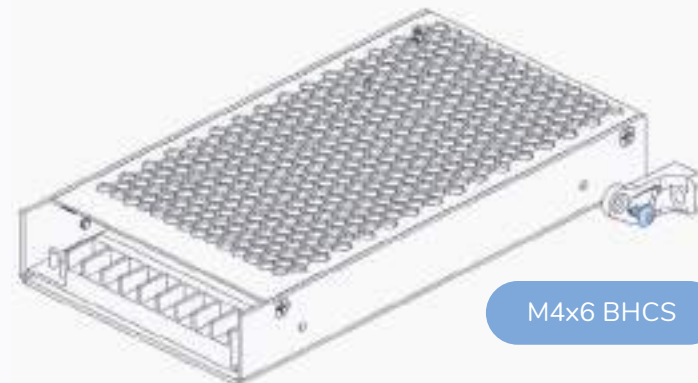
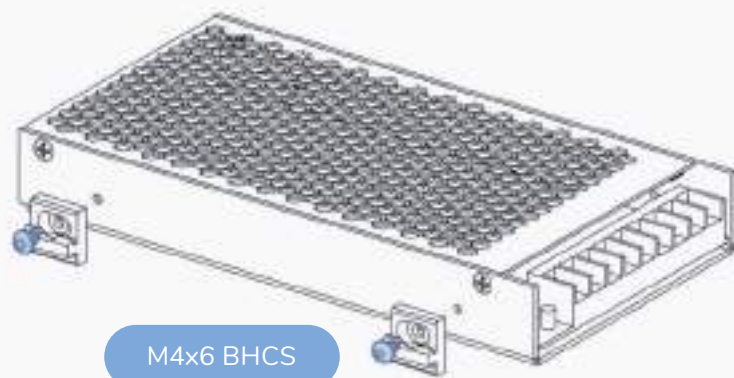

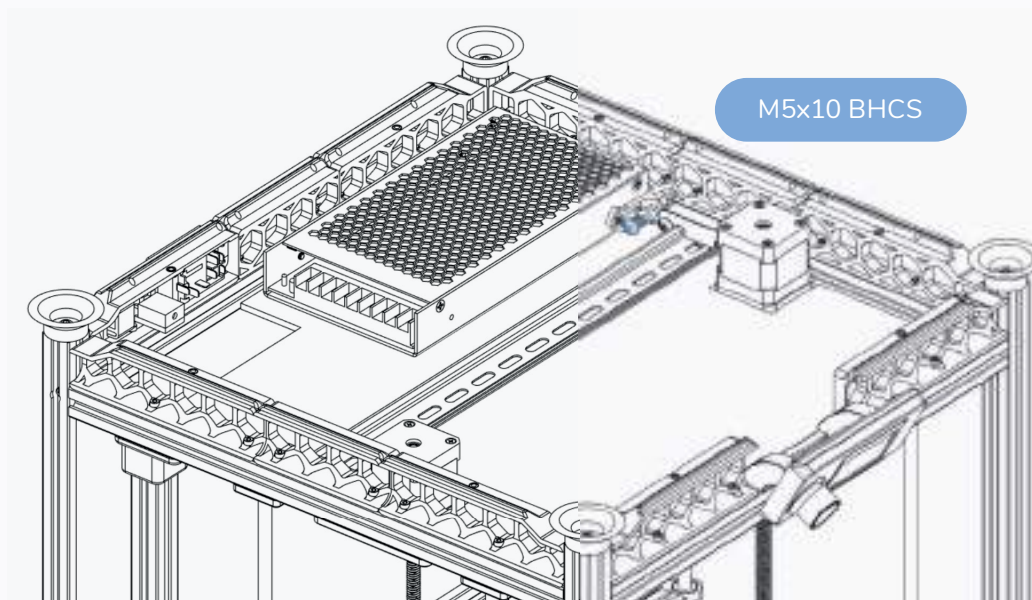
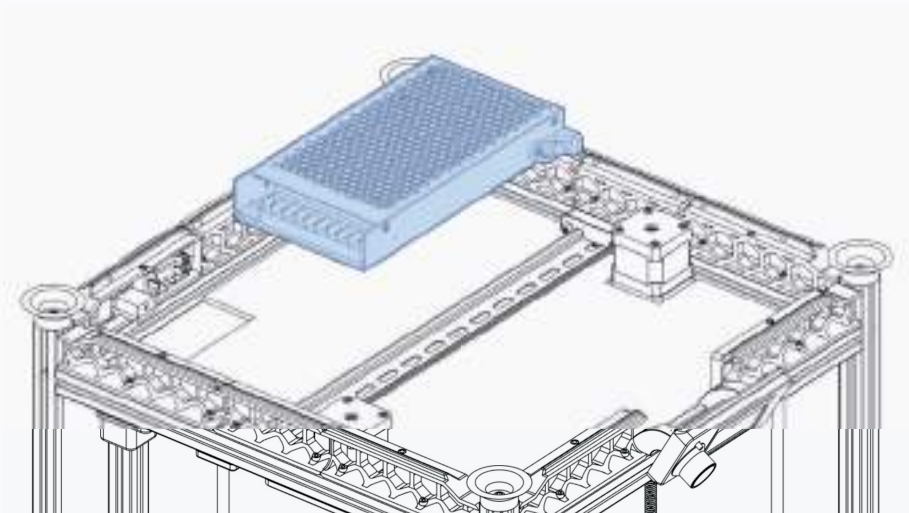

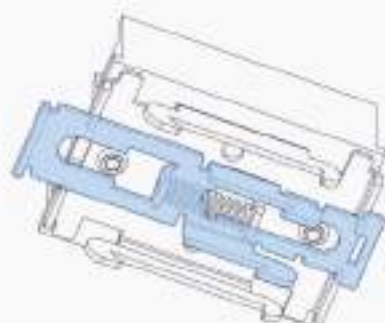
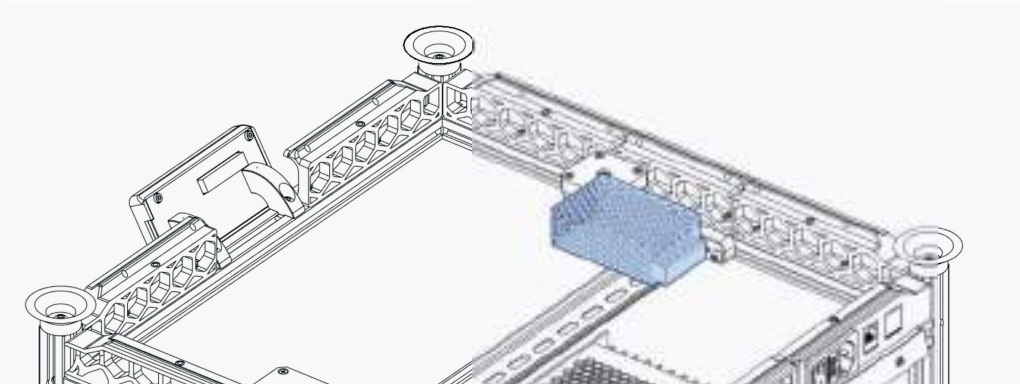

**SPRING LOADED**

Use a flat head screw driver to pull the latch open. It will lock open.

Be careful when releasing the latch, it will snap back into place. Mind your fingers.

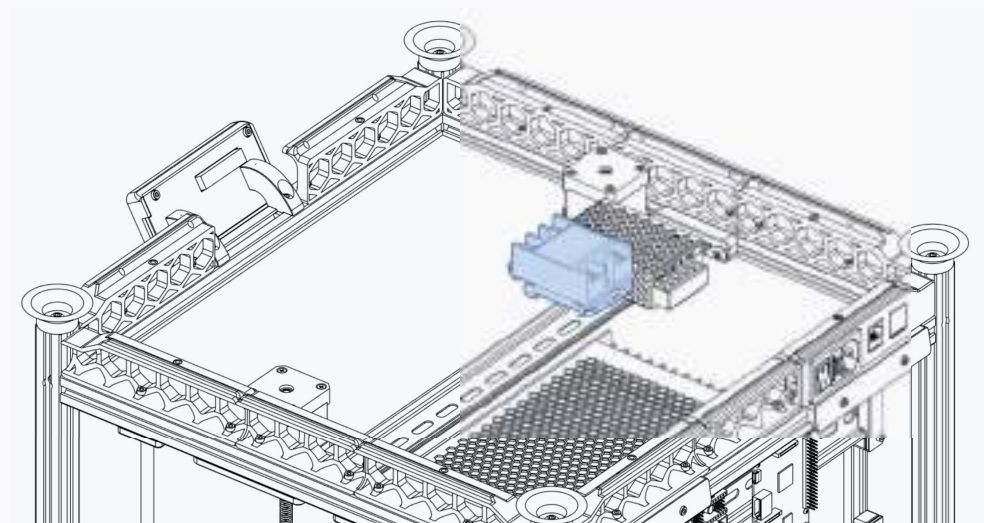
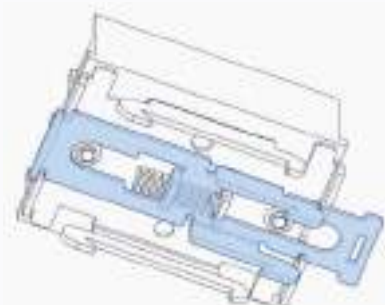

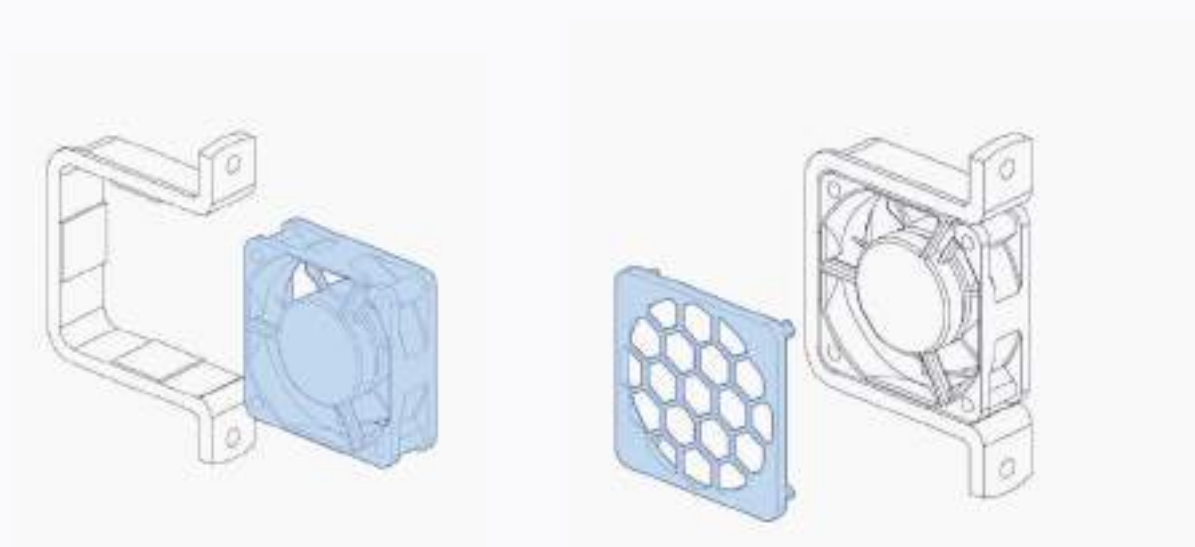
**APPLY VHB TAPE**

3M VHB tape is a double sided adhesive tape. Other vendors have similar products that you can use as a substitute.

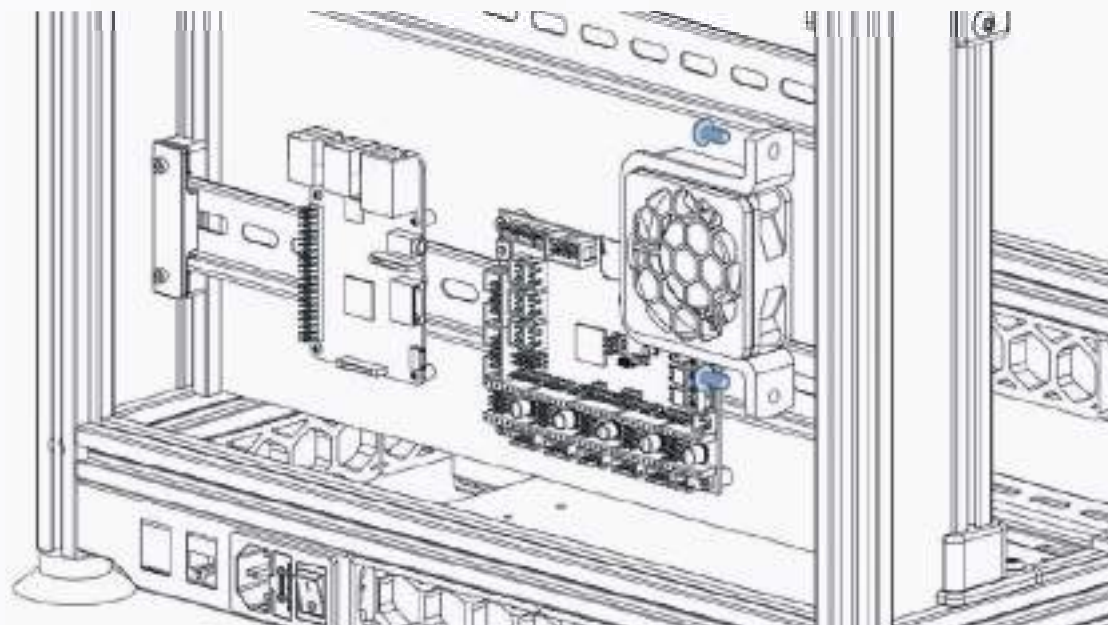

This page intentionally left blank.



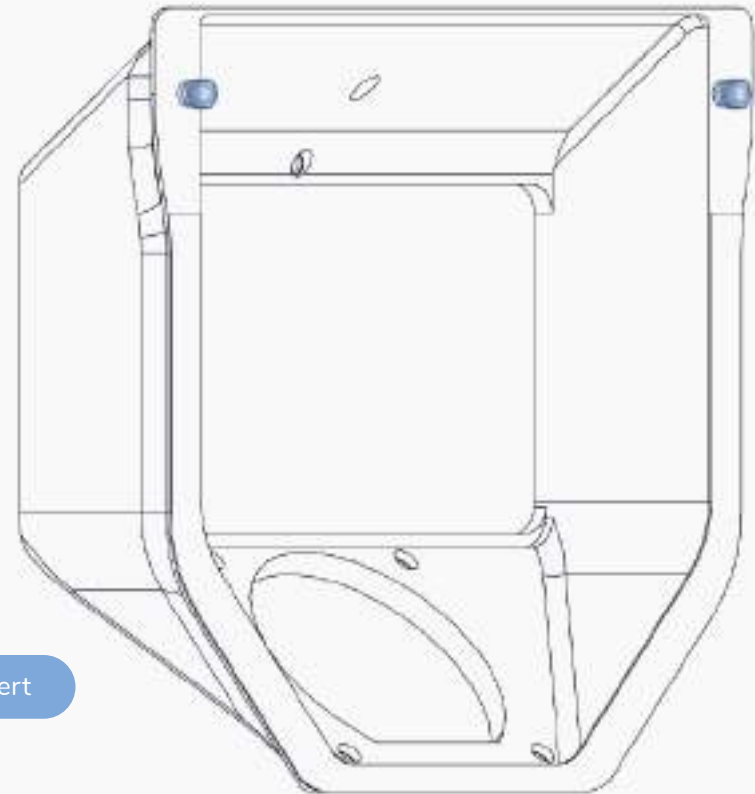
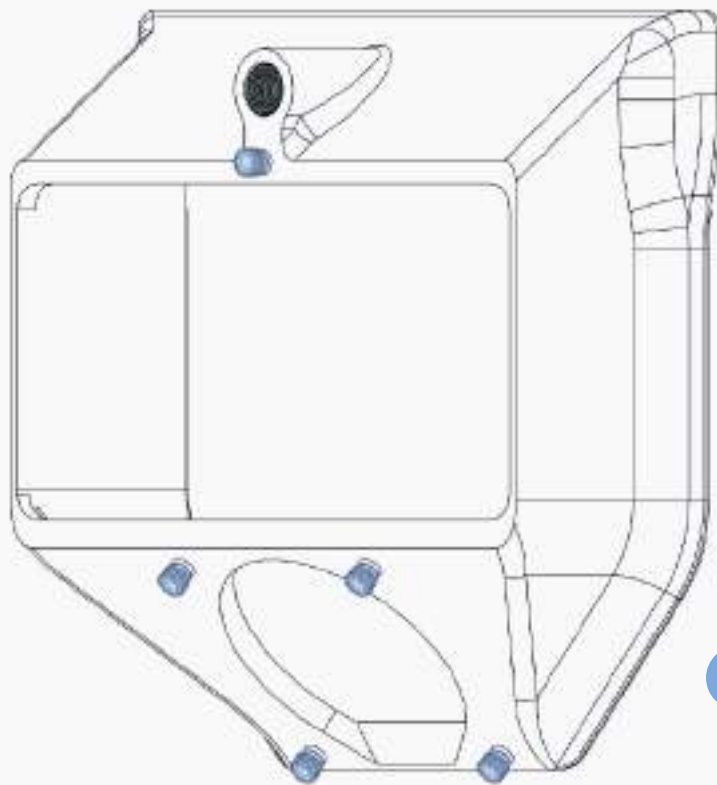

Heat Set Insert

**BSPP ADAPTER**

Some adapters have a small lip that prevents the PTFE tube from passing through.

Inspect the adapter and if necessary use a drill to carefully remove the lip.

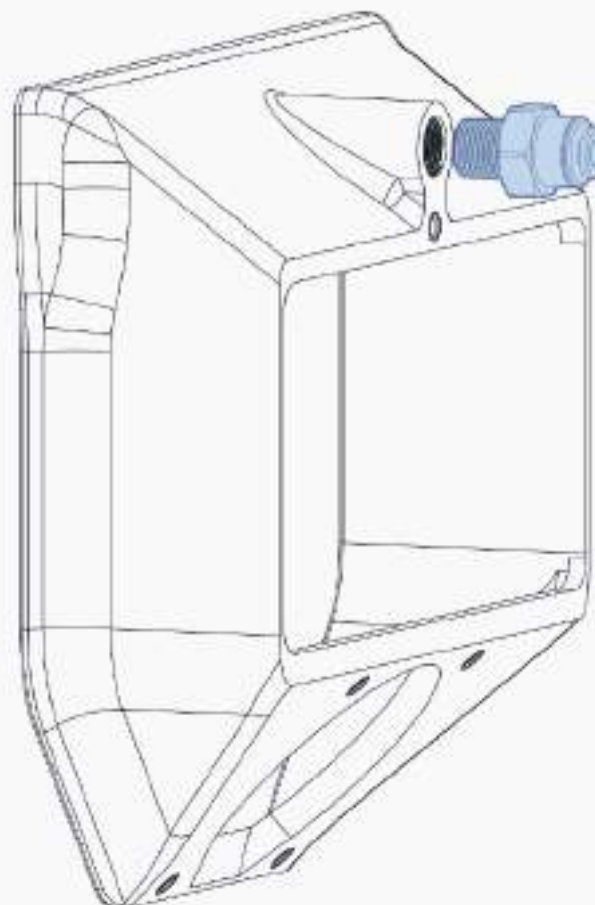



## EXHAUST

WWW.VORONDESIGN.COM

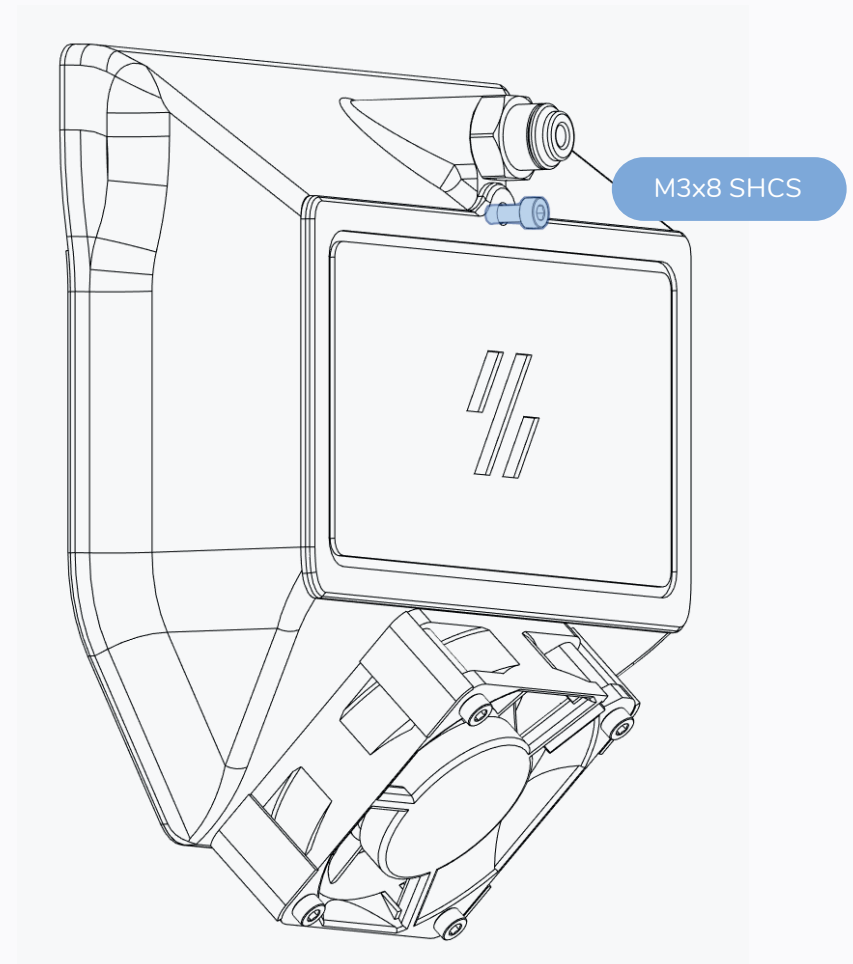
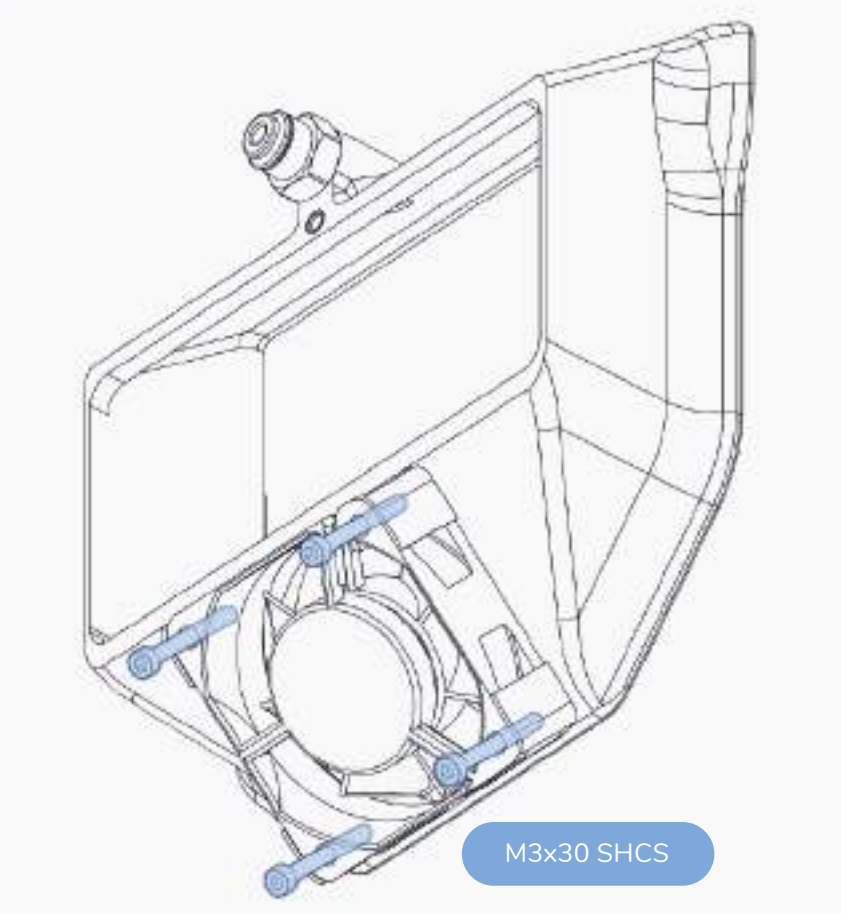

**APPLY VHB TAPE**

VHB Tape is a double sided adhesive tape.

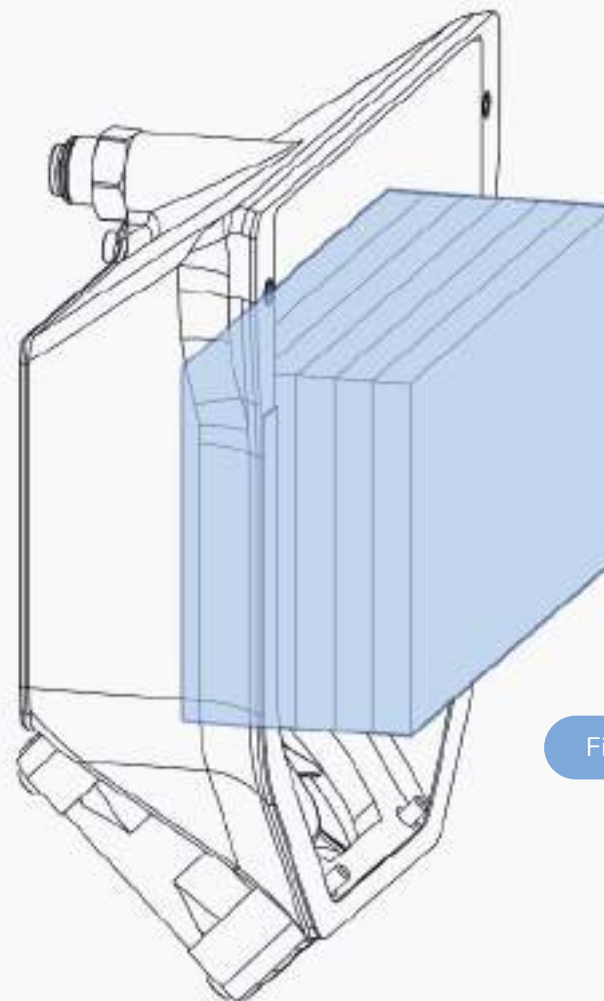
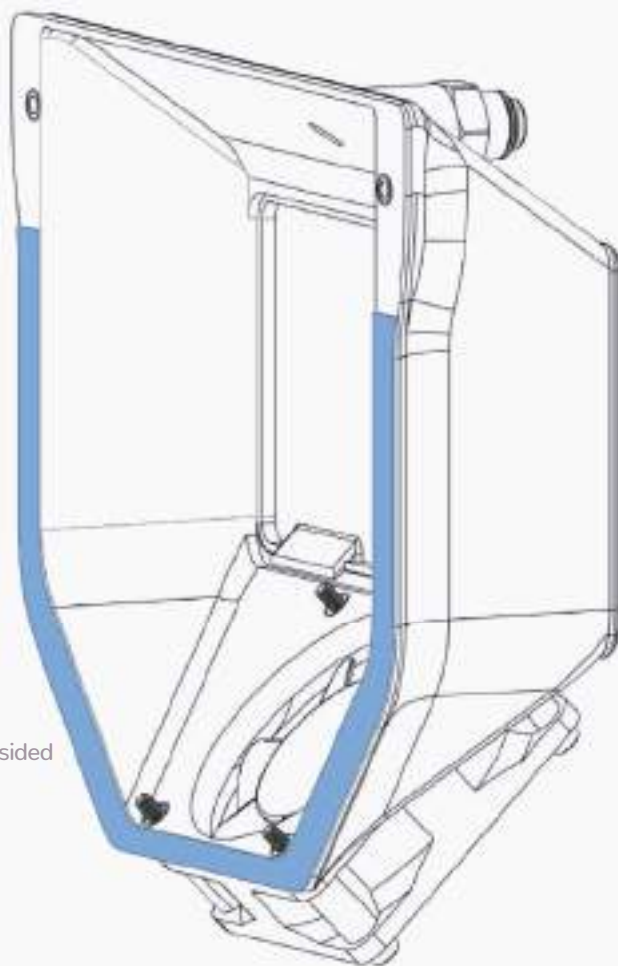

Filter Material

## REAR PANEL

WWW.VORONDESIGN.COM

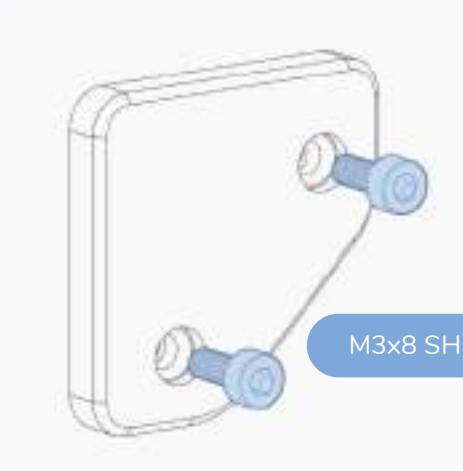

M3x8 SHCS

### HAMMERHEAD NUTS?

A drop of thread locker will turn the hammerhead nuts into a 1/4 turn quick release for the panels. Best done once the assembly is finished.

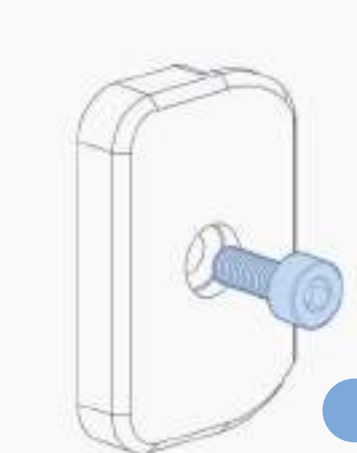

M3x8 SHCS

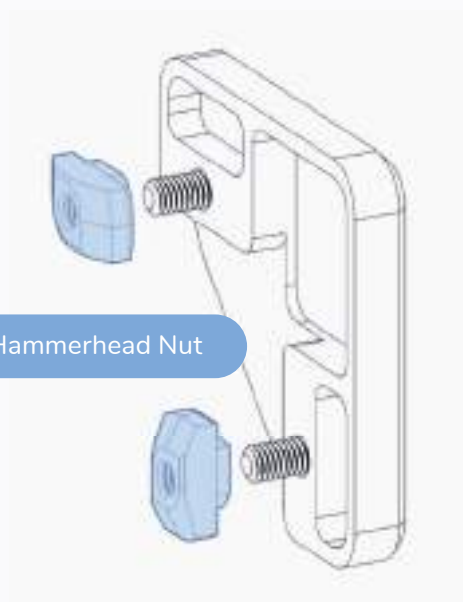

M3 Hammerhead Nut

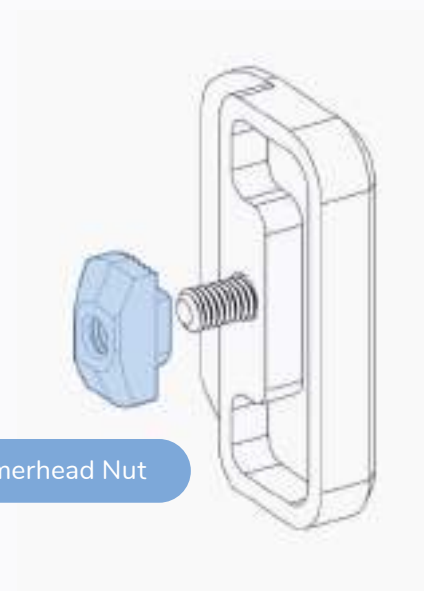

M3 Hammerhead Nut

## REAR PANEL

WWW.VORONDESIGN.COM

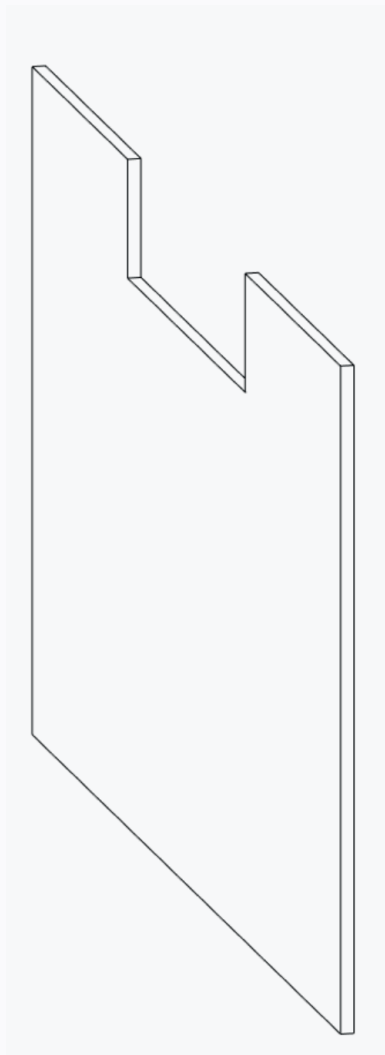

### APPLY FOAM TAPE

Use foam tape on the contact areas between the panels and the frame to mitigate noise from vibrations.

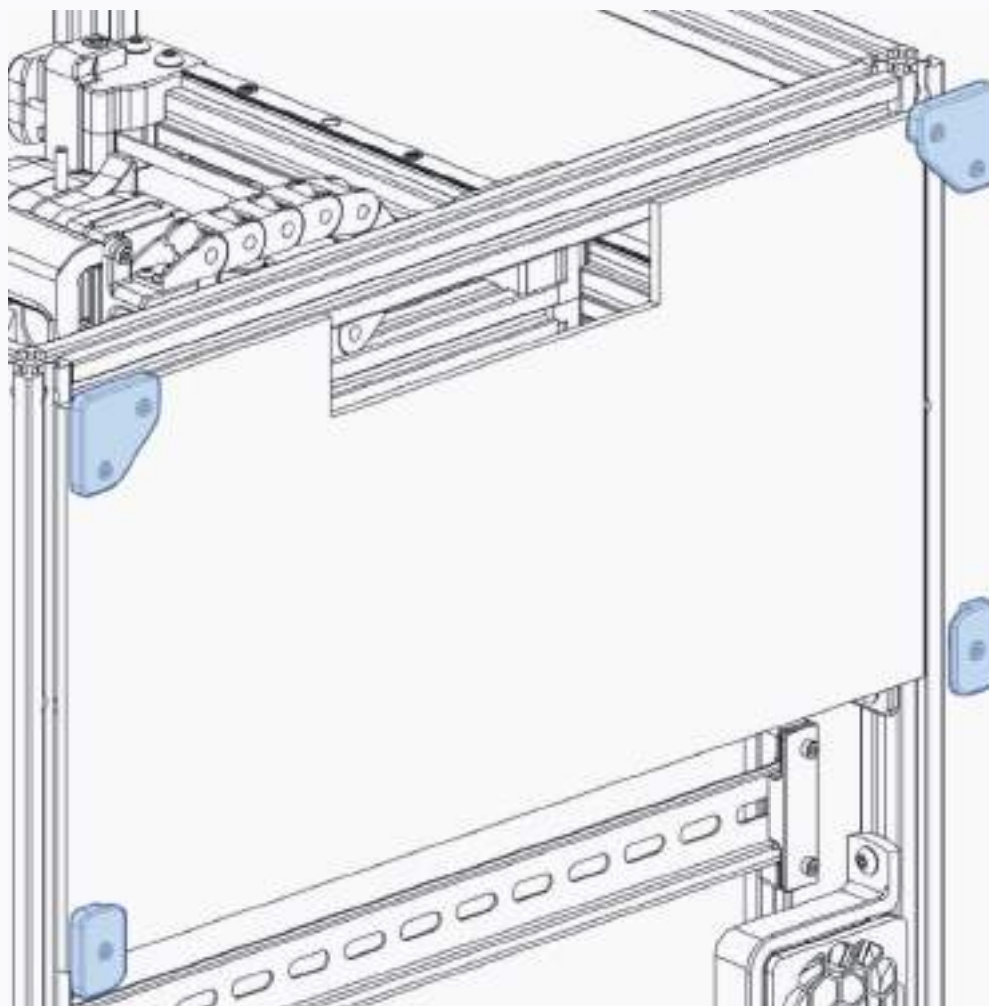

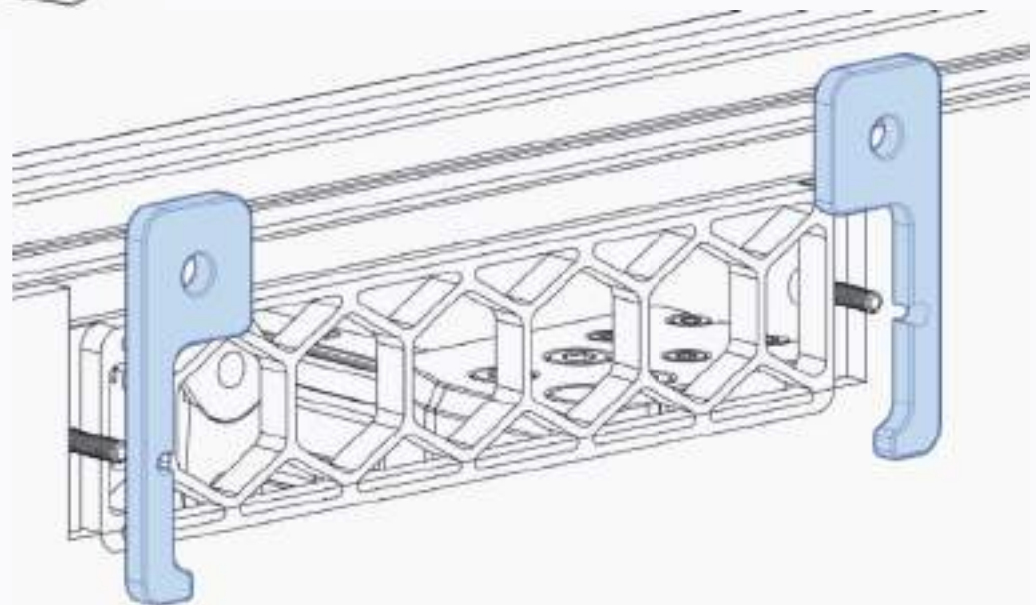
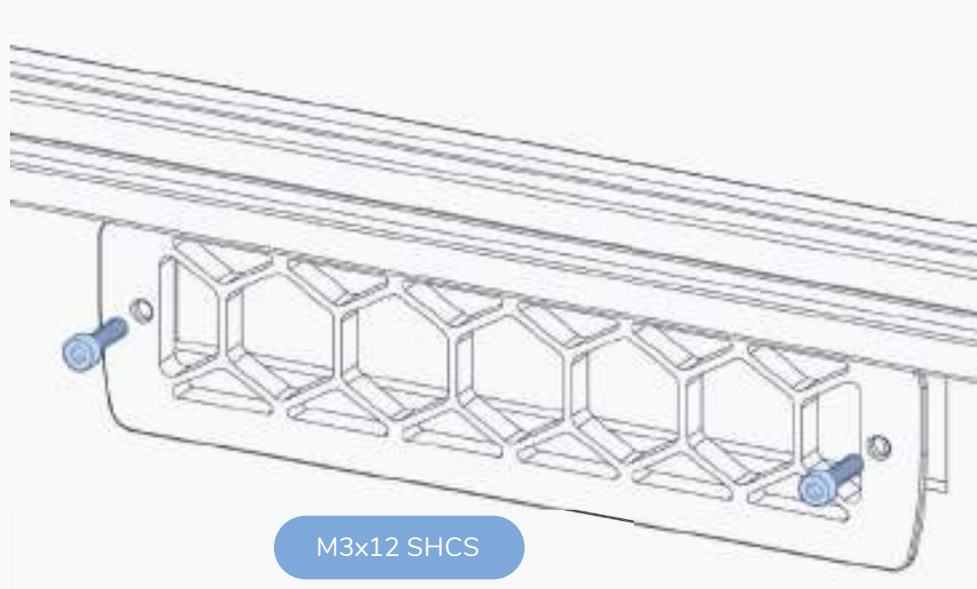

## REAR PANEL

WWW.VORONDESIGN.COM

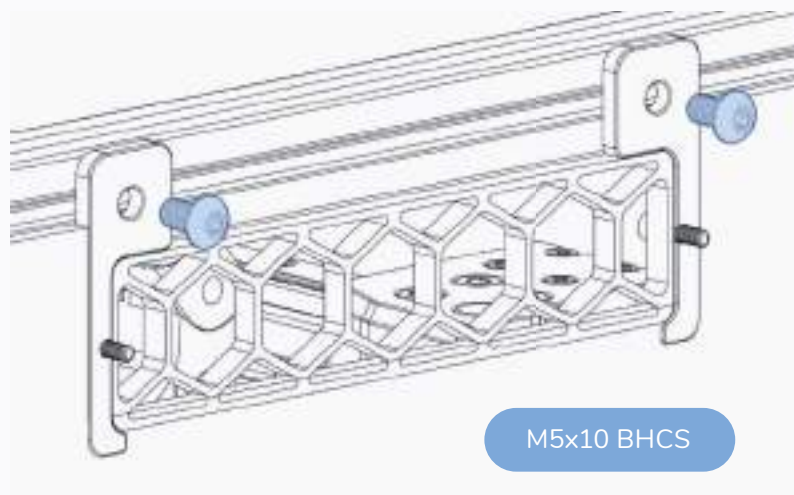

REMOVE TAPE BACKING

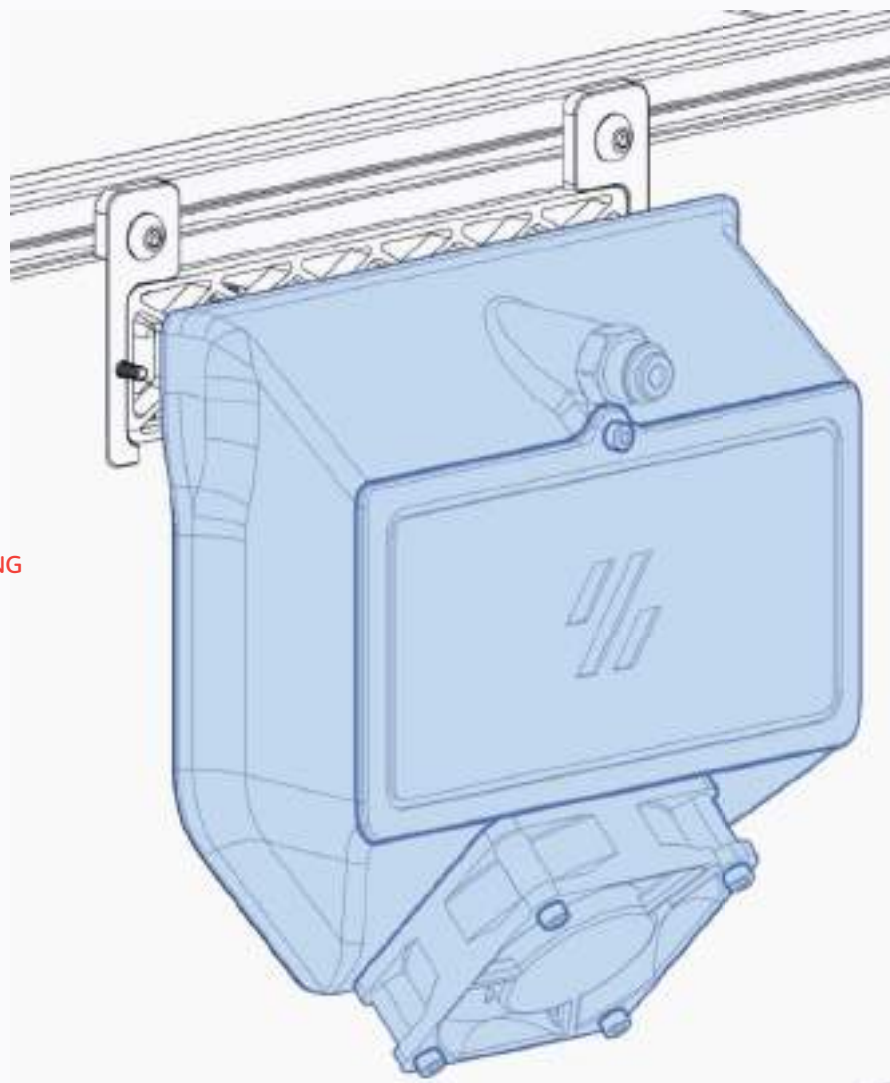



This page intentionally left blank.





## PANEL MOUNTS

WWW.VORONDESIGN.COM

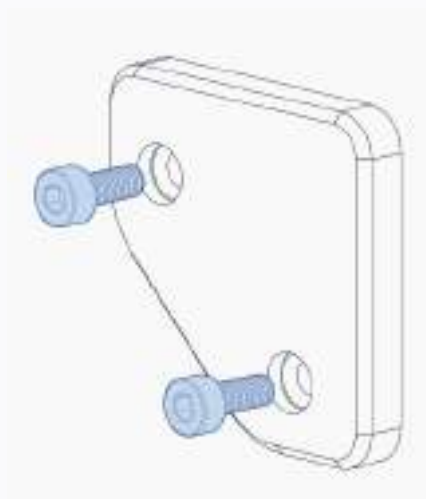

M3x8 SHCS

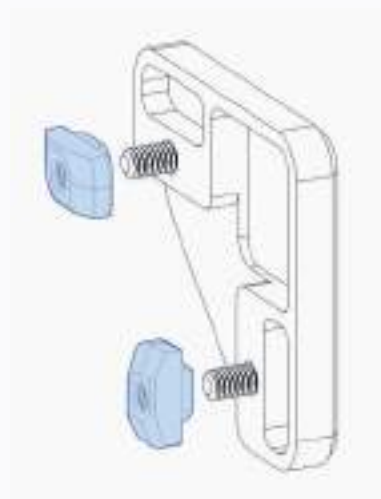

M3 Hammerhead Nut

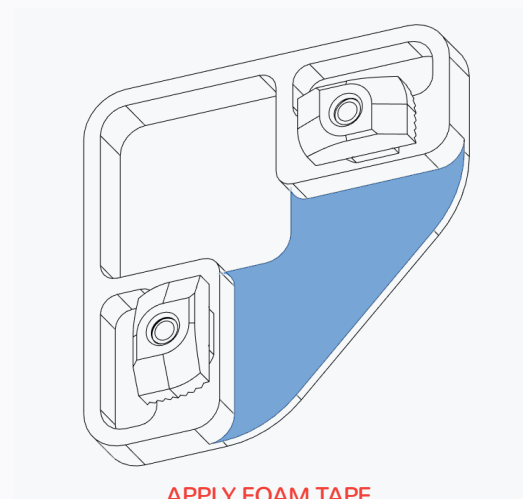

### APPLY FOAM TAPE

Use foam tape on the highlighted areas to mitigate noise from vibrations.

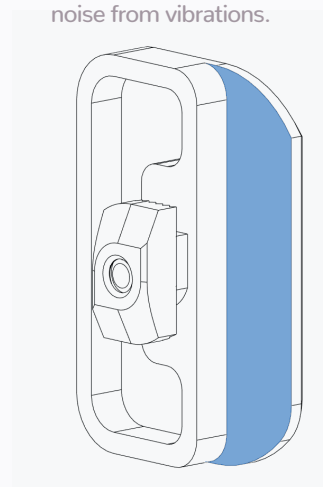
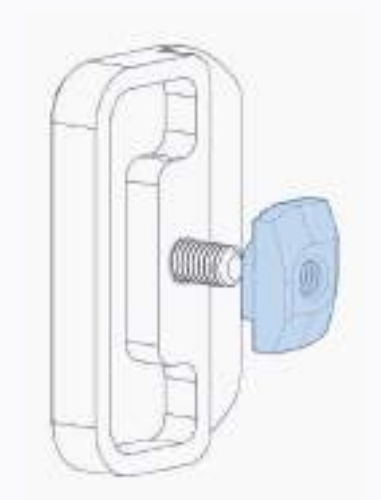
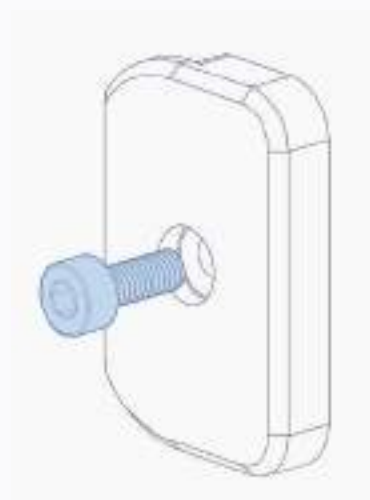

## TOP PANEL

[WWW.VORONDESIGN.COM](http://WWW.VORONDESIGN.COM)

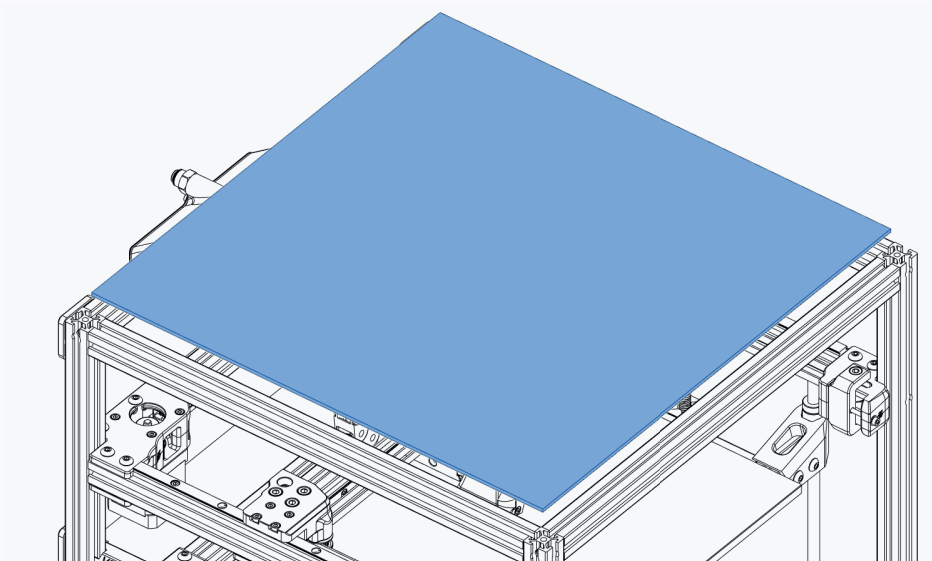

### APPLY FOAM TAPE

Use foam tape on the contact areas between the panels and the frame to mitigate noise from vibrations.

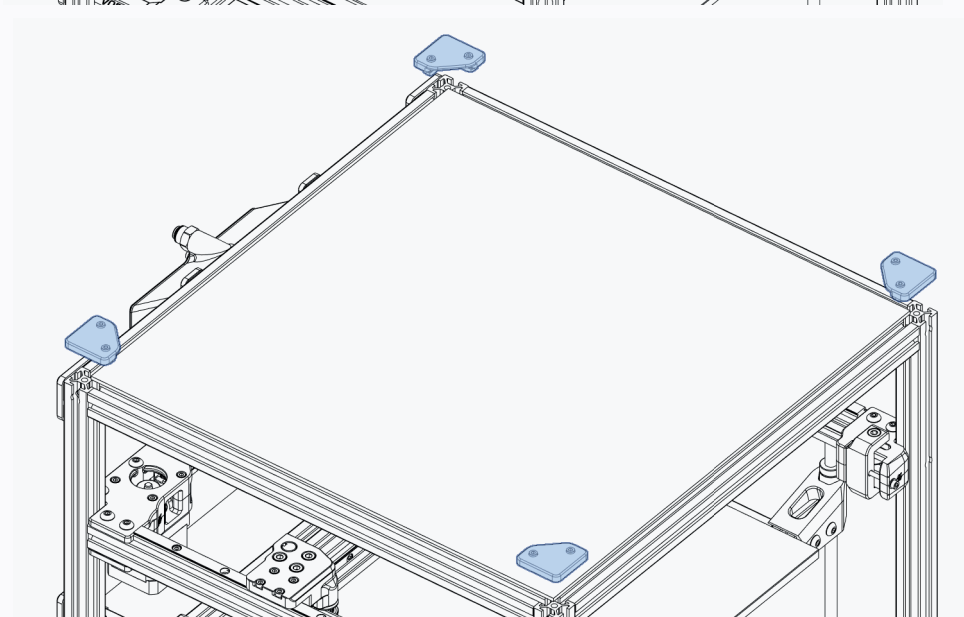

## SIDE PANEL

WWW.VORONDESIGN.COM

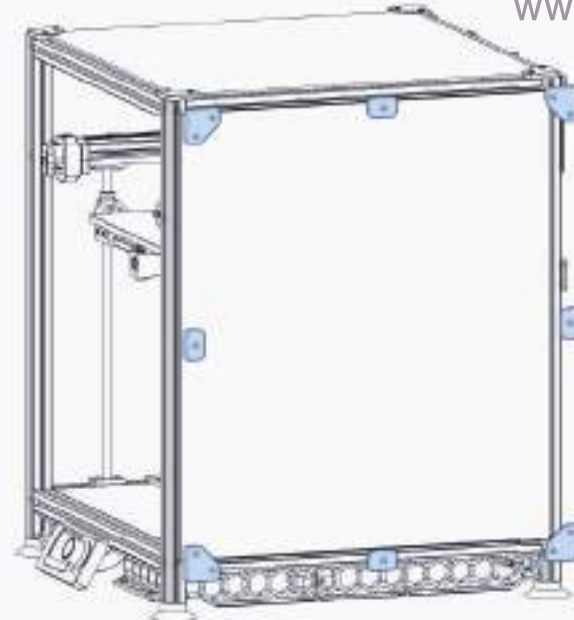
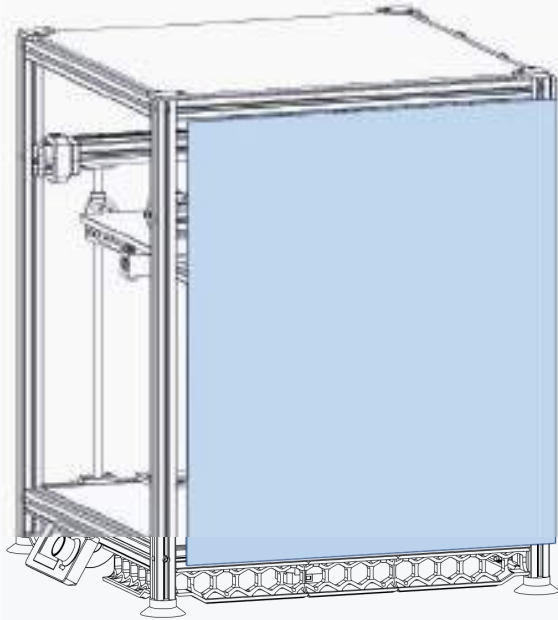

### APPLY FOAM TAPE

Use foam tape on the contact areas between the panels and the frame to mitigate noise from vibrations.

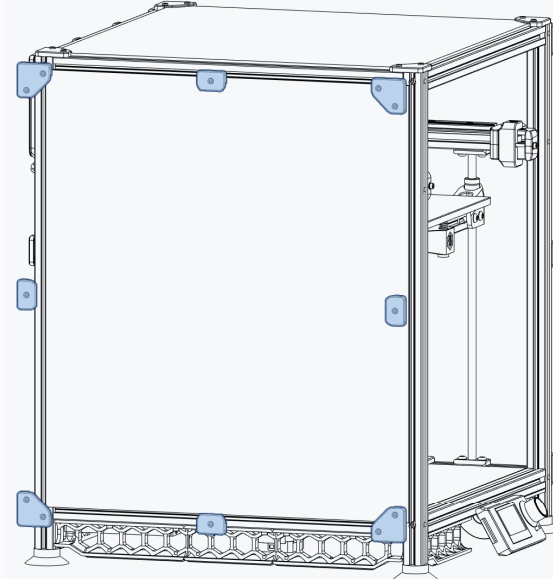
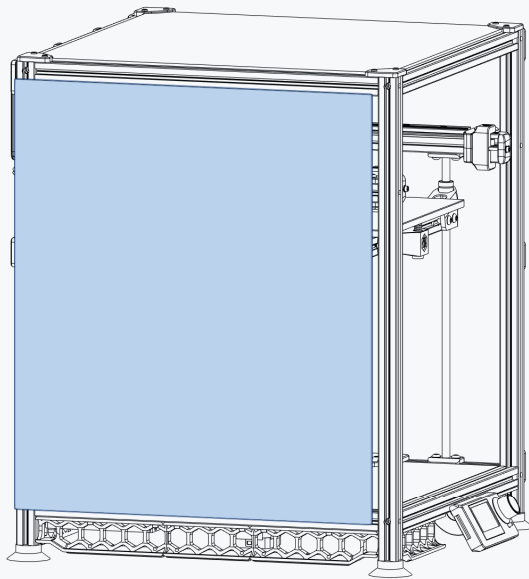

## FRONT PANEL

WWW.VORONDESIGN.COM

### GLUE INTO PLACE

Use a fast acting glue like super-glue.

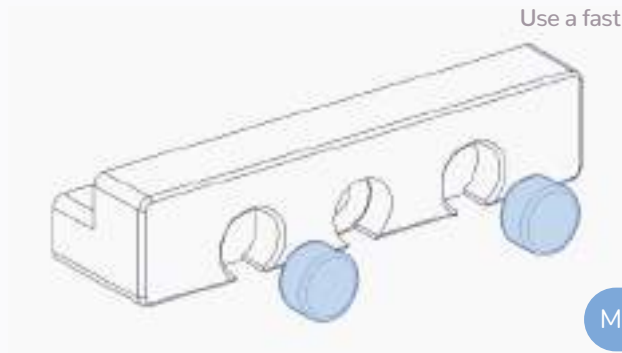

Magnets

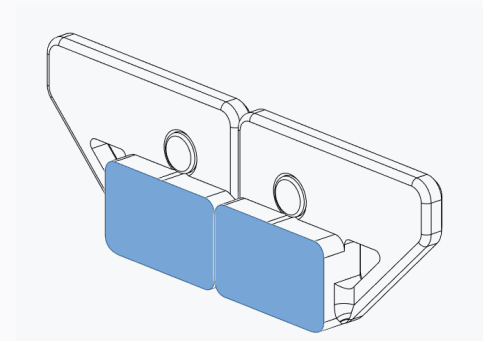
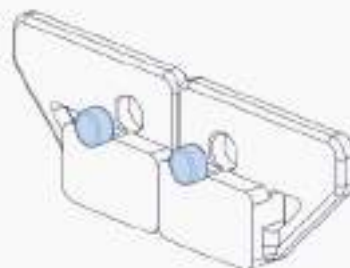

### APPLY VHB TAPE

The parts will be bonded to the panels using double-sided adhesive tape.

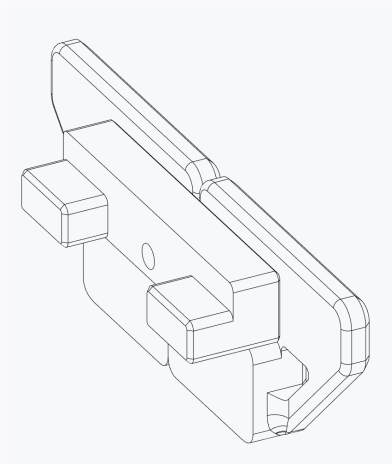

### MIND THE MAGNET POLARITY

Ensure that the magnets are facing in the right direction prior to glueing them into place.

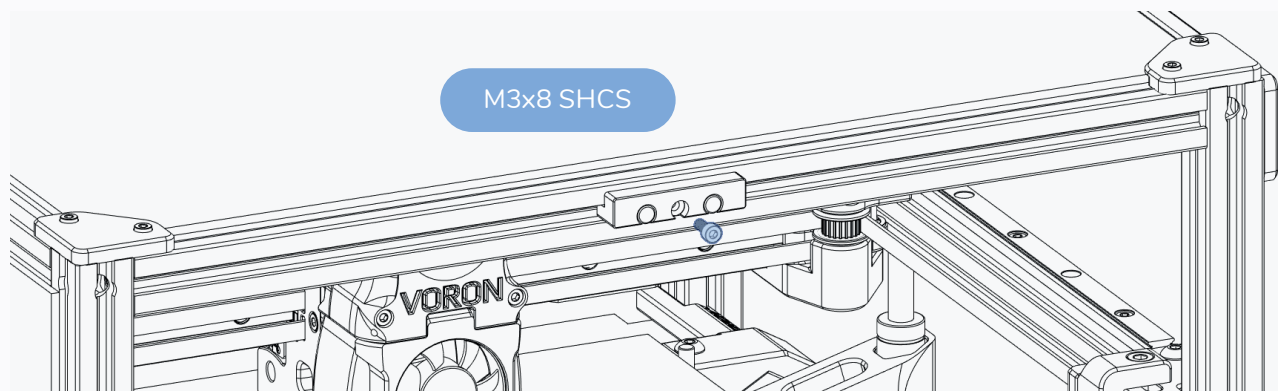

M3x8 SHCS

## FRONT PANEL

WWW.VORONDESIGN.COM

### GLUE INTO PLACE

Use a fast acting glue like super-glue.

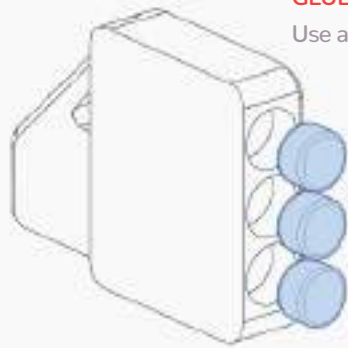

Magnets

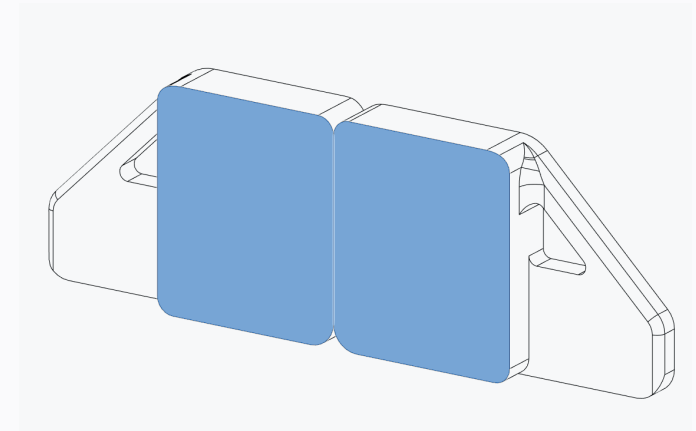
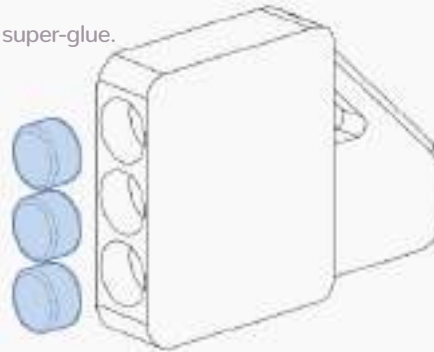

### MIND THE MAGNET POLARITY

Ensure that the magnets are facing in the right direction prior to gluing them into place.



M3x8 SHCS

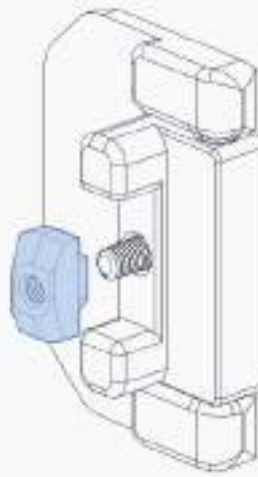

M3 Hammerhead Nut

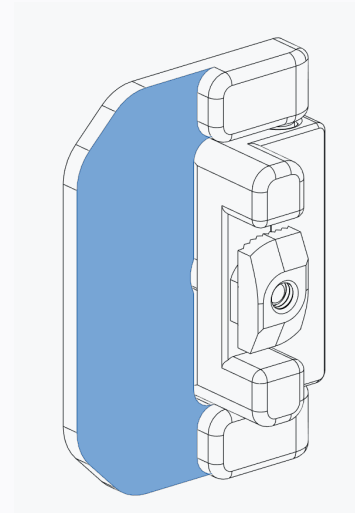

### APPLY VHB TAPE

The parts will be bonded to the panels using double-sided adhesive tape.

## FRONT PANEL

WWW.VORONDESIGN.COM

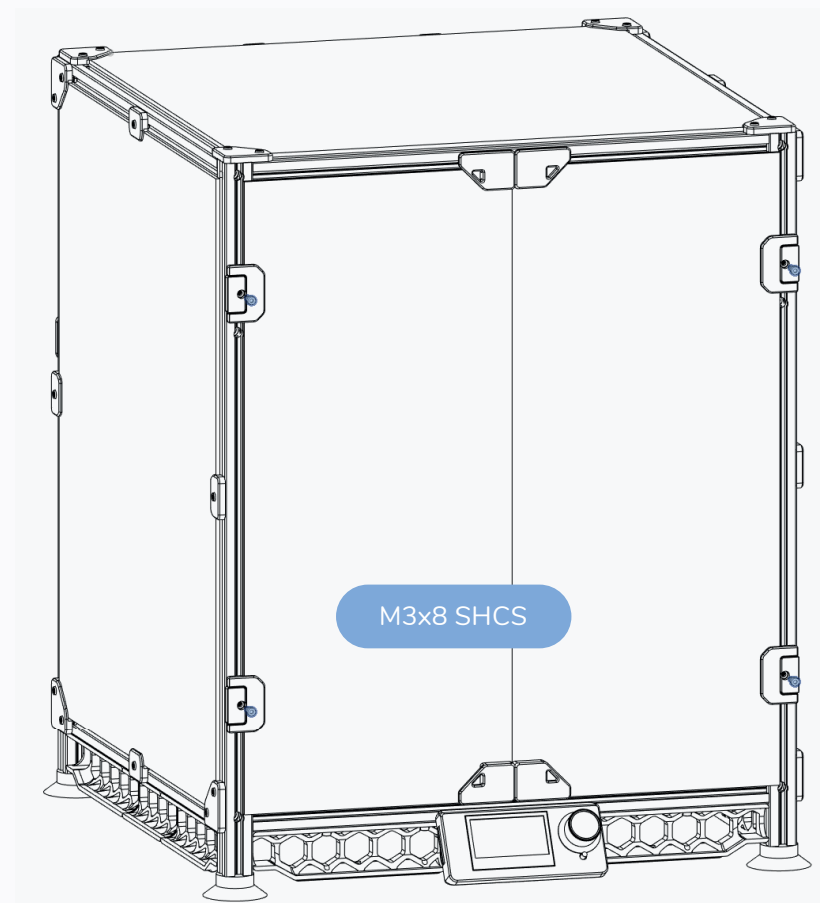
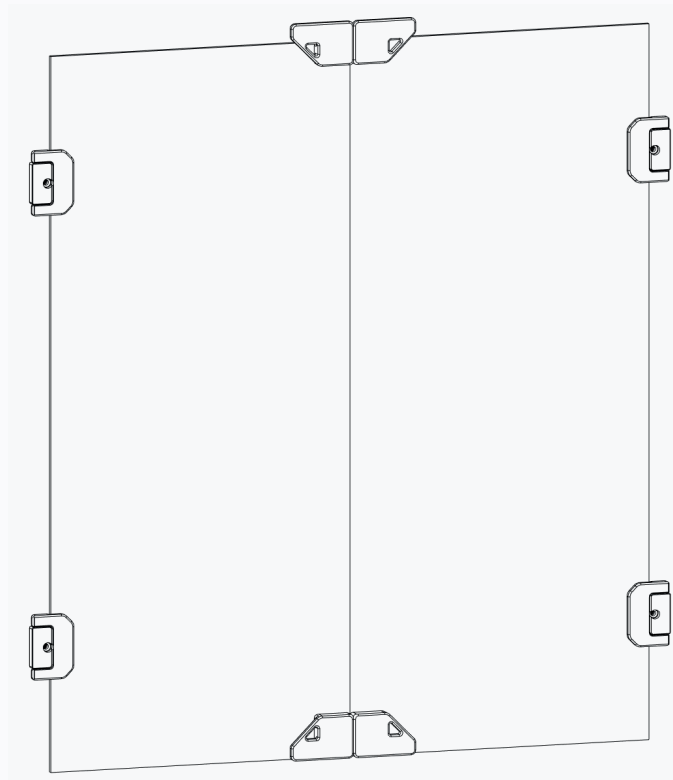



## ELECTRONICS PANEL

WWW.VORONDESIGN.COM

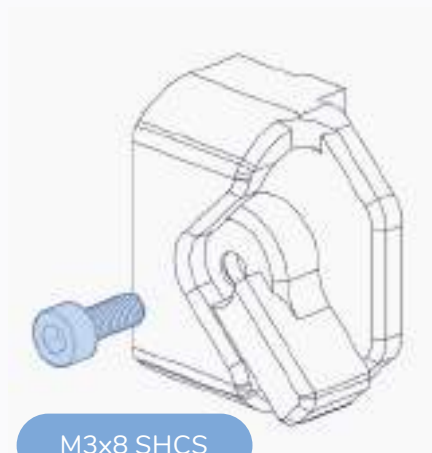
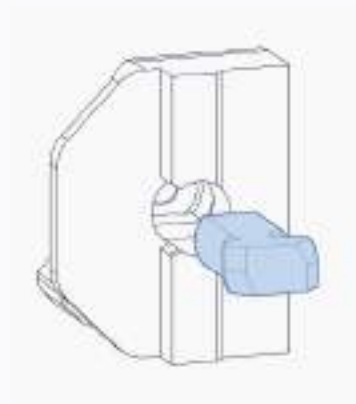

M3x8 SHCS

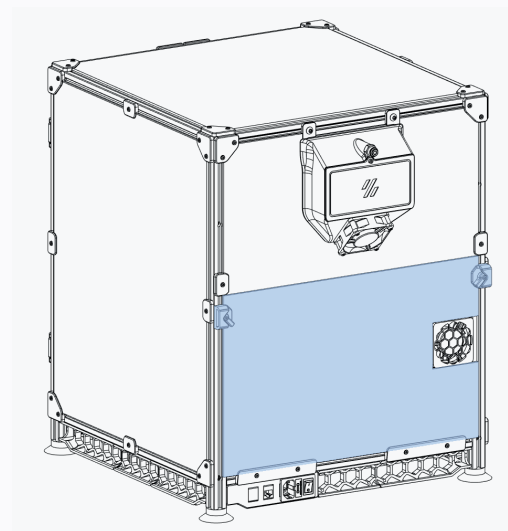
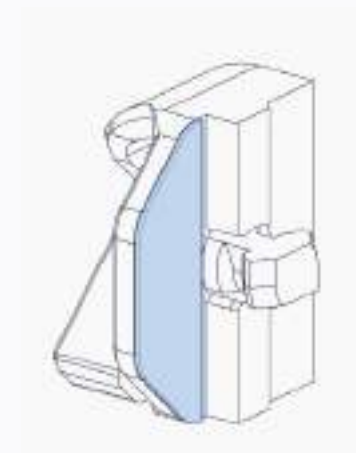

### ROTATE LEVERS TO LOCK

Use the levers to lock and unlock the panel for the electronics

## BOTTOM PANEL

[WWW.VORONDESIGN.COM](http://WWW.VORONDESIGN.COM)

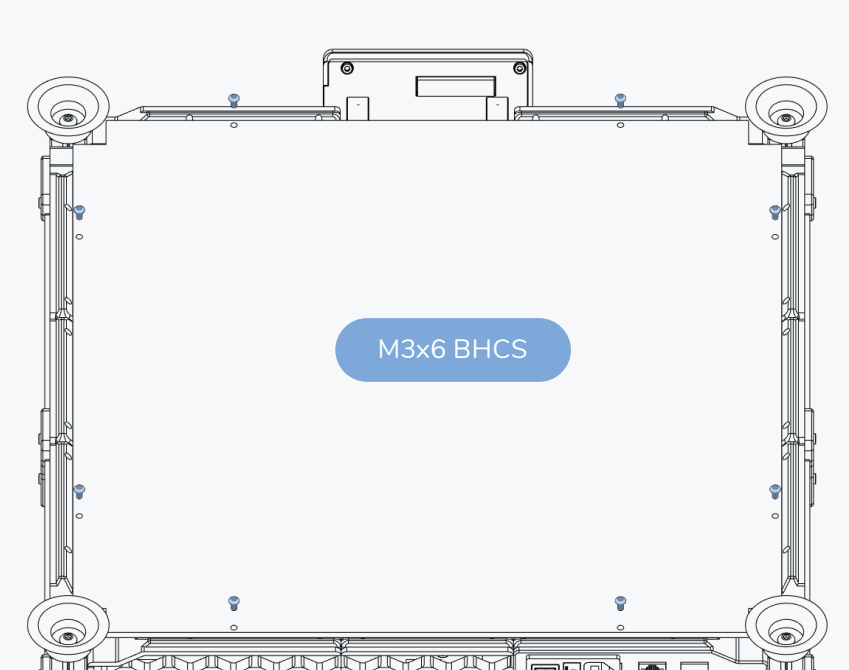
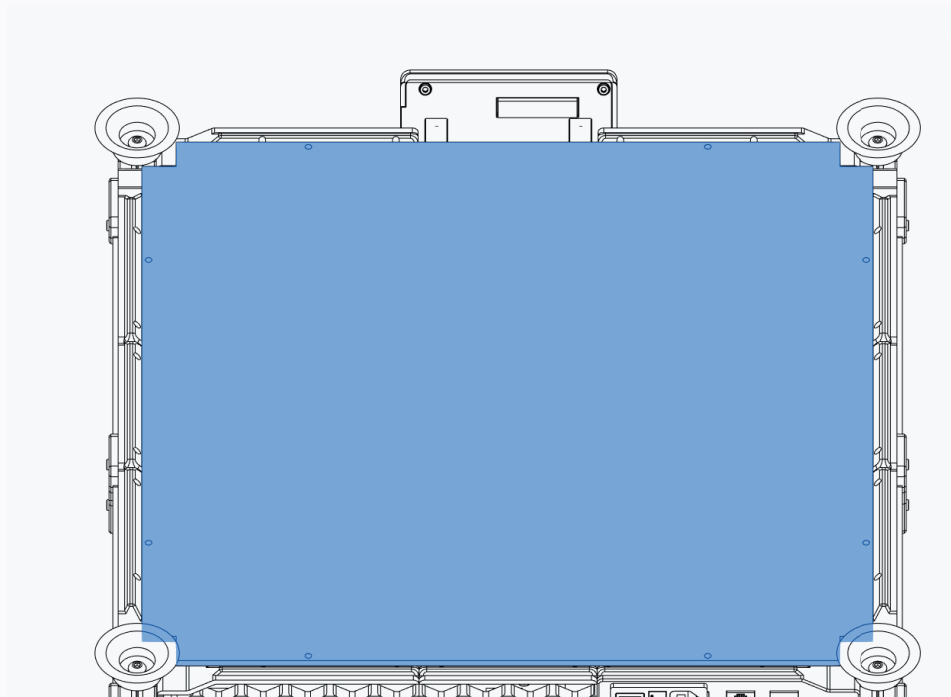

This page intentionally left blank.



## SPOOL HOLDER

WWW.VORONDESIGN.COM

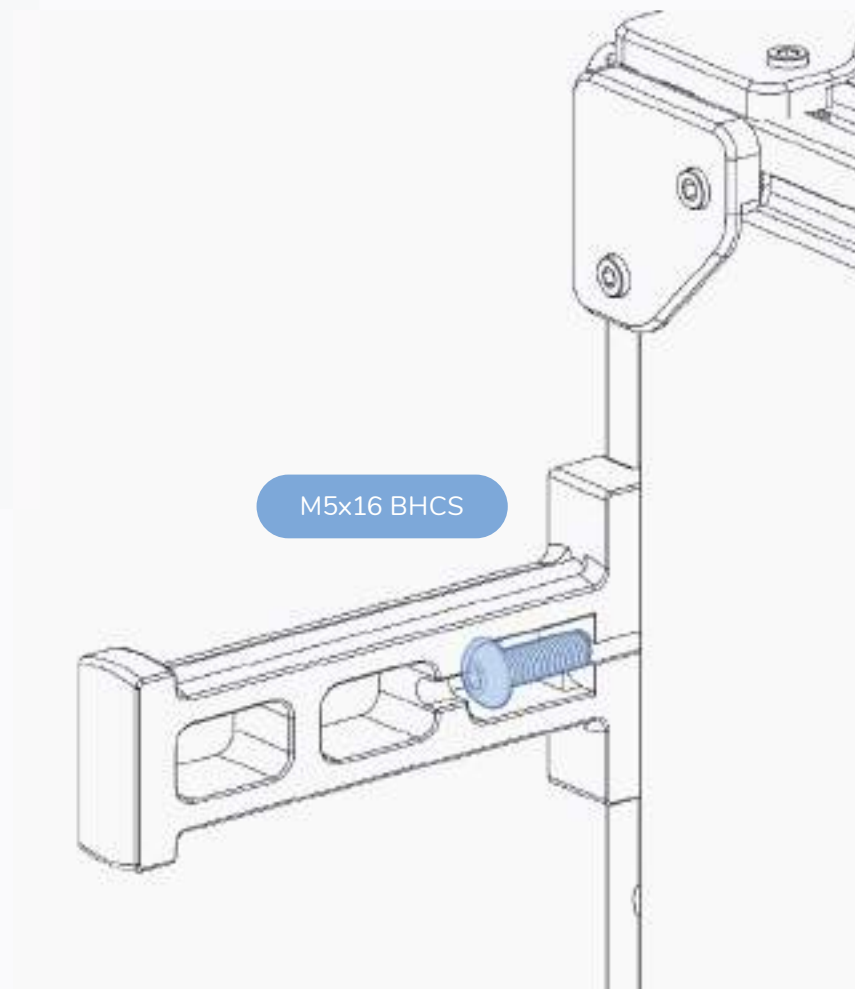
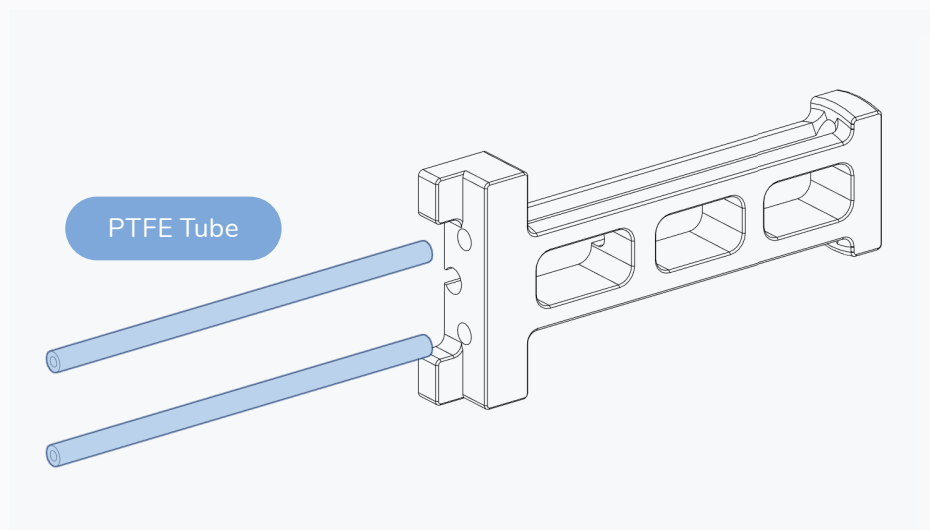

## BOWDEN HOLDER & XY CAPS

WWW.VORONDESIGN.COM

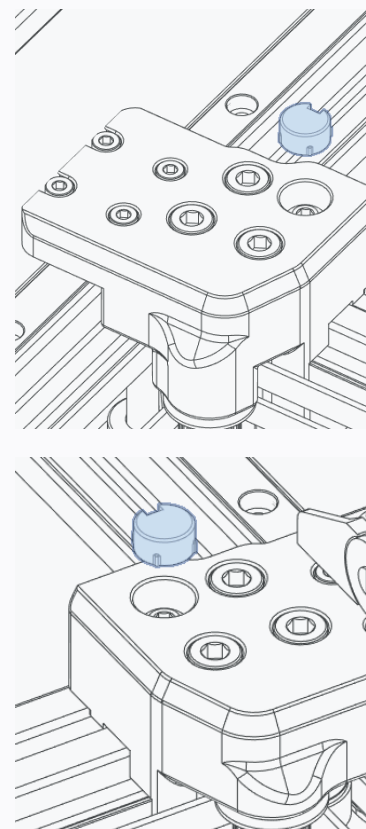
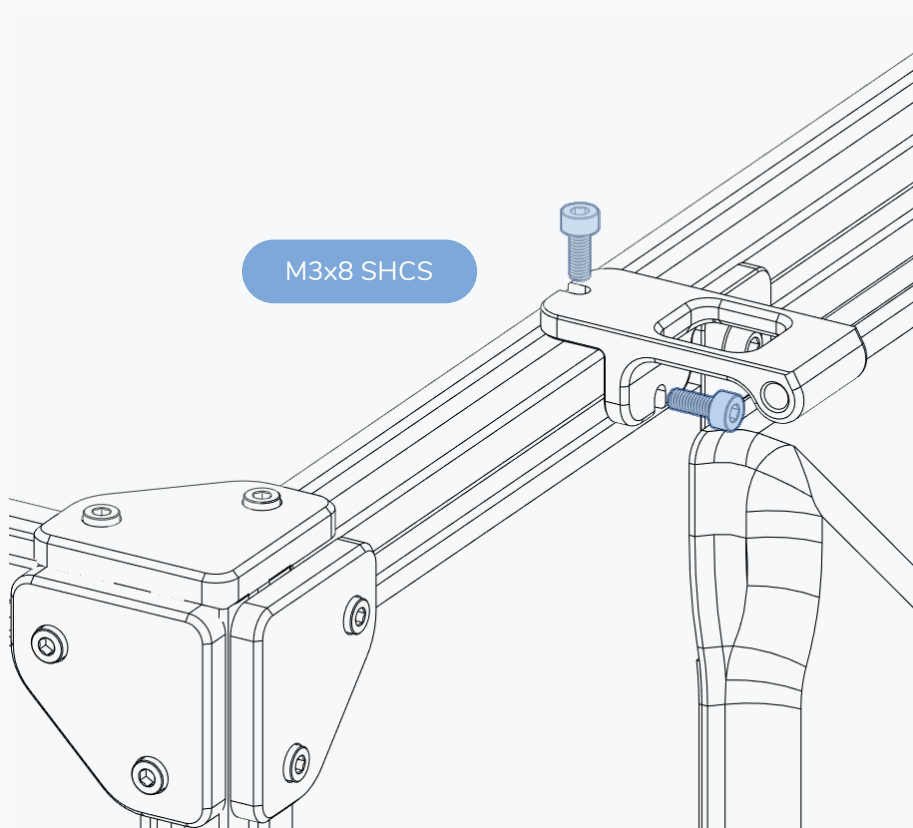

This page intentionally left blank.



### MECHANICAL ASSEMBLY COMPLETED ... NEXT STEP WIRING & ELECTRICAL

This manual is designed to be a simple reference manual for the build process. Wiring and the initial setup of your printer is not included.

For details on wiring, setup of the electronics and other initial steps of your new printer please visit our documentation available on github.



<https://github.com/vorondesign/voron-1>

### HOW TO GET HELP

If you need assistance with your build, we're here to help. Head on over to our Discord group and post your questions. This is our primary medium to help VORON Users and we have a great community that can help you out if you get stuck.



<https://discord.gg/voron>





---

**Website**  
[www.vorondesign.com](http://www.vorondesign.com)

**Github**  
<https://github.com/vorondesign>

**Discord**  
<https://discord.gg/voron>



[www.copymaster3d.com](http://www.copymaster3d.com)  
[sales@copymaster3d.com](mailto:sales@copymaster3d.com)

