



# PHS



**Powder Handling  
Station**



# SINTERIT SOLUTION ON THE NEXT LEVEL



\* PHS is compatible also with Lisa

# **| New quality of powder handling**

Supporting device designed to make post-processing and powder recovery as clean as possible:

- **All processes in one place**
- **Clever workspace** - an ergonomic and user friendly solution
- **Tools close to you** - everything you need is always at hand
- **Easy depowdering** in 5 simple steps
- Super hero - **not just for one printer!**
- **PHS in data** - technical details



# **| All processes in one place**

Post-processing  
and powder  
recovery - all  
processes  
in one!

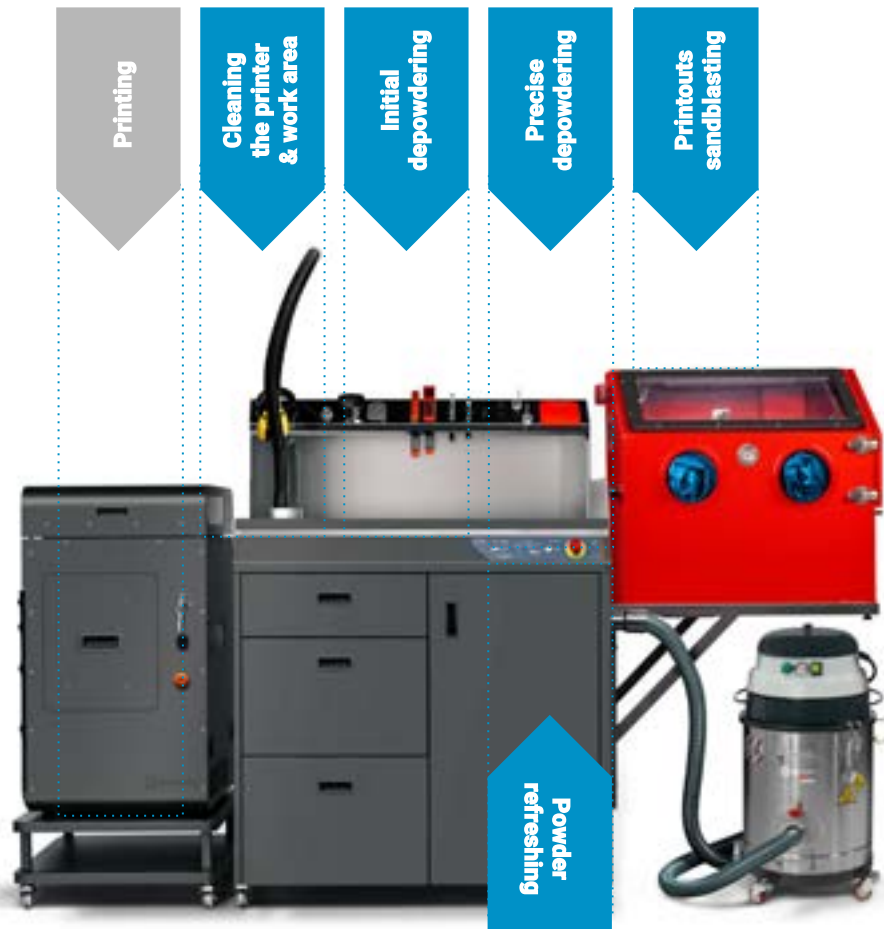

# **| Clever workspace**

Designed to be useful

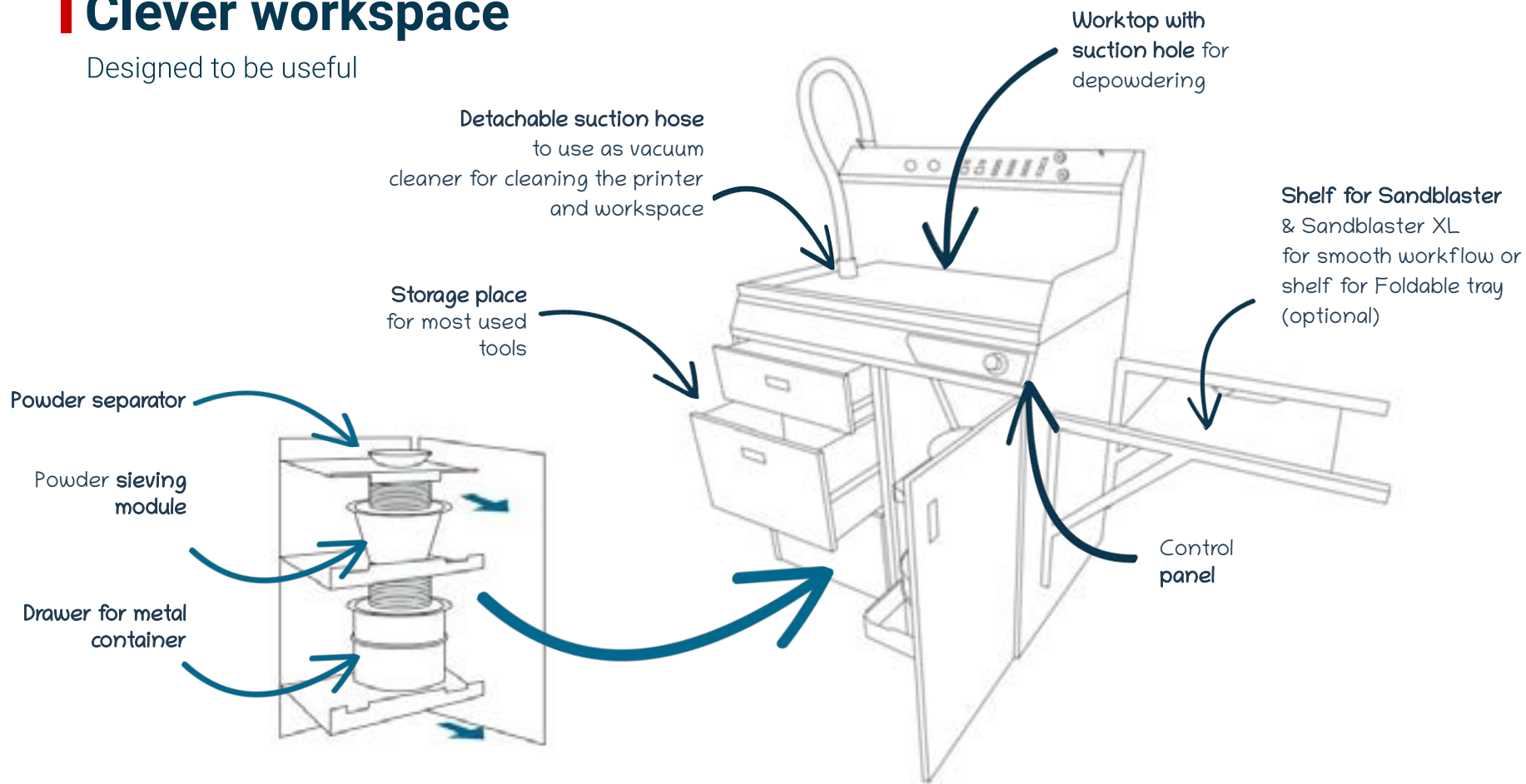

# **| Tools close to you**

Everything you need is always at hand



Holes for  
**dedicated**  
suction hose  
nozzles

3 drawers:  
storage space for  
depowdering tools

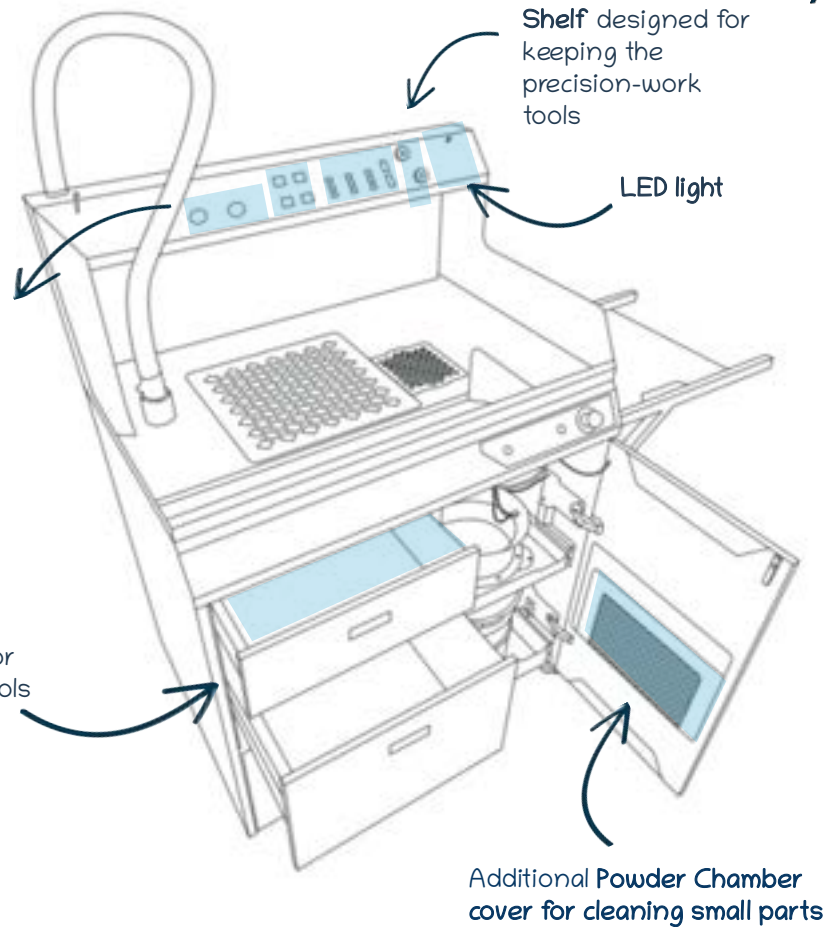



# **| Depowdering in 5 simple steps**

PHS makes post processing of printouts in 3D SLS technology  
**faster, ergonomic and user friendly experience**



**1** Initial post processing



**2** Precise depowdering



**3** Printouts sandblasting

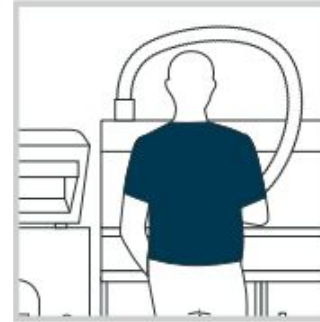

**4** Cleaning the printer & work area



**5** Powder refreshing



# 1 Initial post processing



Thanks to the Chamber cover with large holes located on the worktop, you can easily push the unsintered powder through, while pre-cleaning the print.

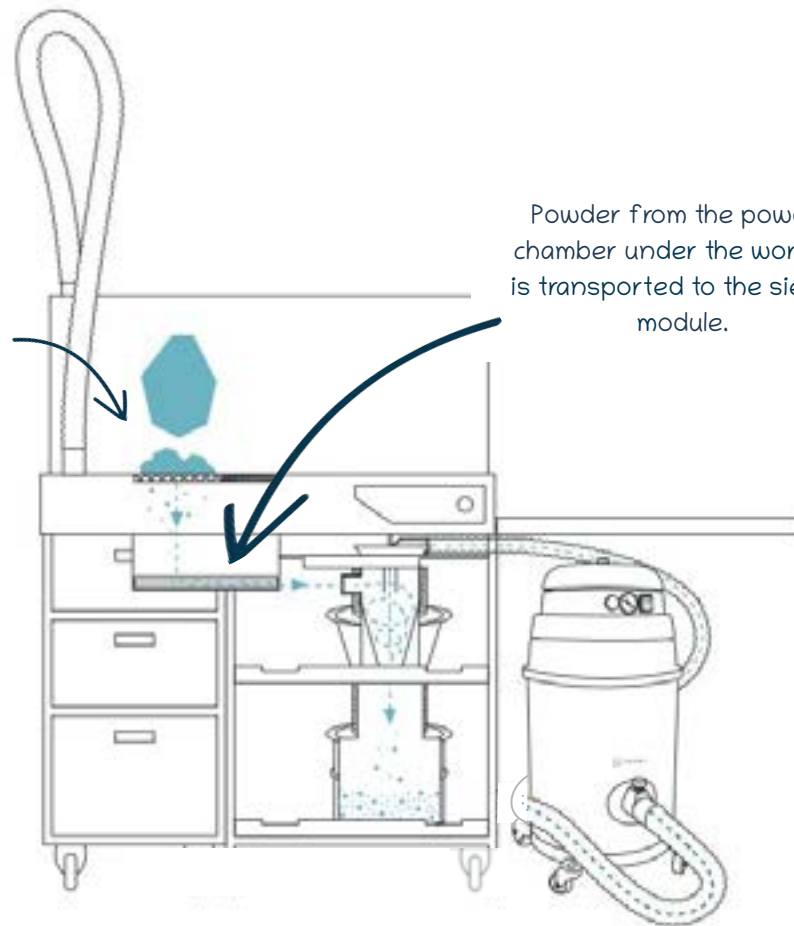

Powder from the powder chamber under the worktop is transported to the sieving module.





## 2 Precise depowdering

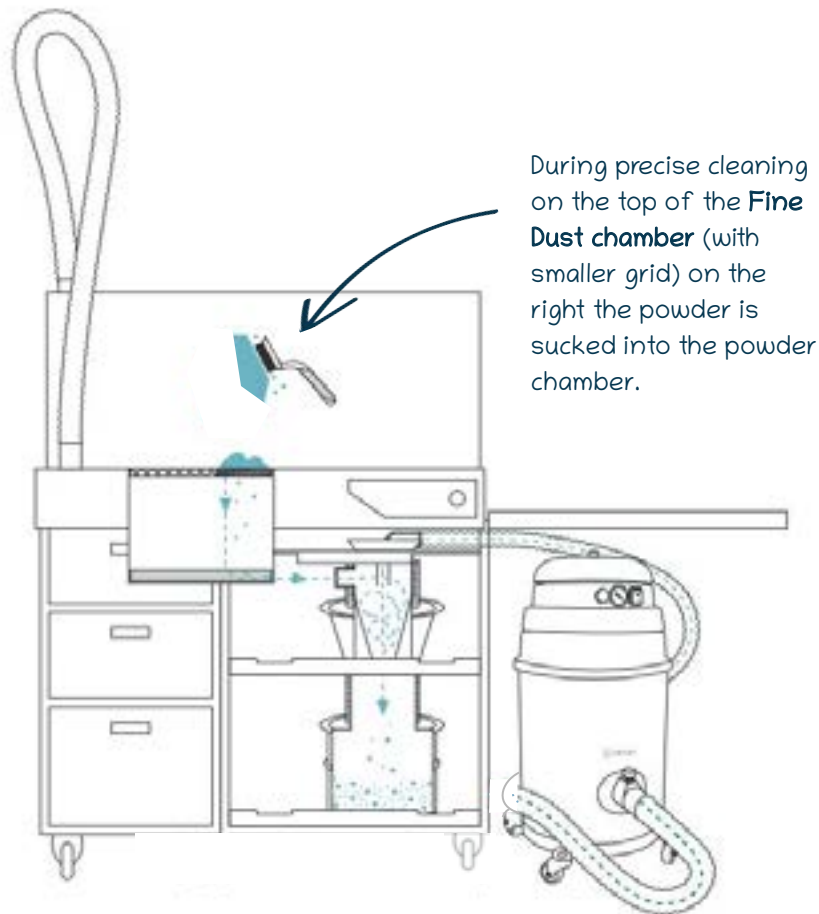

During precise cleaning on the top of the **Fine Dust chamber** (with smaller grid) on the right the powder is sucked into the powder chamber.



### 3 Printouts sandblasting

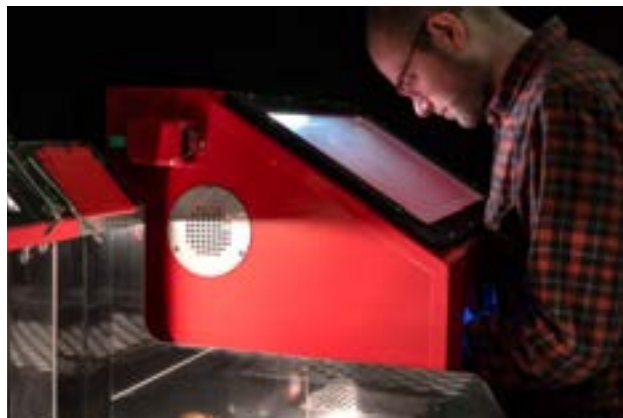

Metal shelf included in the set, allows you to place the **Foldable Tray** or **sandblaster** close to PHS workspace, shortening the working time and limiting the radius of powder distribution outside the station

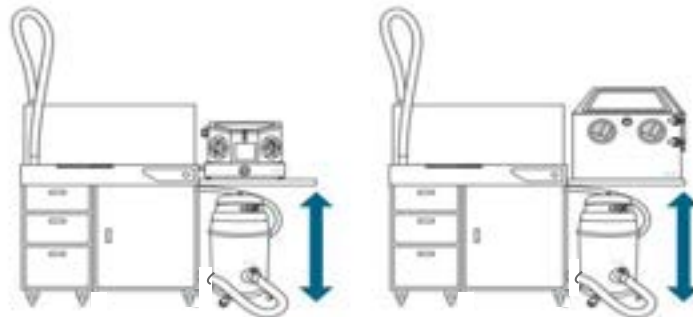

Two mounting heights.  
Dedicated for both Sandblaster and Sandblaster XL.

4

Cleaning  
the printer  
& work area

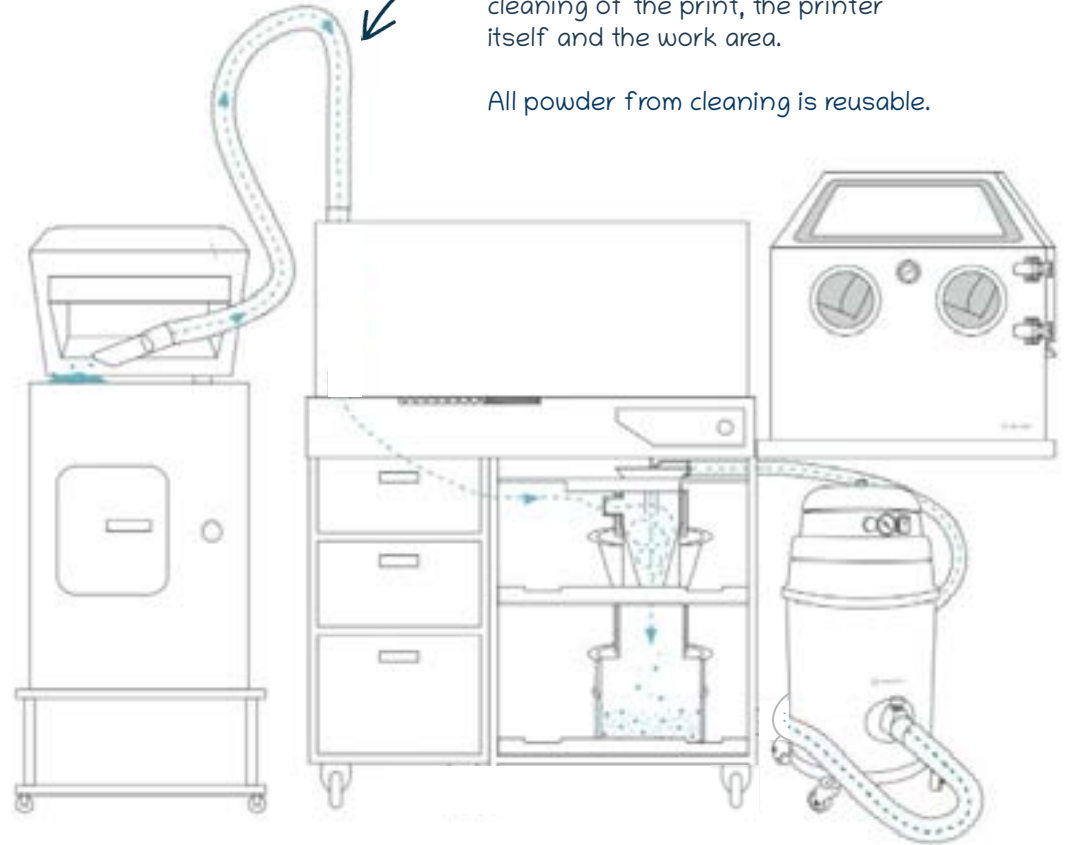

Flexible 2m suction hose reaches easily both the printer and the whole PHS workspace. It allows for initial cleaning of the print, the printer itself and the work area.

All powder from cleaning is reusable.



## 5 Powder refreshing



All the recovered powder is transferred to a sieving module and then goes into a metal container. Now it's ready to reuse

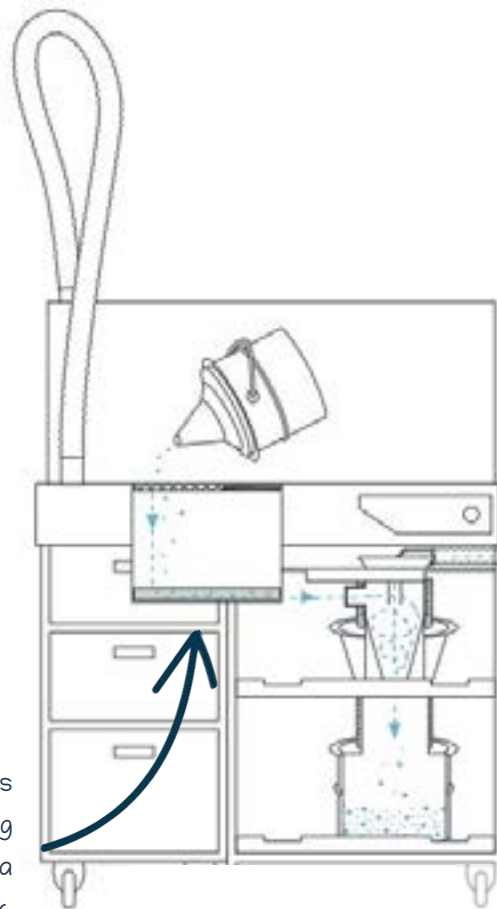

The sieving module located under the worktop sieves all the powder spilled during work and **make it ready for further process** - mixing the used powder with the fresh one

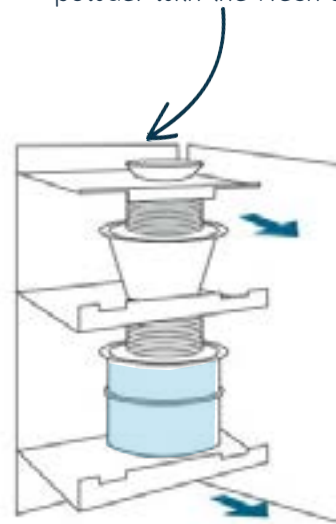



# **| Super hero - not just for one printer!**

Enough to support up to three printers

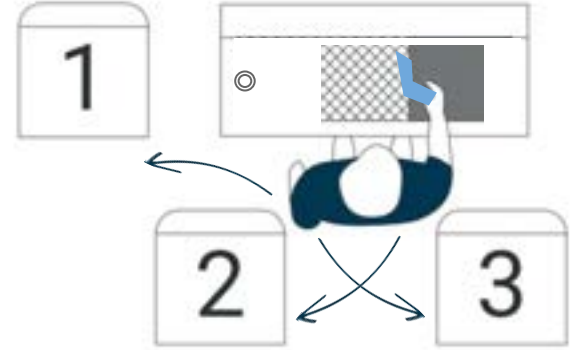
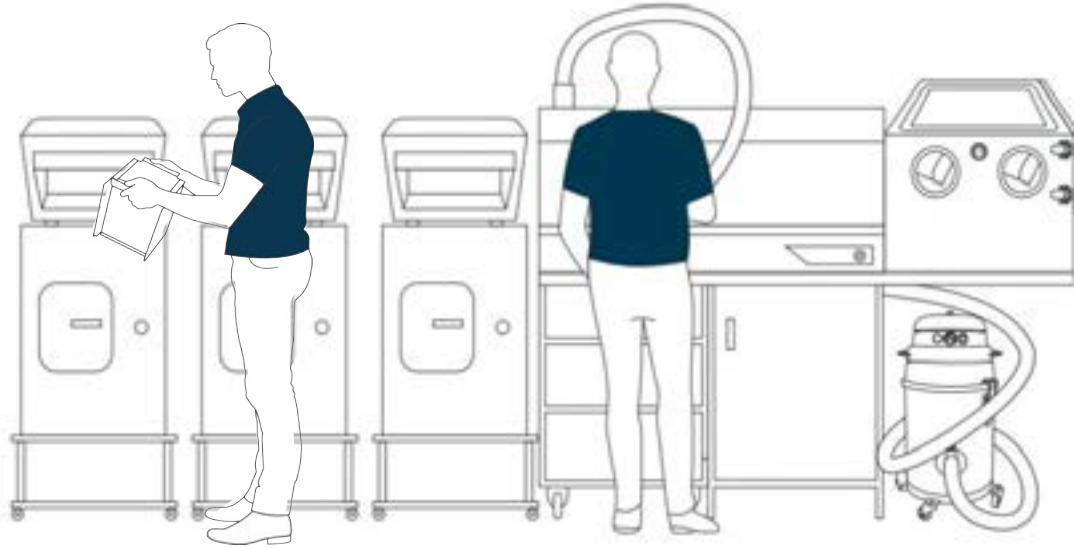





# | PHS in data



## Specification

<b>Dimension</b> [mm / in] :	700 x 1000 x 1580 / 27.6 x 39.4 x 62.2
<b>Weight</b> [kg / lb]:	150 / 331
<b>Space of installation</b> [mm / in] :	1700 x 2200 x 1800 / 66.9 x 86.6 x 70.9
<b>Labor</b> [min] :	~ 25 for whole process
<b>Set contain:</b>	Sieving module
	Built in powder separator
	3 drawers - storage space
	Shelf for sandblaster
	Hoses, connectors & special 3d printed vacuum inlets
	LED lighting
	Metal container
<b>Powder capacity</b> [l / gal]	max 8 / 1.8
<b>Power supply</b> [V]	110/230 [V] AC, 12 VDC 6,67 A, 80W



# Thank You

**Do you have any questions?**

[sales@sinterit.com](mailto:sales@sinterit.com) or your dedicated KAM

+48 570 967 854

[www.sinterit.com](http://www.sinterit.com)



Sinterit sp. z o.o.  
ul. Nad Drwiną 10 bud. B3  
30-741 Krakow  
Poland  
[www.sinterit.com](http://www.sinterit.com)

